

## NATIONAL REGISTER OF HISTORIC PLACES INVENTORY - NOMINATION FORM FOR FEDERAL PROPERTIES

(Type all entries - complete applicable sections)

STATE: <div style="text-align: center;">Arizona</div>
COUNTY: <div style="text-align: center;">Coconino</div>
FOR NPS USE ONLY
ENTRY DATE <div style="text-align: center;">MAR 31 1975</div>

### 1. NAME

COMMON: <div style="text-align: center;">Old Headquarters (B-13)</div>
AND/OR HISTORIC:

### 2. LOCATION

STREET AND NUMBER: <i>2 mi E of Flagstaff in T21N, R0E, G&amp;SR BM</i> Walnut Canyon National Monument, <i>SE 1/4 of NW 1/4, Sec. 26</i>			
CITY OR TOWN: <div style="text-align: center;">Flagstaff <i>vicinity</i></div>		CONGRESSIONAL DISTRICT: <div style="text-align: center;">Third</div>	
STATE: <div style="text-align: center;">Arizona</div>	CODE: <div style="text-align: center;">04</div>	COUNTY: <div style="text-align: center;">Coconino</div>	CODE: <div style="text-align: center;">005</div>

### 3. CLASSIFICATION

CATEGORY <small>(Check One)</small>	OWNERSHIP	STATUS	ACCESSIBLE TO THE PUBLIC
<input type="checkbox"/> District <input checked="" type="checkbox"/> Building <input type="checkbox"/> Site <input type="checkbox"/> Structure <input type="checkbox"/> Object	<input checked="" type="checkbox"/> Public <input type="checkbox"/> Private <input type="checkbox"/> Both	Public Acquisition: <input type="checkbox"/> In Process <input type="checkbox"/> Being Considered	<input type="checkbox"/> Occupied <input checked="" type="checkbox"/> Unoccupied <input type="checkbox"/> Preservation work in progress
PRESENT USE <small>(Check One or More as Appropriate)</small>			
<input type="checkbox"/> Agricultural	<input type="checkbox"/> Government	<input checked="" type="checkbox"/> Park	<input type="checkbox"/> Transportation
<input type="checkbox"/> Commercial	<input type="checkbox"/> Industrial	<input type="checkbox"/> Private Residence	<input type="checkbox"/> Other <small>(Specify)</small>
<input type="checkbox"/> Educational	<input type="checkbox"/> Military	<input type="checkbox"/> Religious	
<input type="checkbox"/> Entertainment	<input type="checkbox"/> Museum	<input type="checkbox"/> Scientific	

### 4. AGENCY

National Park Service			
REGIONAL HEADQUARTERS: <small>(If applicable)</small> Western Regional Office		STREET AND NUMBER: Box 450 Golden Gate Ave., 36063	
CITY OR TOWN: San Francisco		STATE: California	CODE: 06

### 5. LOCATION OF LEGAL DESCRIPTION

COURTHOUSE, REGISTRY OF DEEDS, ETC: Coconino County Courthouse			
STREET AND NUMBER:			
CITY OR TOWN: Flagstaff		STATE: Arizona	CODE: 04

### 6. REPRESENTATION IN EXISTING SURVEYS

TITLE OF SURVEY:			
DATE OF SURVEY: <input type="checkbox"/> Federal <input type="checkbox"/> State <input type="checkbox"/> County <input type="checkbox"/> Local			
DEPOSITORY FOR SURVEY RECORDS:			
STREET AND NUMBER:			
CITY OR TOWN:		STATE:	CODE:

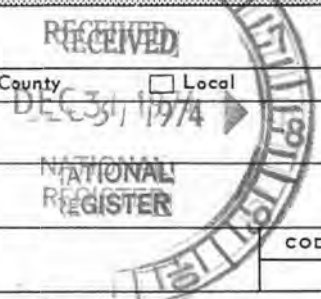

STATE: ARIZONA  
 COUNTY: COCONINO  
 ENTRY NUMBER: MAR 31 1975  
 DATE:

SEE INSTRUCTIONS

FOR NPS USE ONLY

7. DESCRIPTION

(Check One)

CONDITION

Excellent     Good     Fair     Deteriorated     Ruins     Unexposed

(Check One)

Altered     Unaltered

(Check One)

Moved     Original Site

DESCRIBE THE PRESENT AND ORIGINAL (if known) PHYSICAL APPEARANCE

Preservation recommended

This log cabin appears to have initially consisted of the main portion and to have had added a smaller log cabin at the east end.

The overall dimensions of the cabin is 45' x 15', including the addition. It is covered with a shingle roof. An alligator cypress grows beside the east addition and the roof overhang has been built around the tree's trunk.

The logs were apparently chinked with wood and adobe, but in more recent years some of the adobe has been replaced with cement.

The interior of the cabin is divided into four rooms. The interior walls are made of a celotex-type material and painted. The ceiling is headed and painted, and the floor appears to be made of tongue and groove lumber and is oiled. Bracing has been placed on the interior of the cabin to keep it from falling over.

Generally, the cabin is in poor condition; the west end is sinking into the ground.

Outside the cabin is a cistern, and a terraced area contains stone walks, a birdbath and flower beds. A concrete walk runs up to and along the front of the cabin.

Boundary: The historic land embraced in this site is a square formed by using the cabin as a center point and going out 200 feet to the north, 200 feet to the east, 200 feet to the south, and 200 feet to the west.

Class VI land: 3.6 acres

Cost: \$10,000 (estimate)



SEE INSTRUCTIONS

**8. SIGNIFICANCE**

PERIOD (Check One or More as Appropriate)

- |  |                                       |                                       |  |
|--|---------------------------------------|---------------------------------------|--|
| <input type="checkbox"/> Pre-Columbian | <input type="checkbox"/> 16th Century | <input type="checkbox"/> 18th Century | <input checked="" type="checkbox"/> 20th Century |
| <input type="checkbox"/> 15th Century  | <input type="checkbox"/> 17th Century | <input type="checkbox"/> 19th Century |  |

SPECIFIC DATE(S) (If Applicable and Known) 1904

AREAS OF SIGNIFICANCE (Check One or More as Appropriate)

- |  |   |  |  |
|--|---|--|--|
| <input type="checkbox"/> Aboriginal              | <input type="checkbox"/> Education              | <input type="checkbox"/> Political           | <input type="checkbox"/> Urban Planning  |
| <input type="checkbox"/> Prehistoric             | <input type="checkbox"/> Engineering            | <input type="checkbox"/> Religion/Philosophy | <input type="checkbox"/> Other (Specify) |
| <input type="checkbox"/> Historic                | <input type="checkbox"/> Industry               | <input type="checkbox"/> Science             | _____                                    |
| <input type="checkbox"/> Agriculture             | <input type="checkbox"/> Invention              | <input type="checkbox"/> Sculpture           | _____                                    |
| <input type="checkbox"/> Architecture            | <input type="checkbox"/> Landscape Architecture | <input type="checkbox"/> Social/Humanitarian | _____                                    |
| <input type="checkbox"/> Art                     | <input type="checkbox"/> Literature             | <input type="checkbox"/> Theater             | _____                                    |
| <input type="checkbox"/> Commerce                | <input type="checkbox"/> Military               | <input type="checkbox"/> Transportation      | _____                                    |
| <input type="checkbox"/> Communications          | <input type="checkbox"/> Music                  |  | _____                                    |
| <input checked="" type="checkbox"/> Conservation |   |  | _____                                    |

STATEMENT OF SIGNIFICANCE

3rd Order

This log cabin built in 1904, served as the first headquarters and museum for the monument when it was still part of the National Forest. The visitors planning to tour the cliff dwelling ruins began their hike from this point. The cabin also served as living quarters for the custodian.

Today, this cabin is one of the oldest surviving log structures in this vicinity of the State of Arizona. But more important as the first and long-time headquarters and museum for the monument and quarters for the park's protector, it is significant in the administrative history of Walnut Canyon National Monument.



SEE INSTRUCTIONS

9. MAJOR BIBLIOGRAPHICAL REFERENCES

"Log Cabin", and building folder in files of Walnut Canyon National Monument, Arizona Daily Sun, October 31, 1969.

10. GEOGRAPHICAL DATA

LATITUDE AND LONGITUDE COORDINATES DEFINING A RECTANGLE LOCATING THE PROPERTY				O R	LATITUDE AND LONGITUDE COORDINATES DEFINING THE CENTER POINT OF A PROPERTY OF LESS THAN TEN ACRES							
CORNER	LATITUDE				LONGITUDE							
	Degrees	Minutes	Seconds	Degrees	Minutes	Seconds	Degrees	Minutes	Seconds			
NW	°	'	"	°	'	"	35°	10'	30"	111°	31'	02"
NE	°	'	"	°	'	"						
SE	°	'	"	°	'	"						
SW	°	'	"	°	'	"						

NO  
LTM  
CO

APPROXIMATE ACREAGE OF NOMINATED PROPERTY: 3.6 acres

LIST ALL STATES AND COUNTIES FOR PROPERTIES OVERLAPPING STATE OR COUNTY BOUNDARIES

STATE:	CODE	COUNTY:	CODE
Arizona	04	Coconino	005
STATE:	CODE	COUNTY:	CODE
STATE:	CODE	COUNTY:	CODE
STATE:	CODE	COUNTY:	CODE

SEE INSTRUCTIONS

11. FORM PREPARED BY

NAME AND TITLE: F. Ross Holland, Jr., Historian

BUSINESS ADDRESS: Denver Service Center, NPS

STREET AND NUMBER: 7200 W. Alameda

CITY OR TOWN: Denver

STATE: Colorado

DATE: 8 April 1972

PHONE:

NATIONAL REGISTER

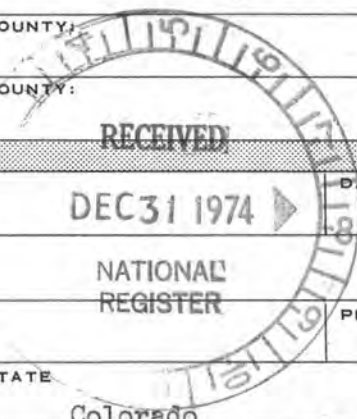

12. CERTIFICATION OF NOMINATION

State Liaison Officer recommendation:

Yes

No

None

*Hennis McCarthy*  
State Liaison Officer Signature

In compliance with Executive Order 11593, I hereby nominate this property to the National Register, certifying that the State Liaison Officer has been allowed 90 days in which to present the nomination to the State Review Board and to evaluate its significance. The recommended level of significance is  National  State

*Walter P. Wheeler* DEC 19 1974  
Federal Representative Signature Date  
Deputy Assistant Secretary  
Title

NATIONAL REGISTER VERIFICATION

I hereby certify that this property is included in the National Register.

*A. R. West*  
Director, Office of Archeology and Historic Preservation

Date: 3/21/75

ATTEST:

*W. J. Smith*  
Keeper of The National Register

Date: 3 28 75





NATIONAL REGISTER OF HISTORIC PLACES  
PROPERTY PHOTOGRAPH FORM

(Type all entries - attach to or enclose with photograph)

STATE	
Arizona	
COUNTY	
Coconino	
FOR NPS USE ONLY	
ENTRY NUMBER	DATE
	MAR 31 1975

SEE INSTRUCTIONS

1. NAME

COMMON: Old Headquarters  
AND/OR HISTORIC:

2. LOCATION

STREET AND NUMBER: Walnut Canyon National Monument

CITY OR TOWN: Flagstaff

STATE: Arizona	CODE 04	COUNTY: Coconino	CODE 005
----------------	------------	------------------	-------------

3. PHOTO REFERENCE

PHOTO CREDIT: F. Ross Holland, Jr., Historian

DATE OF PHOTO: April 1972

NEGATIVE FILED AT: Denver Service Center

4. IDENTIFICATION

DESCRIBE VIEW, DIRECTION, ETC.

#1 of 2

1) Front view of Old Headquarters

PROPERTY OF THE NATIONAL REGISTER

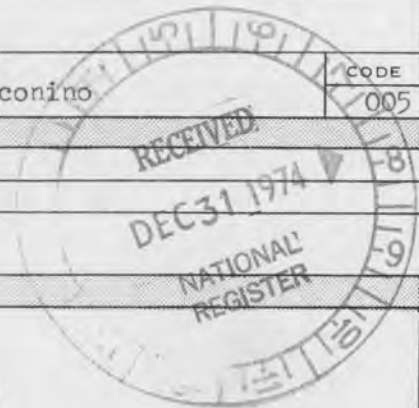



NATIONAL REGISTER OF HISTORIC PLACES  
PROPERTY PHOTOGRAPH FORM

(Type all entries - attach to or enclose with photograph)

STATE	
Arizona	
COUNTY	
Coconino	
FOR NPS USE ONLY	
ENTRY NUMBER	DATE
010	MAR 31 1975

SEE INSTRUCTIONS

1. NAME

COMMON: Old Headquarters  
AND/OR HISTORIC:

2. LOCATION

STREET AND NUMBER:  
Walnut Canyon National Monument

CITY OR TOWN:  
Flagstaff

STATE: Arizona	CODE 04	COUNTY: Coconino	CODE 005
-------------------	------------	---------------------	-------------

3. PHOTO REFERENCE

PHOTO CREDIT: F. Ross Holland, Jr., Historian

DATE OF PHOTO: April 1972

NEGATIVE FILED AT: Denver Service Center

4. IDENTIFICATION

DESCRIBE VIEW, DIRECTION, ETC.

#2 of 2 2) Side and back view of old headquarters

**PROPERTY OF THE NATIONAL REGISTER**

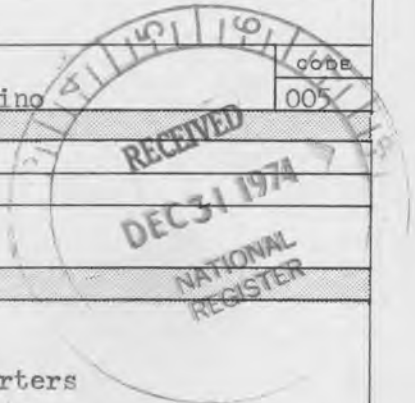





Athens Historic District  
Dr. Parker House  
Fayette County, Kentucky *DE*  
January, 1979  
Gloria Mills

OCT 11 1979

Kentucky Heritage Commission  
Frankfort, Kentucky  
Photo 1410  
Looking north.

JUL 16 1979



Athens Historic District

Dr. Parker House

Fayette County, Kentucky

January 1979

Gloria Mills

*Doc*  
OCT 11 1979  
JUL 16 1979

Kentucky Heritage Commission  
Frankfort, Kentucky Photo 20/10  
Looking north, showing the north-  
west limit of boundary. Athens-  
Booneboro Road in foreground.





Athens Historic District  
Fayette County Kentucky  
January 1979      JUL 16 1979  
Gloria Mills  
Kentucky Heritage Commission

Frankfort, Kentucky      D6C  
Photo 3 <sup>4/10</sup>      OCT 11 1979  
Looking southeast.  
Left to right: Dr. Parker House  
log house, brick rowhouses



Athens Historic District  
Fayette County Kentucky *DOE*  
January 1979 OCT 11 1979  
Gloria Mills  
Kentucky Heritage Commission

Frankfort, Kentucky  
Photo 4410 JUL 16 1979  
Looking northwest.  
Right to left: Brick rowhouses,  
log house, Dr. Parker House.



Athens Historic District  
Fayette County, Kentucky *DOE*  
Gloria Mills *OCT: 11 1979*  
January 1979  
Kentucky Heritage Commission

Frankfort, Kentucky *JUL 16 1979*  
Photo *554/10*  
Looking north, Marshall Tavern on  
the left, Aubrey Tavern on right.





CREEK  
T CHURCH

*Presby*

STOP

STOP

Person walking on sidewalk

Athens Historic District

Fayette County Kentucky *DOE*

January 1979

Gloria Mills

OCT 11 1979

Kentucky Heritage Commission

Frankfort, Kentucky *JUL 16 1979*

Photo *6910*

Looking southeast. Intersection  
of Athens-Boonesboro Rd. and  
Cleveland Rd. in foreground.



Athens Historic District

Fayette County, Kentucky *DOE*

Gloria Mills OCT 11 1979

January 1979

Kentucky Heritage Commission

Frankfort, Kentucky JUL 16 1979

Photo 79/10

Looking south. Flannery's store  
is on right, <sup>se</sup>Ron's store on left.





Athens Historic District  
Fayette County, Kentucky  
Gloria Mills  
January 1979  
Kentucky Heritage Commission

Frankfort, Kentucky JUL 16 1979  
Photo 8910  
Interior, Flannery's store

*doc*  
OCT 11 1979



Athens Historic District  
Fayette County Kentucky  
Gloria Mills  
January 1979  
Kentucky Heritage Commission

Frankfort, Kentucky

Photo 9 of 10

Flannery's store

*Rowe's*

*DOE*  
OCT 11 1979

JUL 16 1979



Athens Historic District  
Fayette County, Kentucky  
January 1979-Gloria Mills  
Kentucky Heritage Commission  
Frankfort, Kentucky

JUL 16 1979

Photo 10 *110*

Looking southeast, showing  
western edge of boundary.

*OCE*  
OCT 11 1979

*B*

**NATIONAL REGISTER OF HISTORIC PLACES  
PROPERTY MAP FORM**

*(Type all entries - attach to or enclose with map)*

STATE Arizona	
COUNTY Coconino	
FOR NPS USE ONLY	
ENTRY NUMBER	DATE
MAP 9 1 1975	

SEE INSTRUCTIONS

<b>1. NAME</b>			
COMMON: Old Headquarters		AND/OR HISTORIC:	
<b>2. LOCATION</b>			
STREET AND NUMBER:			
Walnut Canyon National Monument			
CITY OR TOWN:			
Flagstaff			
STATE:	CODE	COUNTY:	CODE
Arizona	04	Coconino	005
<b>3. MAP REFERENCE</b>			
SOURCE:			
U.S.G.S., Flagstaff East, Arizona			
SCALE: 1:24,000			
DATE: 1962			
<b>4. REQUIREMENTS</b>			
TO BE INCLUDED ON ALL MAPS			
1. Property boundaries where required.			
2. North arrow.			
3. Latitude and longitude reference.			

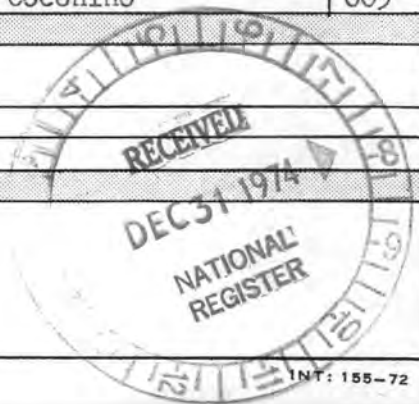



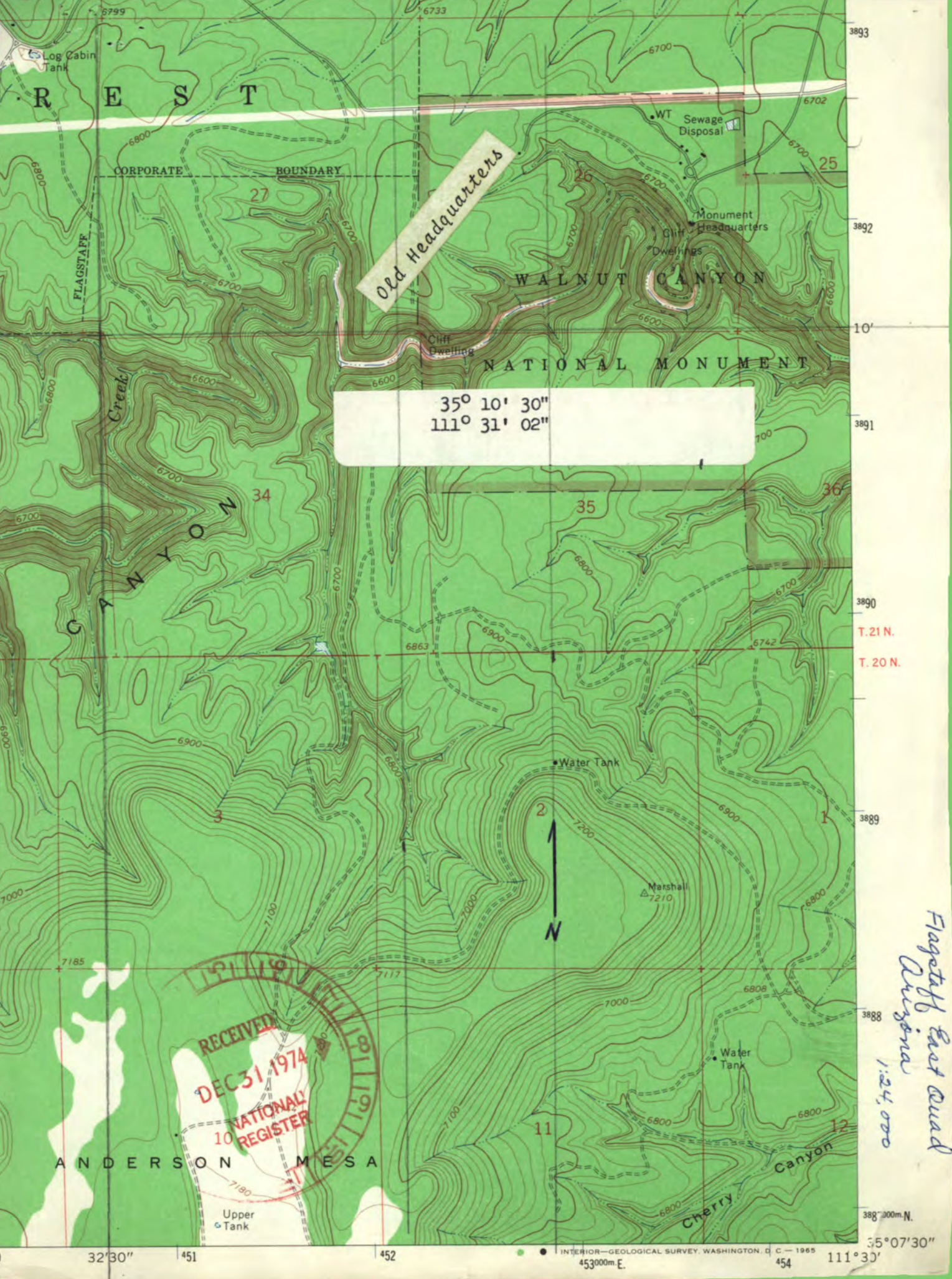

*Old Headquarters*

35° 10' 30"  
111° 31' 02"

RECEIVED  
DEC 31 1974  
10 NATIONAL REGISTER

*Flagstaff East Quad  
Arizona  
1:24,000*

ANDERSON MESA

# National Register of Historic Places

## Note to the record

Additional Documentation: 2019



UNITED STATES DEPARTMENT OF THE INTERIOR  
NATIONAL PARK SERVICE

NATIONAL REGISTER OF HISTORIC PLACES  
EVALUATION/RETURN SHEET

Requested Action:

Property Name:

Multiple Name:

State & County:

Date Received: 7/16/2019      Date of Pending List: 8/9/2019      Date of 16th Day: 8/26/2019      Date of 45th Day: 8/30/2019      Date of Weekly List:

Reference number:

Nominator:

Reason For Review:

Accept       Return       Reject      8/28/2019 Date

Abstract/Summary  
Comments:

Recommendation/  
Criteria

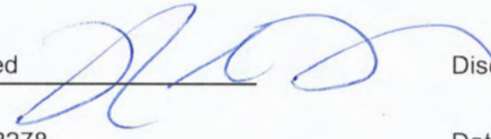
Reviewer Roger Reed  Discipline Historian

Telephone (202)354-2278 Date 8/29/19

DOCUMENTATION:    see attached comments : No    see attached SLR : No

If a nomination is returned to the nomination authority, the nomination is no longer under consideration by the National Park Service.

Additional Documentation is included in file: 100004317 Cliffs Ranger Station

National Register of Historic Places  
Memo to File

# Correspondence

The Correspondence consists of communications from (and possibly to) the nominating authority, notes from the staff of the National Register of Historic Places, and/or other material the National Register of Historic Places received associated with the property.

Correspondence may also include information from other sources, drafts of the nomination, letters of support or objection, memorandums, and ephemera which document the efforts to recognize the property.

1974

ENTRIES IN THE NATIONAL REGISTER

STATE ARIZONA

Date Entered MAR 31 1975

<u>Name</u>	<u>Location</u>
Old Headquarters	Flagstaff vicinity Coconino County
Manning Cabin	Tucson Pima County
Stafford Cabin	Willecox Cochise County

Also Notified

Hon. Paul J. Fannin  
 Hon. Barry M. Goldwater  
 Hon. Sam Steiger  
 Hon. Morris K. Udall  
 Mr. Douglas Wheeler  
 Deputy Assistant Secretary for  
 Fish and Wildlife and Parks  
 Mr. Robert M. Utley, Asst. Director,  
 Park Historic Preservation  
 Regional Director, Western Region

State Historic Preservation Officer  
 Mr. Dennis McCarthy  
 Director  
 State Parks Board  
 1688 West Adams  
 Phoenix, Arizona 85007

The attached National Register Inventory-Nomination form is being returned to your office for clarification of the information indicated below.

- Park* 1. Name. Provide identifying number of structure. B-12
- 2. Location. \_\_\_\_\_
- 3. Classification. \_\_\_\_\_
- 4. Owner of Property. \_\_\_\_\_
- Prop* 5. Location of Legal Description. Fill in.
- 6. Representation in Existing Surveys. \_\_\_\_\_
- Prop* 7. Description. (a) Need recommended level of treatment proposed; and (b) need preliminary cost estimate for carrying out the proposed level of treatment.
- Prop* 8. Statement of Significance. Fill in date blank. Strengthen with details. Also indicate Order of Significance as being either 1st, 2d, or 3d. 3d
- 9. Bibliography. \_\_\_\_\_
- 10. Geographical Data. *Coord on map*
  - a. Longitude and Latitude Coordinates: See sample map in "How To Complete."
  - Prop* b. Acreage. Specify Class VI land acreage. *Same as acreage in Block 10.*
- 11. Form Prepared By. \_\_\_\_\_
- WR* 12. Certification. Not signed.
- Photographic Coverage. Provide black & white photo, not larger than 4 x 5, for LCS use.
- Map Coverage. \_\_\_\_\_
- Other. Use Form 10-306 if retyped.

Clarification or correction of the above items must be made prior to the initiation of our professional review. Correction of these technical errors does not necessarily insure that the nomination will then satisfy National Register criteria in full.

Thank you for your attention to the above items checked.

SIGNED: \_\_\_\_\_

Property

*Old Headquarters*

COLONIAL CO.

State

*Arizona*

Working Number

*12.31.74.2244*

**TECHNICAL**

Photos 2

Maps 1

**CONTROL**

*cm*

*OK*

*1.13.75*

**HISTORIAN**

**ARCHITECTURAL HISTORIAN**

DESCRIPTION IS WRONG.  
CABIN BUILT IN THREE SECTIONS.

ACCEPT  
LEBOVICH  
1-15-75

*As the oldest log structure and first headquarters and museum of Walnut Canyon it is acceptable on a local level of significance. This is better than most cabin nominations.*

**ARCHEOLOGIST**

Accept  
*M. Bames*  
17 Jan 75

**OTHER**

**HAER**

Inventory \_\_\_\_\_

Review \_\_\_\_\_

**REVIEW UNIT CHIEF**

Accept  
*Colk*  
2-11-75

**BRANCH CHIEF**

**KEEPER**

*Wm*  
3 28 75

National Register Write-up \_\_\_\_\_

Send-back \_\_\_\_\_

Entered MAR 31 1975

Federal Register Entry 5-6-75

Re-submit \_\_\_\_\_

INT:2106-74



# NATIONAL REGISTER DATA SHEET

① NAME as it appears on federal register: Old Headquarters  
 ② OTHER NAMES: (B-13) sec.  
 ③ date of entry: 3-31-75  
 ④ county code: 005

⑤ LOCATION street & number: 2 mi. E of Flagstaff in Walnut Canyon National Monument  
 city / town: Flagstaff  
 vicinity of: Flagstaff  
 state: AZ  
 county: Coconino  
 ⑥ NPS REGION: Western

⑦ OWNER:  PRIVATE  STATE  MUNICIPAL  COUNTY  MULTIPLE  FEDERAL (agency name): NPS  
 ⑧ ADMINISTRATOR:

⑨ EXISTING SURVEYS:  HABS  HAER  NHL  
 ⑩ FUNDED?  YES  NO  
 ⑪ CONGRESS. DISTRICT:  
 ⑫ SOURCE of NOMINATION:  STATE  FEDERAL N.P.S.  
 if state who prepared form?

⑬ WITHIN NATIONAL REGISTER HISTORIC DISTRICT?  YES, NAME:  NO  
 ⑭ WITHIN NATIONAL HISTORIC LANDMARK?  YES, NAME:  NO  
 ⑮ ACREAGE: 3.6  
 LOCAL  PRIVATE ORGANIZATION

⑯ CONDITION:  
 excellent  deteriorated  altered  original site  
 good  ruins  unaltered  moved  
 fair  unexposed  reconstructed  unknown  
 unexcavated  excavated  
 ⑰ features:  
 INTERIOR:  SUBSTANTIALLY INTACT-1  SUBSTANTIALLY INTACT-2  SUBSTANTIALLY INTACT-3  
 NOT INTACT-0  NOT INTACT-0  
 UNKNOWN-4  UNKNOWN-5  UNKNOWN-6  
 NOT APPLICABLE-7  NOT APPLICABLE-8  NOT APPLICABLE-9  
 EXTERIOR:  SUBSTANTIALLY INTACT-1  SUBSTANTIALLY INTACT-2  SUBSTANTIALLY INTACT-3  
 NOT INTACT-0  NOT INTACT-0  
 UNKNOWN-4  UNKNOWN-5  UNKNOWN-6  
 NOT APPLICABLE-7  NOT APPLICABLE-8  NOT APPLICABLE-9  
 ENVIRONS:  SUBSTANTIALLY INTACT-1  SUBSTANTIALLY INTACT-2  SUBSTANTIALLY INTACT-3  
 NOT INTACT-0  NOT INTACT-0  
 UNKNOWN-4  UNKNOWN-5  UNKNOWN-6  
 NOT APPLICABLE-7  NOT APPLICABLE-8  NOT APPLICABLE-9

⑱ ACCESS:  YES - Restricted  YES - Unrestricted  No Access  Unknown  
 ⑲ ADAPTIVE USE:  YES  NO  
 ⑳ SAVED?  YES  NO  
 IS PROPERTY A HISTORIC DISTRICT?  YES  NO

㉑ AREAS OF SIGNIFICANCE:  
 ARCHEOLOGY - prehistoric-2  COMMERCE - 6  ENTERTAINMENT - 26  LANDSCAPE ARCH. - 15  POLITICS / GOVT. - 21  RECREATION - 28  
 ARCHEOLOGY - historic-1  COMMUNICATIONS - 7  EXPLORATION - 12  LAW - 16  RELIGION - 22  SETTLEMENT - 29  
 AGRICULTURE - 3  CONSERVATION - 8  HEALTH - 27  LITERATURE - 17  SCIENCE - 23  URBAN PLANNING - 31  
 ARCHITECTURE - 4  ECONOMICS - 9  INDUSTRY - 13  MILITARY - 18  SOCIAL / HUMANITARIAN - 24  OTHER (SPECIFY)  
 ART - 5  EDUCATION - 10  INVENTION - 14  PHILOSOPHY - 20  TRANSPORTATION - 25  
 ㉒ CLAIMS: explain 'first' HEADQUARTERS FOR MONUMENT PARK, 'oldest'   
 'only'

㉓ functions: WHEN HISTORICALLY SIGNIFICANT: park headquarters  
 CURRENTLY:  
 ㉔ dates of initial construction: 1904  
 major alterations:  
 historic events:  
 ㉕ ETHNIC GROUP ASSOCIATION

㉖ architectural style(s):  
 ㉗ architect:  
 ㉘ master builder:  
 ㉙ engineer:

㉚ landscape architect / garden designer:  
 ㉛ interior decorator:  
 ㉜ artist:  
 ㉝ artisan:  
 ㉞ builder / contractor:

㉟ NAMES give role & date  
 PERSONAL:  
 EVENTS:  
 INSTITUTIONAL:

㊱ NATIONAL REGISTER WRITE-UP: LOW CONSTRUCTION, BOARD-AND-BATTEN GABLE END SIDING; 1 STORY, RECTANGULAR, GABLED ROOF, INTERIOR CHIMNEYS, VARIOUS FRONT AND REAR PANELED ENTRANCE DOORS; RECESSED REAR PORCH WITH ALLIGATOR CYPRESS TREE GROWING UP THROUGH HOLE IN ROOF; SIDE ADDITION. PIONEER, 1st HEADQUARTERS AND MUSEUM FOR WALNUT CANYON NATIONAL MONUMENT. Museum.