

PH0087491

NATIONAL REGISTER OF HISTORIC PLACES
INVENTORY - NOMINATION FORM

(Type all entries - complete applicable sections)

STATE: Colorado	
COUNTY: Weld	
FOR NPS USE ONLY	
ENTRY NUMBER 10-205-0006	DATE 2/26/70

1. NAME

COMMON: Meeker Memorial Museum

AND/OR HISTORIC: N. C. Meeker Home

2. LOCATION

STREET AND NUMBER: 1324 Ninth Avenue

CITY OR TOWN: Greeley

STATE: Colorado CODE: 05 COUNTY: Weld CODE: 123

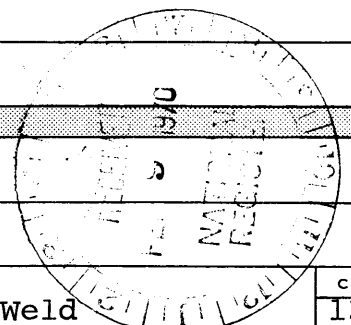

3. CLASSIFICATION

CATEGORY (Check One)	OWNERSHIP	STATUS	ACCESSIBLE TO THE PUBLIC
<input type="checkbox"/> District <input type="checkbox"/> Site <input type="checkbox"/> Object <input checked="" type="checkbox"/> Building <input type="checkbox"/> Structure	<input checked="" type="checkbox"/> Public <input type="checkbox"/> Private <input type="checkbox"/> Both	<input checked="" type="checkbox"/> Occupied <input type="checkbox"/> Unoccupied <input type="checkbox"/> Preservation work in progress	Yes: <input type="checkbox"/> Restricted <input checked="" type="checkbox"/> Unrestricted <input type="checkbox"/> No

PRESENT USE (Check One or More as Appropriate)

<input type="checkbox"/> Agricultural	<input type="checkbox"/> Government	<input type="checkbox"/> Park	<input type="checkbox"/> Transportation	<input checked="" type="checkbox"/> Comments <u>Historic House</u>
<input type="checkbox"/> Commercial	<input type="checkbox"/> Industrial	<input type="checkbox"/> Private Residence	<input type="checkbox"/> Other (Specify)	
<input checked="" type="checkbox"/> Educational	<input type="checkbox"/> Military	<input type="checkbox"/> Religious		
<input type="checkbox"/> Entertainment	<input checked="" type="checkbox"/> Museum	<input type="checkbox"/> Scientific		

4. OWNER OF PROPERTY

OWNER'S NAME: City of Greeley, Colorado

STREET AND NUMBER: Greeley City Hall

CITY OR TOWN: Greeley STATE: Colorado CODE: 05

5. LOCATION OF LEGAL DESCRIPTION

COURTHOUSE, REGISTRY OF DEEDS, ETC.: City of Greeley

STREET AND NUMBER: City Hall

CITY OR TOWN: Greeley STATE: Colorado CODE: 05

6. REPRESENTATION IN EXISTING SURVEYS

TITLE OF SURVEY: None known - see continuation Form 10-300 a

DATE OF SURVEY: Federal State County Local

DEPOSITORY FOR SURVEY RECORDS:

STREET AND NUMBER:

CITY OR TOWN: STATE: CODE:

SEE INSTRUCTIONS

STATE: Colorado

COUNTY: Weld

FOR NPS USE ONLY

ENTRY NUMBER

DATE

7. DESCRIPTION

CONDITION	(Check One)					
	<input type="checkbox"/> Excellent	<input checked="" type="checkbox"/> Good	<input type="checkbox"/> Fair	<input type="checkbox"/> Deteriorated	<input type="checkbox"/> Ruins	<input type="checkbox"/> Unexposed
	(Check One)			(Check One)		
	<input checked="" type="checkbox"/> Altered	<input type="checkbox"/> Unaltered	<input type="checkbox"/> Moved	<input checked="" type="checkbox"/> Original Site		

DESCRIBE THE PRESENT AND ORIGINAL (if known) PHYSICAL APPEARANCE

The original home built by Nathan C. Meeker was a frame shack. This was soon replaced by an adobe structure in 1870. The structure stood two stories high and had six rooms. In 1882, 1890, and 1916, additions and changes were made by the various owners of the property. (Some of these additions are reflected in the 1905 Insurance Map which is enclosed.)

The City of Greeley acquired the house from its founder in 1927. In 1959 restoration of the Meeker property, by the city, was completed and the Meeker House appears much as it did in the 1870's. Today, the City of Greeley utilizes the property as a museum and monument to its founder.

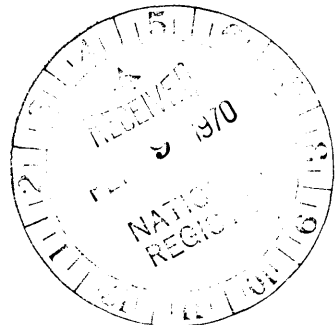

SEE INSTRUCTIONS

4. SIGNIFICANCE

PERIOD (Check One or More as Appropriate)

<input type="checkbox"/> Pre-Columbian	<input type="checkbox"/> 16th Century	<input type="checkbox"/> 18th Century	<input type="checkbox"/> 20th Century
<input type="checkbox"/> 15th Century	<input type="checkbox"/> 17th Century	<input checked="" type="checkbox"/> 19th Century	

SPECIFIC DATE(S) (If Applicable and Known)

AREAS OF SIGNIFICANCE (Check One or More as Appropriate)

<input type="checkbox"/> Aboriginal	<input type="checkbox"/> Education	<input type="checkbox"/> Political	<input type="checkbox"/> Urban Planning
<input type="checkbox"/> Prehistoric	<input type="checkbox"/> Engineering	<input type="checkbox"/> Religion/Philosophy	<input checked="" type="checkbox"/> Other (Specify)
<input type="checkbox"/> Historic	<input type="checkbox"/> Industry	<input type="checkbox"/> Science	<u>Greeley's</u>
<input type="checkbox"/> Agriculture	<input type="checkbox"/> Invention	<input type="checkbox"/> Sculpture	<u>Founder - Gov.</u>
<input type="checkbox"/> Architecture	<input type="checkbox"/> Landscape Architecture	<input type="checkbox"/> Social/Humanitarian	<u>Indian Policy</u>
<input type="checkbox"/> Art	<input type="checkbox"/> Literature	<input type="checkbox"/> Theater	_____
<input type="checkbox"/> Commerce	<input type="checkbox"/> Military	<input type="checkbox"/> Transportation	_____
<input type="checkbox"/> Communications	<input type="checkbox"/> Music		_____
<input type="checkbox"/> Conservation			_____

STATEMENT OF SIGNIFICANCE

Nathan C. Meeker, the house's original owner and builder, founded the settlement of Union Colony; later known as Greeley. Union Colony, in recognition of Meeker's efforts, gave Meeker the land upon which the house stands. The original house was constructed of adobe brick. The home was reputedly one of the finest at the time in the area. Meeker had been the agricultural editor for Horace Greeley's newspaper, the New York Tribune. He, Meeker, was known for his idealistic viewpoints. When he was made an Indian agent for the White River Agency, Meeker left Union Colony with his family to resettle in Ute Indian country. His adamant idealism proved to be his downfall, however, because the Utes, refusing to become full-time agriculturalists, murdered Meeker and the men of the agency in 1879. The resulting outcry of the Meeker Massacre caused the relocation of the Utes into the extreme southwest corner of the state.

The importance of agriculture, which Meeker espoused so strongly and futively to the Utes, is exemplified by the town which he founded.

Today, Greeley is an agricultural center and climaxes in many ways the agrarian developments of the State.

SEE INSTRUCTIONS

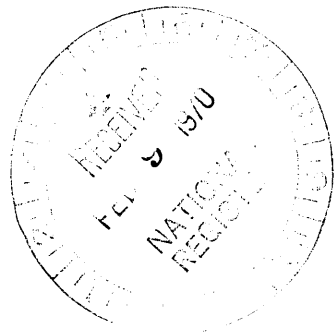

9. MAJOR BIBLIOGRAPHICAL REFERENCES

Colonial Days, by J. Max Clark (1902)

Greeley and the Union Colony of Colorado, by David Boyd, 1890

13/526180/4473910
UNFILED
12-8-76 WML

10. GEOGRAPHICAL DATA

LATITUDE AND LONGITUDE COORDINATES DEFINING A RECTANGLE LOCATING THE PROPERTY			O R	LATITUDE AND LONGITUDE COORDINATES DEFINING THE CENTER POINT OF A PROPERTY OF LESS THAN TEN ACRES		
CORNER	LATITUDE	LONGITUDE		LATITUDE	LONGITUDE	
	Degrees Minutes Seconds	Degrees Minutes Seconds		Degrees Minutes Seconds	Degrees Minutes Seconds	
NW	° ' "	° ' "		40 ° 25 ' 02 "	104 ° 41 ' 30 "	
NE	° ' "	° ' "				
SE	° ' "	° ' "				
SW	° ' "	° ' "				

APPROXIMATE ACREAGE OF NOMINATED PROPERTY: 3/4 (building occupies 800 sq. ft.)

LIST ALL STATES AND COUNTIES FOR PROPERTIES OVERLAPPING STATE OR COUNTY BOUNDARIES

STATE:	CODE	COUNTY	CODE
STATE:	CODE	COUNTY:	CODE
STATE:	CODE	COUNTY:	CODE
STATE:	CODE	COUNTY:	CODE

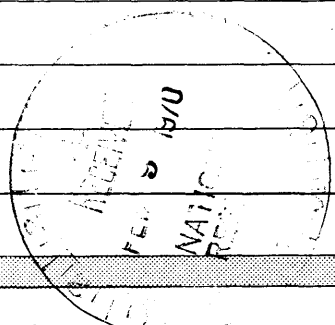

SEE INSTRUCTIONS

11. FORM PREPARED BY

NAME AND TITLE: Robert Fink, Assistant to Director

ORGANIZATION: State Historical Society of Colorado DATE: 1/14/ 70

STREET AND NUMBER: 200 Fourteenth Avenue

CITY OR TOWN: Denver STATE: Colorado CODE: 05

12. STATE LIAISON OFFICER CERTIFICATION

As the designated State Liaison Officer for the National Historic Preservation Act of 1966 (Public Law 89-665), I hereby nominate this property for inclusion in the National Register and certify that it has been evaluated according to the criteria and procedures set forth by the National Park Service. The recommended level of significance of this nomination is:

National State Local

Name: Stephen H. Hart
Stephen H. Hart

Title: State Liaison Officer

Date: _____

NATIONAL REGISTER VERIFICATION

I hereby certify that this property is included in the National Register.

Conant Allen Connolly
Chief, Office of Archeology and Historic Preservation

FEB 26 1970

Date: _____

ATTEST: William J. Soutage
Keeper of The National Register

FEB 17 1970

Date: _____

**NATIONAL REGISTER OF HISTORIC PLACES
INVENTORY - NOMINATION FORM**

(Continuation Sheet)

STATE Colorado	
COUNTY Weld	
FOR NPS USE ONLY	
ENTRY NUMBER 70-205- 878 0001	DATE 2/26/70

(Number all entries)

The City of Greeley was unable to provide a recent survey of the Meeker House and property. However, the Meeker House occupies Lot 3, Block 104 of Greeley. Approximate acreage of the property is three-fourths (3/4) acre.

Reference: Sanborn Insurance Map of Greeley, Colorado
Sanborn Map Company, Sheet 20, 1927
(corrected to circa 1940)

Note: City of Greeley acquired property in 1927.

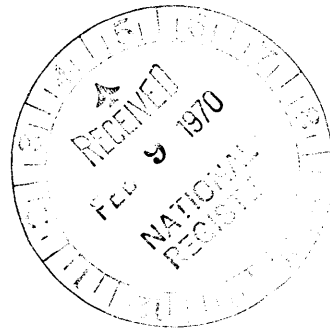

Meeker House Memorial Museum
Greeley, Colorado
Insurance Map of Greeley by
Sanborn/Perris Map Co. (1929)
scale: 1" = 50'

8th Avenue

(13th Street)

(alley)

14th Street

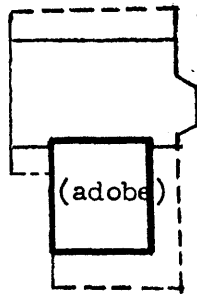

Meeker House Memorial Museum

(now restored to the original adobe structure)

9th Avenue

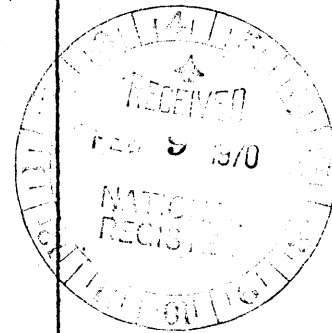

NORTH



Scale: 1"=50'

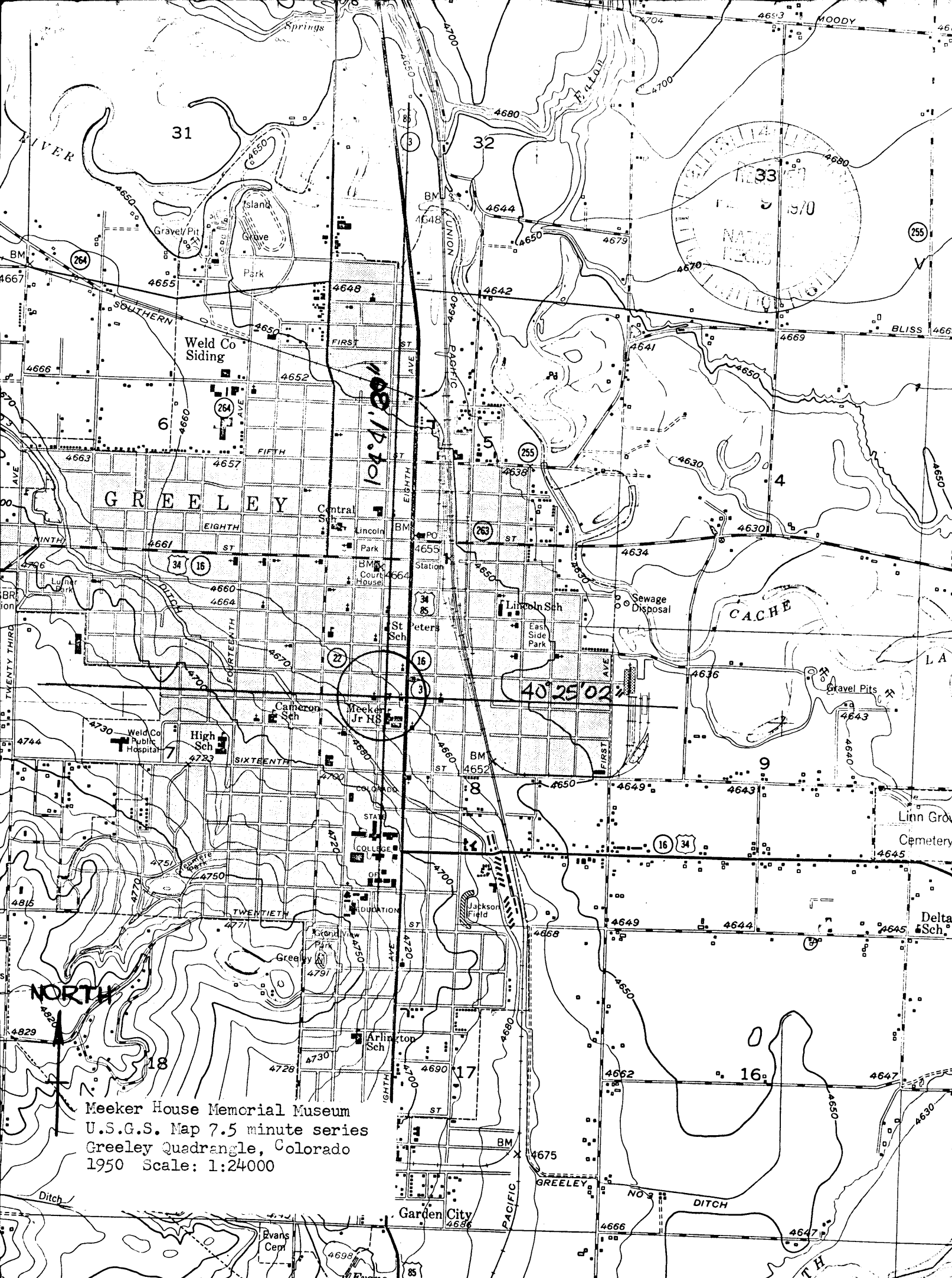

Meeker House Memorial Museum
U.S.G.S. Map 7.5 minute series
Greeley Quadrangle, Colorado
1950 Scale: 1:24000