

KENTUCKY HISTORIC RESOURCES INVENTORY

Bn-G-11

Site No. _____

1. Historic Name(s) Third National Bank		22. ADD/County BRADD/Barren			
Original Owner _____		23. U.S.G.S. Quadrant (15'/75') Glasgow South			
2. Present Name Kiddie Town		24. UTM Reference Zone _____ Easting _____ Northing _____			
3. Location Corner North Green and Main Street		25. Coordinate Accuracy _____			
4. Owner's Name James E Gillenwater		26. Prehistoric Site _____ Object _____ Historic Site _____ Structure _____ Building _____ Other _____			
5. Owner's Address 103 East Main St.		27. National Register District Name: _____			
6. Open to Public Yes <input checked="" type="checkbox"/> No _____	7. Visible from road Yes <input checked="" type="checkbox"/> No _____	8. Ownership Private _____ <input checked="" type="checkbox"/> Local _____ State _____ Federal _____			
9. Local Contact/Organization _____		28. Significance Evaluation National Register			
10. Site Plan with North Arrow		11. Architect _____			
		12. Builder _____			
		13. Date 3rd quarter of the 19th century A. <input type="checkbox"/> B. <input type="checkbox"/>			
		14. Style A. vernacular <input type="checkbox"/> B. <input type="checkbox"/>			
		15. Original Use Commercial <input type="checkbox"/>			
		16. Present use same			
		17. Condition excellent <input type="checkbox"/>			
		18. Description The building has stone lintels and sills with corbel tables above window openings. The metal cornice has abstracted brackets and a tower with pressed tin covering resembling stone, is located above corner entrance			
		19. History		29. Status _____ Date _____ National Landmark _____ National Register _____ Landmark Certificate _____ Kentucky Survey _____ Local Landmark _____ HABS/HAER _____	
		(Continue on Back)		30. Historic Theme Primary _____ Secondary _____ Other _____	
20. Significance The Third National Bank building is one few architecturally significant nineteenth century commercial structures in Glasgow		31. Endangered Yes _____ No _____			
21. Source of Information		32. Preservation Project Status _____ Actual Cost in \$1,000s _____			
Page 250 - The Barren County Heritage		33. ATTACH PHOTO 41 Roll No. _____ Picture No. photo 3 Direction _____			
		34. Prepared by: Jayne C. Henderson			
		35. Organization SCKHS			
		36. Date Fall, 1981			
		37. Revision Dates _____ 38. Staff Review _____			

KENTUCKY HISTORIC RESOURCE INVENTORY SUPPLEMENT
BOUNDARY AND LOCATION INFORMATION

Historic Property Name Third National Bank Site # BW-G-11

Multiple Resource/Thematic Nomination Title Barren County Multiple Resource

U.T.M. Coordinates - List multiple UTM's if property is ten or more acres.

A. 16 596 860 4094 780 D. _____

B. _____ E. _____

C. _____ F. _____

Verbal Boundary Description

Acreage less than one acre

See Map 2 - block 29 - lot 12 - See USGS map 4

The nominated boundary is the foundation of the building which measures 125 feet deep and 25 feet wide. Nominated area in red.

Sketch of Site Plan (Showing outbuildings, structures, landscape features and the site boundary as described above.)

Site location map only - Not to scale

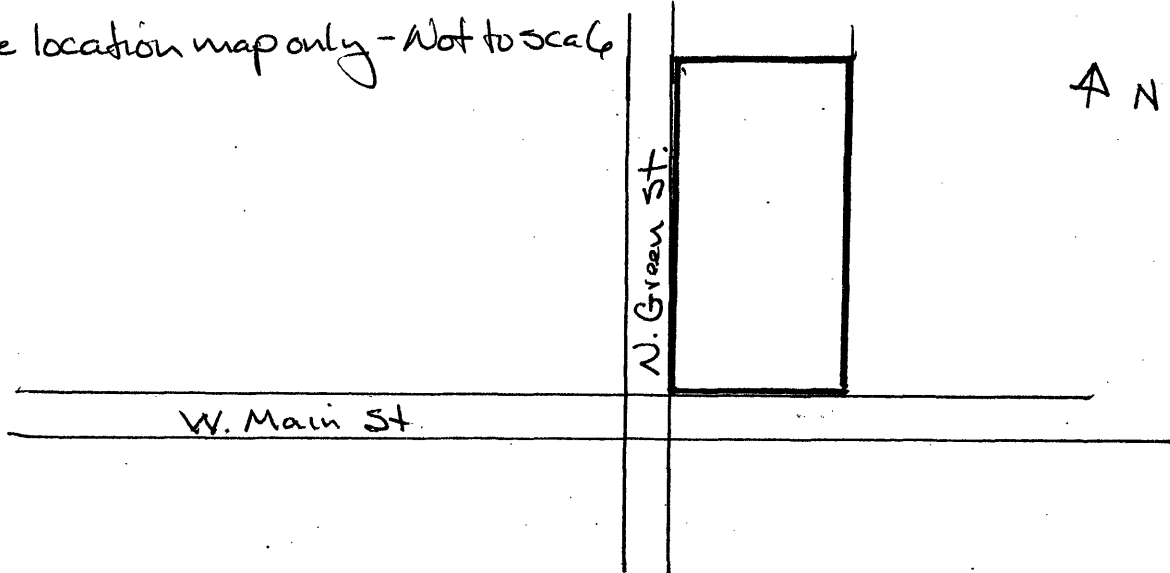

Official Courthouse Property Reference:

KENTUCKY HISTORIC RESOURCES INVENTORY

Bn-G-11

Site No. _____

1. Historic Name(s) Third National Bank			22. ADD/County BRADD/Barren		
Original Owner _____			23. U.S.G.S. Quadrant (15'/75') Glasgow South		
2. Present Name Kiddie Town			24. UTM Reference Zone _____ Easting _____ Northing _____		
3. Location Corner North Green and Main Street			25. Coordinate Accuracy _____		
4. Owner's Name James E Gillenwater			26. Prehistoric Site _____ Object _____ Historic Site _____ Structure _____ Building _____ Other _____		
5. Owner's Address 103 East Main St.			27. National Register District Name: _____		
6. Open to Public Yes <input checked="" type="checkbox"/> No _____	7. Visible from road Yes <input checked="" type="checkbox"/> No _____	8. Ownership Private _____ Local _____ State _____ Federal _____	28. Significance Evaluation National Register		
9. Local Contact/Organization _____			29. Status _____ Date _____ National Landmark _____ National Register _____ Landmark Certificate _____ Kentucky Survey _____ Local Landmark _____ HABS/HAER _____		
10. Site Plan with North Arrow _____			30. Historic Theme Primary _____ Secondary _____ Other _____		
11. Architect _____			31. Endangered Yes _____ No _____		
12. Builder _____			32. Preservation Project Status _____		
13. Date 3rd quarter of the 19th century A. <input type="checkbox"/> B. <input type="checkbox"/>			Actual Cost in \$1,000s _____		
14. Style A. vernacular <input type="checkbox"/> B. <input type="checkbox"/>			33. ATTACH PHOTO 41		
15. Original Use Commercial <input type="checkbox"/>			Roll No. _____ Picture No. photo 3 Direction _____		
16. Present use same			34. Prepared by: Jayne C. Henderson		
17. Condition excellent <input type="checkbox"/>			35. Organization SCKHS		
18. Description The building has stone lintels and sills with corbel tables above window openings. The metal cornice has abstracted brackets and a tower with pressed tin covering resembling stone, is located above corner entrance			36. Date Fall, 1981		
No. Stories two <input type="checkbox"/>			37. Revision Dates _____ 38. Staff Review _____		
Single Pile _____ NA _____					
Double Pile _____					
Floor Plan _____					
Structural Fabric brick A. <input type="checkbox"/> B. <input type="checkbox"/>					
Decorative Fabric A. <input type="checkbox"/> B. <input type="checkbox"/>					
Roof Form flat					
19. History <p style="text-align: center;">(Continue on Back)</p>					
20. Significance The Third National Bank building is one few architecturally significant nineteenth century commercial structures in Glasgow					
21. Source of Information _____					

KENTUCKY HISTORIC RESOURCE INVENTORY SUPPLEMENT
BOUNDARY AND LOCATION INFORMATION

Historic Property Name Third National Bank Site # BW-G-11

Multiple Resource/Thematic Nomination Title Barren County Multiple Resource

U.T.M. Coordinates - List multiple UTM's if property is ten or more acres.

A. 16 596 860 4094 780 D. _____

B. _____ E. _____

C. _____ F. _____

Verbal Boundary Description

Acreage less than one acre

See Map 2 - block 29 - lot 12 - See USGS map 4

The nominated boundary is the foundation of the building which measures 125 feet deep and 25 feet wide. Nominated area in red.

Sketch of Site Plan (Showing outbuildings, structures, landscape features and the site boundary as described above.)

Site location map only - Not to scale

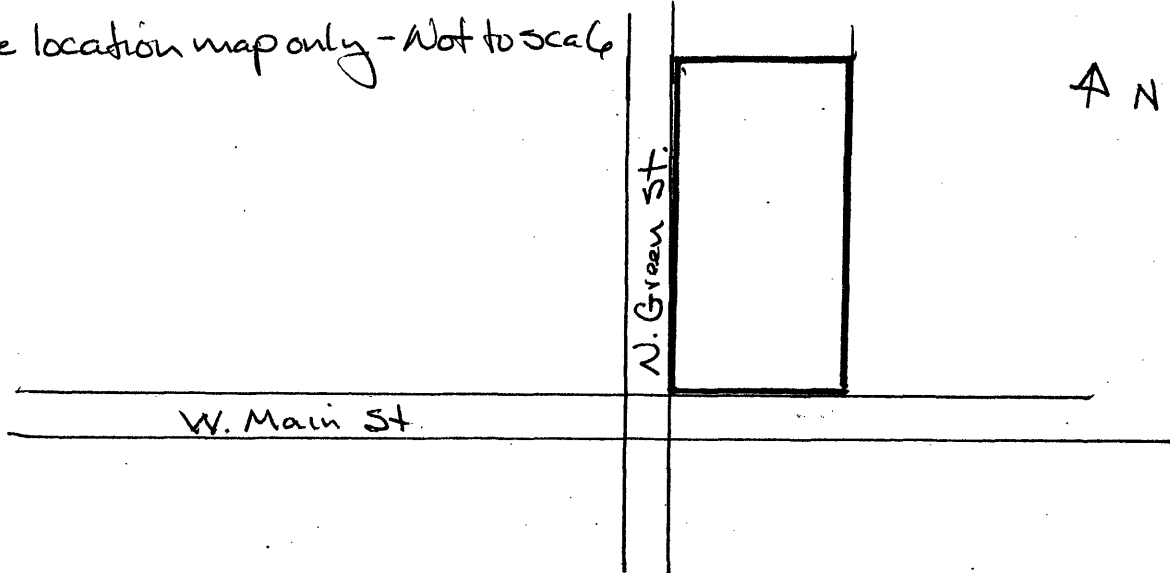

Official Courthouse Property Reference: