

11/24/83

KENTUCKY HISTORIC RESOURCES  
Individual Inventory Form

Resource # L0-24  
LOGAN County

1. Name of Resource:  
David Sawyer House

2. Original Owner:  
David Sawyer

3. Other Names:

4. Prehistoric Site  Building  Object   
Historic Site Structure Other

5. Location: 4/10 miles east of Kentucky 103,  
1 1/10 miles southeast of Kentucky 79,  
near Chandler's Chapel

6. Owner's Name:  
Irene and Ross Chaney [ P ]

7. Owner's Address:  
Route # 2  
Auburn, Kentucky 42206

8. Evaluation: [ G ]

9. Recognition & Date:  
Nat.Landmark  Local Landmark   
Nat.Register  HABS/HAER   
Highway Marker  KY Inventory   
KY Landmark Certificate

10. N.R.Status & Date:

11. N.R.Group:  
District Name: [ ]  
Mult.Resource Area: [ ]  
Thematic Name: Early Stone Buildings [ ]

12. Historical Theme:  
Primary: Architecture [ 030 ]  
Secondary: [ ]  
Other: [ ]

13. Statement of Significance:  
Very well-built and carefully detailed early stone house; unaltered. One of very few stone houses remaining in western Kentucky; the best one in condition and authenticity.  
[ ]

14. History:

Built by David D. Sawyer in 1814; owned by Chaney family for 80 years.

15. Source of historical information and/or contact person:  
Irene Chaney, Owner

16. Date:  
Original Building 1814 [ 8 ]  
Addition [ ]

17. Style:  
Federal [ 21 ]  
[ ]

18. Architect/Builder:  
Unknown

19. No. of Stories: 1 1/2 plus cellar [ 1.5 ]

20. Original Floor Plan:  
Three Rooms [ 3R ]

21. Single Pile -1/2 Double Pile -1/2 N.A.

22. Roof Form & Material: Original   
Gable Not Original

23. Structural Material:  
Stone [ S ]

24. Exterior Material:  
Stone [ S ]

25. Foundation Material:  
Stone [ S ]

26. Major Alterations:  
Moved/Rebuilt None   
Other   
Additions Wing

27. Special Features:  
Lantern Shelf  
Scored Lintels

28. Outbuildings:  
Barn [ 1 ]

29. Original Function:  
Residence [ 01A ]

30. Present Use:  
Residence [ 01A ]

31. Condition:  
Good [ G ]

32. Endangered:  
Yes   
No

33. Attach Photos:  
Roll: 5 Photo Nos: 2A-20 No. of Slides: X

34. Prepared by: Carolyn Murray-Wooley

35. Organization: Kentucky Heritage Council

36. Date: December 1983

37. New Survey  Resurvey  XX

KENTUCKY HISTORIC RESOURCES  
 Individual Inventory Form

Resource # L0-24

<b>38. UTM Point of Primary Building:</b>	<b>Zone</b>	<b>Easting</b>	<b>Northing</b>	<b>39. G.I.S. Mod.</b>	<b>[ ]</b>
<b>Quadrant:</b> <u>Homer</u>	<u>16</u>	<u>519480</u>	<u>4088060</u>	<b>40. Coordi.Accuracy</b>	<b>[ ]</b>

**41. UTM Points of Boundary (for N. R. eligible sites only):**

<b>A.</b>	<u>16</u>	<u>519540</u>	<u>4087700</u>		<b>D.</b>	<u>16</u>	<u>519140</u>	<u>4088725</u>
<b>B.</b>	<u>16</u>	<u>519310</u>	<u>4099020</u>		<b>E.</b>	---	-----	-----
<b>C.</b>	<u>16</u>	<u>519510</u>	<u>4088300</u>		<b>F.</b>	---	-----	-----

**42. Total Acreage in Present Property:**                      **43. Acreage included in proposed N.R. boundary:** 21.8 acres

**44. Site Plan (and boundary description and justification for N.R. sites):**

See Attached Site Plan

**45. Description and House Plan:**

One and one-half story, three-bay, three-room plan, dry-stone house on high basement. Masonry tooled, rough coursed, quoined at corners; interior chimneys each gable end. "D.C.S. 1814" carved on stone cornice return. While very similar in plan and appearance to other early Kentucky stone houses, details of the workmanship are unlike the others: (1) All sills are stone with chamfered edges, (2) Cornice returns at the corners of the eaves are stone into which the cornice abutts, (3) Lintels are solid stones, scored to look like voussoirs with keystones, as at LO-97, N.R., the McGready House, (4) Attic windows also have scored lintels, (5) The cellar entrance is protected by a pent roof with pointed solid stone lintel, (6) Cellar windows are barred by turned banisters (poles) set vertically into the wooden header behind the stone lintel and directly into the stone sill, (7) A stone shelf, beside the front door, rests on stone brackets which project into the walls, as at MM-44, N.R., and (8) The window frames are beaded but not pegged.

The house is ca. 27 x 36 feet, the door slightly off-center to accommodate the three-room plan; cooking fireplace in cellar; original mortar is lightly pointed. House retains nearly all its original woodwork and hardware: exterior beaded-panelled doors, interior batten doors, beaded-board partition walls, chair rail, built-in presses, shelf with frame mantels, breakfront mantel with center block in hall, wrought-iron interior HL hinges and exterior strap hinges.

Changes include: A stone wing with central chimney on the north end of the house was demolished and replaced by owner's father with the present frame wing on the stone foundation. Interior walls were sheathed with sheet panelling to avoid replastering. Frame garage was added on south end.

An old road ran up the creek valley to side of house. The spring forms the headwaters of Rock House Creek which empties into Gasper River.

KENTUCKY HISTORIC RESOURCE INVENTORY SUPPLEMENT  
BOUNDARY AND LOCATION INFORMATION

Historic Property Name Alvira Sawyer house Site # Lo-24  
Multiple Resource/Thematic Nomination Title \_\_\_\_\_

U.T.M. Coordinates - List multiple UTMs if property is ten or more acres.

A. 16 519 540 4087700 D. 16 519 140 4088725  
B. 16 519 310 4088020 E. \_\_\_\_\_  
C. 16 519 510 4088300 F. \_\_\_\_\_

Verbal Boundary Description Acreage 21.8 acres

Beginning at a point  $S 15^{\circ} E$  of the S corner of the house, thence  $N 52^{\circ} W$  950 ft to B, thence at right angle, northeastward 1000 ft to C, thence parallel to A-B 950 ft southeastward to D, thence parallel to B-C, 1000 ft southwestward to the beginning, containing the stone house and spring. The barn is non-contributing.  
1 contributing building

Sketch of Site Plan (Showing outbuildings, structures, landscape features and the site boundary as described above.)

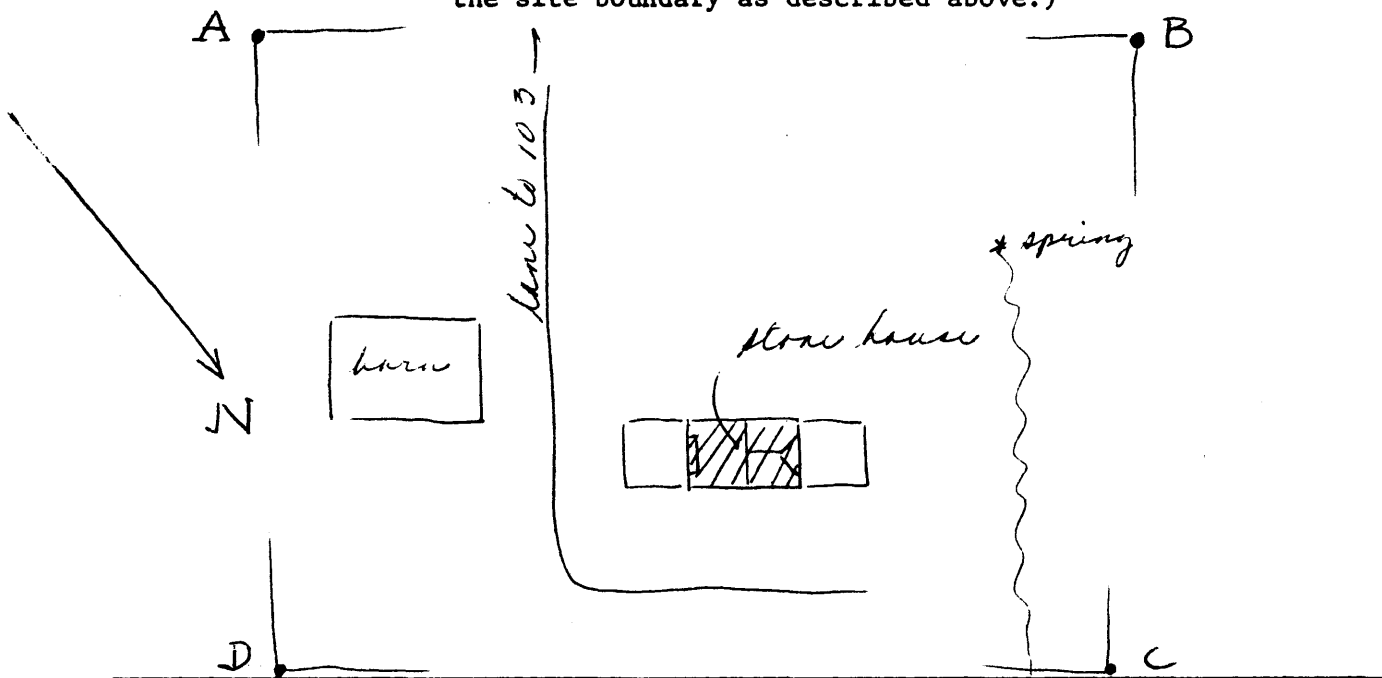

Official Courthouse Property Reference:

Logan County Courthouse