

DEC 12 1980

3170

KENTUCKY HISTORIC RESOURCES INVENTORY

Site No. Jo-32

1. Historic Name(s) Meade Memorial Gymnasium		22. ADD/County BIG SANDY / JOHNSON <input type="text" value="058"/>			
Original Owner		23. U.S.G.S. Quadrant (15'/75') Offutt <input type="text" value=""/>			
2. Present Name		24. UTM Reference 17 348460 4188840			
3. Location Williamsport/ Mouth of Two Mile Creek		Zone Easting Northing			
4. Owner's Name Johnson County School Board		25. Coordinate Accuracy <input type="checkbox"/>			
5. Owner's Address Paintsville, Ky.		26. Prehistoric Site Object Historic Site Structure <input checked="" type="checkbox"/> Building Other			
6. Open to Public Yes <input checked="" type="checkbox"/> No <input type="checkbox"/>	7. Visible from road Yes <input checked="" type="checkbox"/> No <input type="checkbox"/>	8. Ownership <input checked="" type="checkbox"/> Private Local <input type="checkbox"/> State <input type="checkbox"/> Federal <input type="checkbox"/>			
9. Local Contact/Organization JOHNSON COUNTY HISTORIC SITES SURVEY COMMITTEE		27. National Register District Name: <input type="text" value=""/>			
10. Site Plan with North Arrow		28. Significance Evaluation National Register Criteria <input checked="" type="checkbox"/> D			
		11. Architect Unknown			
		12. Builder WPA			
		13. Date 1938 A. <input checked="" type="checkbox"/> B. <input type="checkbox"/>			
		14. Style A. Class. Revival <input checked="" type="checkbox"/> M B. <input type="checkbox"/>			
		15. Original Use Gymnasium <input checked="" type="checkbox"/> I			
		16. Present use Same			
		17. Condition Good <input checked="" type="checkbox"/> B			
		18. Description		29. Status <input type="checkbox"/> Date	
		<p>One story ashlar stone building; five bays on long side of rectangle; three bays on the short; gable roof; round arched openings on short side</p> <p>To the west, a non-contributing, concrete block school building has been added.</p> <p>(Continue on Back)</p>		<p>National Landmark <input type="checkbox"/></p> <p>National Register <input type="checkbox"/></p> <p>Landmark Certificate <input type="checkbox"/></p> <p>Kentucky Survey <input type="checkbox"/></p> <p>Local Landmark <input type="checkbox"/></p> <p>HABS/HAER <input type="checkbox"/></p>	
		19. History		30. Historic Theme <input type="checkbox"/>	
<p>Stone was quarried at location on main Two Mile Creek. Work was done over a period of three years.</p>		31. Endangered Yes <input type="checkbox"/> No <input type="checkbox"/>			
20. Significance One of two examples of WPA craftsmanship in school building during period between depression and World War II. Thus it is significant under Criterion C.		32. Preservation Project Status <input type="checkbox"/>			
21. Source of Information John Wells		Actual Cost in \$1,000s <input type="text" value=""/>			
		33. ATTACH PHOTO			
		Roll No. <u>34</u>			
		Picture No. <u>22, 23</u>			
		Direction <u>13: 25, 26</u>			
		34. Prepared by: HELEN POWELL			
		35. Organization CARMAN AND POWELL, INC.			
		36. Date 1983			
		37. Revision Dates 38. Staff Review			

**KENTUCKY HISTORIC RESOURCE INVENTORY SUPPLEMENT
BOUNDARY AND LOCATION INFORMATION**

Historic Property Name Mead Memorial Gymnasium Site # Jo-32

Multiple Resource/Thematic Nomination Title MULTIPLE RESOURCES OF JOHNSON COUNTY

U.T.M. Coordinates - List multiple UTMs if property is ten or more acres.

A. _____ D. _____
 B. _____ E. _____
 C. _____ F. _____

Verbal Boundary Description Acreage 1.86

From a point 300 feet west of the intersection of KY 40 and KY 2040; then south 222 feet to a point; then west 365 feet to a point; then north 222 feet to a point; then east 365 feet to the point of beginning.

Sketch of Site Plan (Showing outbuildings, structures, landscape features and the site boundary as described above.)

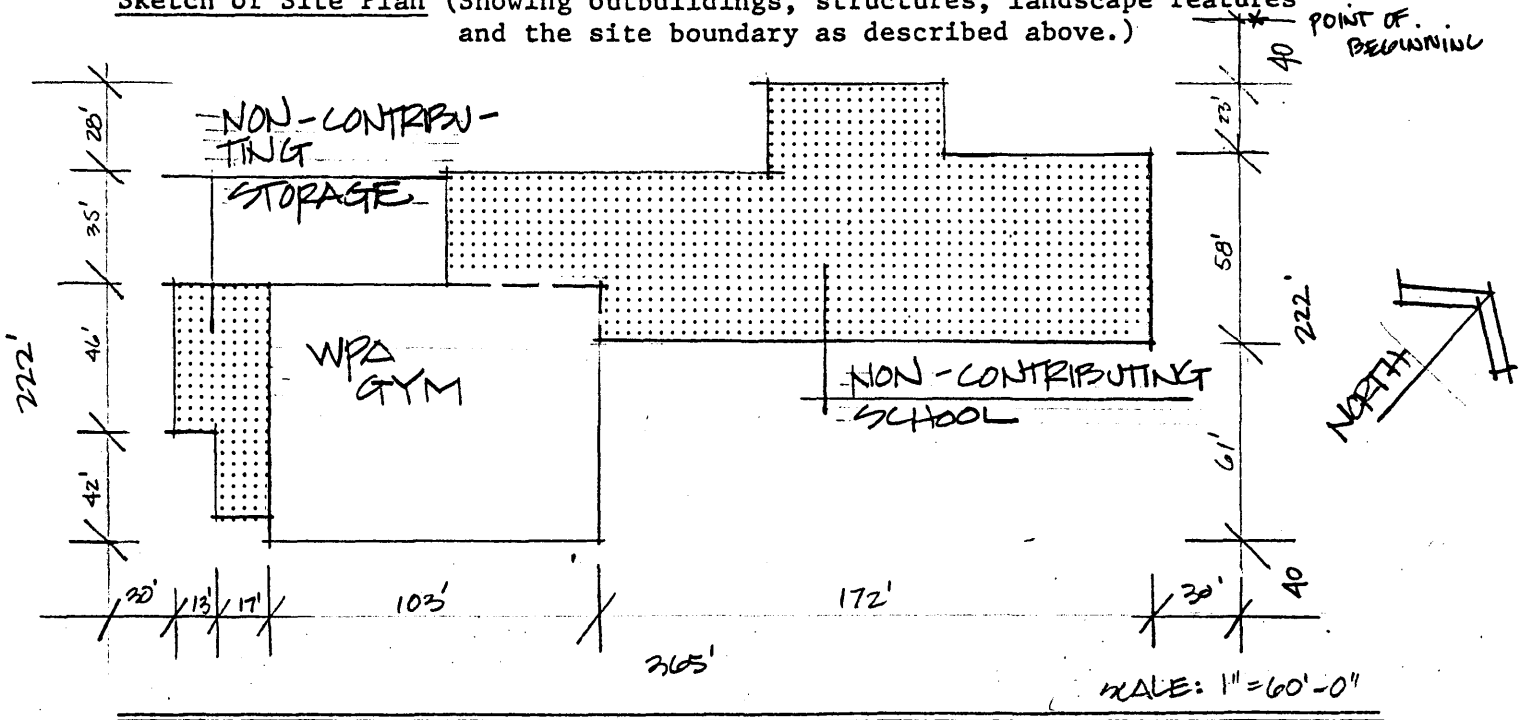

Official Courthouse Property Reference: