

United States Department of the Interior
National Park Service

1460

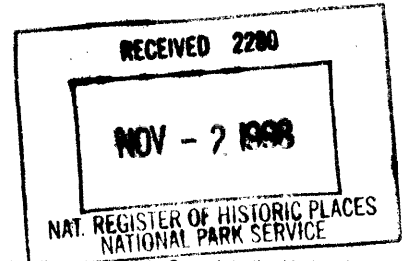

National Register of Historic Places Registration Form

This form is for use in nominating or requesting determinations of eligibility for individual properties or districts. See instructions in *How to Complete the National Register of Historic Places Form* (National Register Bulletin 16A). Complete each item by marking "x" in the appropriate box or by entering the information requested. If an item does not apply to the property being documented, enter "N/A" for "not applicable." For functions, architectural classification, materials, and areas of significance, enter only categories and subcategories from the instructions. Place additional entries and narrative items on continuation sheets (NPS Form 10-900a). Use a typewriter, word processor, or computer to complete all items.

1. Name of Property

historic name Santa Clara Tithing Granary

other names/site number _____

2. Location

street & number 3105 Santa Clara Drive N/A not for publication

city or town Santa Clara N/A vicinity

state Utah code UT county Washington code 053 zip code 84765

3. State/Federal Agency Certification

As the designated authority under the National Historic Preservation Act, as amended, I hereby certify that this nomination request for determination of eligibility meets the documentation standards for registering properties in the National Register of Historic Places and meets the procedural and professional requirements set forth in 36 CFR Part 60. In my opinion, the property meets does not meet the National Register criteria. I recommend that this property be considered significant nationally statewide locally. (See continuation sheet for additional comments.)

Wils M.H.T. 10/23/98
Signature of certifying official/Title Date

Utah Division of State History, Office of Historic Preservation
State or Federal agency and bureau

In my opinion, the property meets does not meet the National Register criteria. (See continuation sheet for additional comments.)

Signature of certifying official/Title Date

State or Federal agency and bureau

4. National Park Service Certification

I hereby certify that this property is:

- entered in the National Register.
 See continuation sheet.
- determined eligible for the National Register.
 See continuation sheet.
- determined not eligible for the National Register.
- removed from the National Register.
- other, (explain:)

Edson A. Beall 12-4-98
Signature of the Keeper Date of Action

Santa Clara Tithing Granary
Name of Property

Santa Clara, Washington County, Utah
City, County, and State

5. Classification

Ownership of Property
(Check as many boxes as apply)

- private
- public-local
- public-State
- public-Federal

Category of Property
(Check only one box)

- building(s)
- district
- site
- structure
- object

Number of Resources within Property
(Do not include previously listed resources in the count.)

Contributing	Non-contributing	
<u>1</u>	<u>1</u>	buildings
_____	_____	sites
_____	_____	structures
_____	_____	objects
<u>1</u>	<u>1</u>	Total

Name of related multiple property listing
(Enter "N/A" if property is not part of a multiple property listing.)

Historic and Architectural Resources of Santa Clara, Utah
Tithing Offices and Granaries of the Mormon Church (Thematic)

Number of contributing resources previously listed in the National Register

N/A

6. Function or Use

Historic Functions
(Enter categories from instructions)
AGRICULTURE/SUBSISTENCE: storage

Current Functions
(Enter categories from instructions)
AGRICULTURE/SUBSISTENCE: storage

7. Description

Architectural Classification
(Enter categories from instructions)
OTHER: Vernacular

Materials
(Enter categories from instructions)
foundation STONE: Limestone
walls STONE: Limestone
roof METAL: steel
other

Narrative Description

(Describe the historic and current condition of the property on one or more continuation sheets.)

United States Department of the Interior
National Park Service

National Register of Historic Places Continuation Sheet

Section No. 7 Page 1

Santa Clara Tithing Granary, Santa Clara, Washington County, UT

Narrative Description

The Santa Clara Mormon Tithing Granary, built c.1902, is a one-story sandstone building on a raised sandstone foundation with a corrugated metal-covered gable roof. The building is a vernacular design belonging to no particular style or type, that was used for similar outbuildings, mainly in the southern half of the state, during the settlement period. Although the building remains basically unchanged from its original appearance, the setting has changed slightly with the addition of a later store and residence and the removal of the original tithing barn.

The granary is not large, measuring 18'x 20', but contains two levels with 1½ foot-thick limestone walls laid in a random ashlar pattern. The lower level is below grade approximately five feet and is accessed by a limestone-slab stairwell on the south facade lined with local basalt rock laid in a rubble fashion. Originally the stairwell had a wood frame cover over it which became dilapidated and has recently been removed. There is a single window at the upper level on the south facade (approx. 2'x 3') and two ground-level windows (approx. 1'x 3') for the basement, one each on the east and west facades. These have 2" wood lintels, casings, and sills. The upper door has a 2" wood lintel and concrete threshold, and the lower level doorway has a 10" thick sandstone lintel. Corrugated metal now covers the gable roof and the original wood shingles.

The lower interior has a dirt floor and is open with square posts supporting the upper floor joists. Some of the bins which were used for storing potatoes and fruit are also intact. The upper level is open, similar to the lower, and at one time contained bins and compartments for organization and storing of supplies, but these have since been removed. Access to this level is through a single doorway on the east facade approximately two feet above grade, which at one time probably had a stairway constructed of lumber.

The site has changed somewhat since the building was first constructed and used. Approximately twenty feet to the west of the granary is now a house, built in the c.1960s. The granary is part of the same property as the house. Behind the house and granary remains a large field used for planting, which probably appears much as it did when the granary was first built. To the east of the granary is a small lane for access to the fields behind. On the other side of the lane is a small grocery store built c.1930.

The granary is in good condition and, except for the removal of some of the interior bins and the basement stairwell covering, has been little altered. It is now used for storage.

Santa Clara Tithing Granary
Name of Property

Santa Clara, Washington County, Utah
City, County, and State

8. Statement of Significance

Applicable National Register Criteria

(Mark "x" on one or more lines for the criteria qualifying the property for National Register listing.)

- A** Property is associated with events that have made a significant contribution to the broad patterns of our history.
- B** Property is associated with the lives of persons significant in our past.
- C** Property embodies the distinctive characteristics of a type, period, or method of construction, or represents the work of a master, or possesses high artistic values, or represents a significant and distinguishable entity whose components lack individual distinction.
- D** Property has yielded, or is likely to yield, information important in prehistory or history.

Criteria Considerations

(Mark "x" on all that apply.)

Property is:

- A** owned by a religious institution or used for religious purposes.
- B** removed from its original location.
- C** a birthplace or grave.
- D** a cemetery.
- E** a reconstructed building, object, or structure.
- F** a commemorative property.
- G** less than 50 years of age or achieved significance within the past 50 years.

Narrative Statement of Significance

(Explain the significance of the property on one or more continuation sheets.)

X See continuation sheet(s) for Section No. 8

9. Major Bibliographical References

Bibliography

(Cite the books, articles, and other sources used in preparing this form on one or more continuation sheets.)

Previous documentation on file (NPS):

- preliminary determination of individual listing (36 CFR 67) has been requested
- previously listed in the National Register
- previously determined eligible by the National Register
- designated a National Historic Landmark
- recorded by Historic American Buildings Survey # _____
- recorded by Historic American Engineering Record # _____

Areas of Significance

(Enter categories from instructions)

SOCIAL HISTORY

AGRICULTURE

Period of Significance

c.1902-1940s

Significant Dates

c.1902

Significant Person

(Complete if Criterion B is marked above)

N/A

Cultural Affiliation

N/A

Architect/Builder

Unknown

Name of repository:

X See continuation sheet(s) for Section No. 9

**United States Department of the Interior
National Park Service**

National Register of Historic Places Continuation Sheet

Section No. 8 Page 2

Santa Clara Tithing Granary, Santa Clara, Washington County, UT

Narrative Statement of Significance

The Mormon Tithing Granary of the Santa Clara Ward is significant for its association with the "Early Twentieth-Century Development: 1900-1940s" category of the "Historic and Architectural Resources of Santa Clara, Utah," Multiple Property Nomination. Tithing offices and granaries were found in almost every community of the territory from the time the area was settled up until the first couple of decades of the 20th Century. The granaries were used for storing grain and other produce donated by members of the Church of Jesus Christ of Latter-day Saints (LDS or Mormon church) in fulfillment of their tithing obligation. The Santa Clara tithing granary is unique as an example of a post-turn-of-the-century tithing granary in Utah, particularly for a stone granary, of which there were few.

The "Early Twentieth-Century Development" period saw little change from the previous period in Santa Clara. Fruit production was the chief occupation and source of income for the residents. The population grew but at a very slow pace. Because of its remoteness and climate, few people were attracted to Santa Clara as a place to live. But families expanded enough to require a larger replacement for the meeting house and the construction of a new school in the early part of the century. The fruit industry expanded greatly as means of transporting the produce improved. Trucks were purchased by some shippers to sell the fruit in out of state markets. Although the railroad never made it to the region, a major highway, the "Arrowhead Trail" was constructed right through Santa Clara in the 1920s. This brought many travelers to the area who bought fruit in the city at roadside stands. With the highway also came increased tourism which brought more business to the area, although mainly to St. George, the largest settlement in the region. Santa Clara thrived on the fruit industry until the Interstate-15 project bypassed the area in the 1970s.

When the Utah Territory was first settled in 1847 by members of the LDS church, the various communities were governed by precepts directed by the leadership of the church. Although the many settlements were mainly scattered along a four hundred-mile corridor, each one was basically established with the same plan and operated in the same manner to create a pattern of unity. Usually the ward (parish) bishop was the civic and spiritual leader of the community, and largely determined how the affairs in the community were handled.

A basic tenet of the LDS church is the payment of tithing. Tithing, as interpreted by the church, is the practice of contributing 10% of one's income or increase, either in cash or "in kind" (products or service, rather than money). The LDS church located in the Great Basin area to escape constant persecution from communities in the Eastern United States and by so doing largely separated itself from the country's economy. Cash was very scarce among the people who settled here and families were either self-sustaining or bartered for needed commodities. Tithing was paid on an annual basis and throughout the nineteenth century was mostly paid "in kind" by whatever the person produced most. Because a majority of the settlements in Utah were agrarian, this meant paying in grain and produce.

**United States Department of the Interior
National Park Service**

National Register of Historic Places Continuation Sheet

Section No. 8 Page 3

Santa Clara Tithing Granary, Santa Clara, Washington County, UT

Tithing lots were set up in the center of the towns and, depending on the size of the population, usually consisted of a barn and coops for keeping animals, a granary and cellar for keeping grain and produce, and possibly a tithing office. In most of the settlements managing the tithing lot and tithes was a full-time responsibility for the bishop. After the donated products and animals were received they were then disbursed to the needy or transported to Salt Lake City via regional offices where they were used or traded for various church needs. The LDS church's women's organization, the Relief Society, also had a program similar to the tithing system. The donations were used for similar purposes, but were distributed according to the Relief Society leaders' discretion. They often had their own granaries, meeting houses, and offices, depending on the circumstances of the community.

The Santa Clara tithing granary was constructed in c.1902 on property which had been purchased by Bishop John G. Hafen on February 13 of the same year for \$150 from the Santa Clara Ward Relief Society. The Relief Society apparently had a meeting house and maintained vineyards on some of the property. This they retained after the rest of the property was sold for the use of the tithing lot.¹ Also constructed on the tithing lot was a tithing office and barn which have both been demolished.

The tithing granary had a short life, and was only in use until 1908, when the church discontinued the acceptance of "in kind" contributions as the state became more assimilated into a cash economy. For several years the granary sat vacant until Emil Gubler offered to buy the property from the LDS church in June 1926. A portion of the property was parceled to Adolph Hafen on which to build a grocery store. From the granary, Mr. Gubler removed all but one of the grain bins from the top floor, and the building has been used for storage ever since.²

For a tithing granary, the Santa Clara building is fairly unique in its stone composition, particularly for the late date of its construction. Although there are other extant examples of stone granaries in the state, they are not tithing granaries and most were constructed in the nineteenth century. The two most common type of extant tithing granaries in the state are of lumber construction. The first type was of a reverse framing method known as an "inside out" granary because horizontal boards were attached to the inside of a 2"x 4" lumber frame, creating an internal crib in which to store the grain. With the framing on the outside, the weight of the grain could not force off the siding. The second type, not as common, was constructed of stacked 2"x 4" butt-jointed boards, which were spiked at the corners. This method is referred to as "false timbering."³ These two types are mainly found in the northern part of the state. Although stone outbuildings were common in the in almost all areas of Utah,

¹Nellie Gubler & Vivian Graff. "Santa Clara Ward: 1868-1955." Unpublished manuscript in possession of the authors, 1955. 2.

²Information sheet completed by Nellie M. Gubler, January 1998. Provided by Vickie Laswell, Santa Clara CLG.

³Roger Roper & Debbie Randall. Tithing Offices and Granaries of the Mormon Church Thematic Resources. National Register General Files, Utah State Historical Society, 1984. 2.

**United States Department of the Interior
National Park Service**

**National Register of Historic Places
Continuation Sheet**

Section No. 8 Page 4

Santa Clara Tithing Granary, Santa Clara, Washington County, UT

particularly in the central and southern areas, no extant, stone tithing granaries have been documented, making this building unique particularly for the good condition in which it remains.

United States Department of the Interior
National Park Service

National Register of Historic Places Continuation Sheet

Section No. 9 Page 5

Santa Clara Tithing Granary, Santa Clara, Washington County, UT

Bibliography

Arrington, Leanord. Great Basin Kingdom: An Economic History of the Latter-Day Saints, 1830-1900. Cambridge, MA: Harvard University Press, 1958.

Carter, Thomas. Building Zion: Folk Architecture in the Mormon Settlements of Utah's Sanpete Valley, 1849-1890. Unpublished Ph. D. dissertation, Indiana University, 1984.

Carter, Thomas and Peter Goss. Utah's Historic Architecture, 1847-1940. Salt Lake City, UT: University of Utah Graduate School of Architecture and Utah State Historical Society, 1991.

Gubler, Nellie M. & Vivian Graff. "Santa Clara Ward: 1868-1955." Unpublished manuscript, 1955.

Information sheet about the building completed by Nellie M. Gubler, January 1998. Provided by Vicki Laswell, Santa Clara CLG.

Roper, Roger & Debbie Randall. Tithing Offices and Granaries of the Mormon Church Thematic Resources. National Register Thematic Nomination General File, Utah State Historic Preservation Office, 1984.

Santa Clara Tithing Granary
Name of Property

Santa Clara, Washington County, Utah
City, County, and State

10. Geographical Data

Acreeage of property .87 acres

UTM References

(Place additional UTM references on a continuation sheet.)

A 1/2 2/6/4/1/6/0 4/1/1/2/7/0/0 B 1 11111 111111
Zone Easting Northing Zone Easting Northing

C 1 11111 111111 D 1 11111 111111

Verbal Boundary Description

(Describe the boundaries of the property.)

BEGINNING NW COR LOT 5 BLK 15 SANTA CLARA TOWN & FIELD SURVEY TH S 12 RDS TH E 6 RDS; TH N 142.5 FT; TH W 65.10 FT; TH N 55.5 FT; TH W 33.90 FT TO P.O.B. ALSO LOT 4 BLK 15 SCT&FS

Property Tax No.
SC-126-A-RD

 See continuation sheet(s) for Section No. 10

Boundary Justification

(Explain why the boundaries were selected.)

The Boundaries are those which were historically, and continue to be, associated with the building.

 See continuation sheet(s) for Section No. 10

11. Form Prepared By

name/title J. Cory Jensen/Historic Preservation Consultant
organization Santa Clara CLG date April 1998
street & number 671 South 560 East telephone (801) 224-0955
city or town Orem state UT zip code 84097

Additional Documentation

Submit the following items with the completed form:

- **Continuation Sheets**
- **Maps:** A **USGS map** (7.5 or 15 minute series) indicating the property's location.
A **Sketch map** for historic districts and/or properties having large acreage or numerous resources.
- **Photographs:** Representative **black and white photographs** of the property.
- **Additional items** (Check with the SHPO or FPO for any additional items.)

Property Owner

name Nellie M. Gubler
street & number 3105 Santa Clara Dr., P.O. Box 96 telephone (435) 673-2034
city or town Santa Clara state UT zip code 84675

Paperwork Reduction Act Statement: This information is being collected for applications to the National Register of Historic Places to nominate properties for listing or determine eligibility for listing, to list properties, and to amend existing listings. Response to this request is required to obtain a benefit in accordance with the National Historic Preservation Act, as amended (16 U.S.C. 470 *et seq.*).

Estimated Burden Statement: Public reporting burden for this form is estimated to average 18.1 hours per response including time for reviewing instructions, gathering and maintaining data, and completing and reviewing the form. Direct comments regarding this burden estimate or any aspect of this form to the Chief, Administrative Services Division, National Park Service, P.O. Box 37127, Washington, DC 20013-7127; and the Office of Management and Budget, Paperwork Reductions Projects (1024-0018), Washington, DC 20503.

**United States Department of the Interior
National Park Service**

National Register of Historic Places Continuation Sheet

Section No. PHOTOS Page 6

Santa Clara Tithing Granary, Santa Clara, Washington County, UT

Photo No. 1

1. Santa Clara Tithing Granary
2. Santa Clara, Washington County, Utah
3. Photographer: Cory Jensen
4. Date: March 1998
5. Negative on file at Utah SHPO.
6. North & east elevations of building. Camera facing southwest.

Photo No. 2

1. Santa Clara Tithing Granary
2. Santa Clara, Washington County, Utah
3. Photographer: Cory Jensen
4. Date: March 1998
5. Negative on file at Utah SHPO.
6. South & west elevations of building. Camera facing northeast.

Photo No. 3

1. Mormon Tithing Granary
2. Santa Clara, Washington County, Utah
3. Photographer: Cory Jensen
4. Date: March 1998
5. Negative on file at Utah SHPO.
6. South elevation of building. Camera facing north.

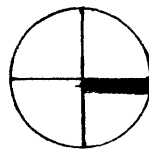
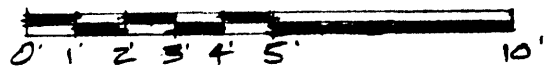
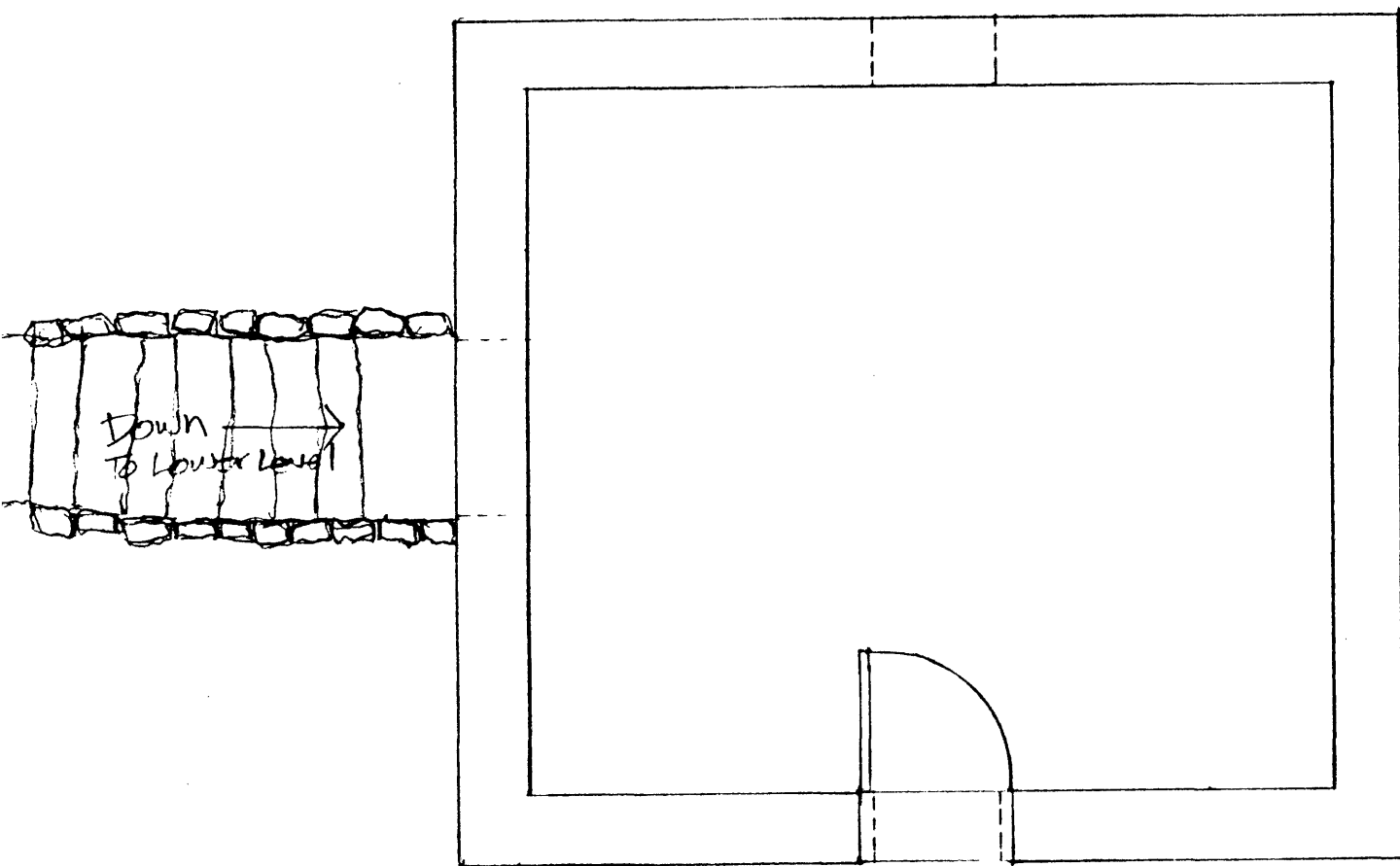

MAIN FLOOR PLAN

MORMON TITHING GRANARY
FLOOR PLAN APRIL 1998
SCALE 1/4" = 1'-0"
DRAWN BY CORY IENIEN

Farm Fields

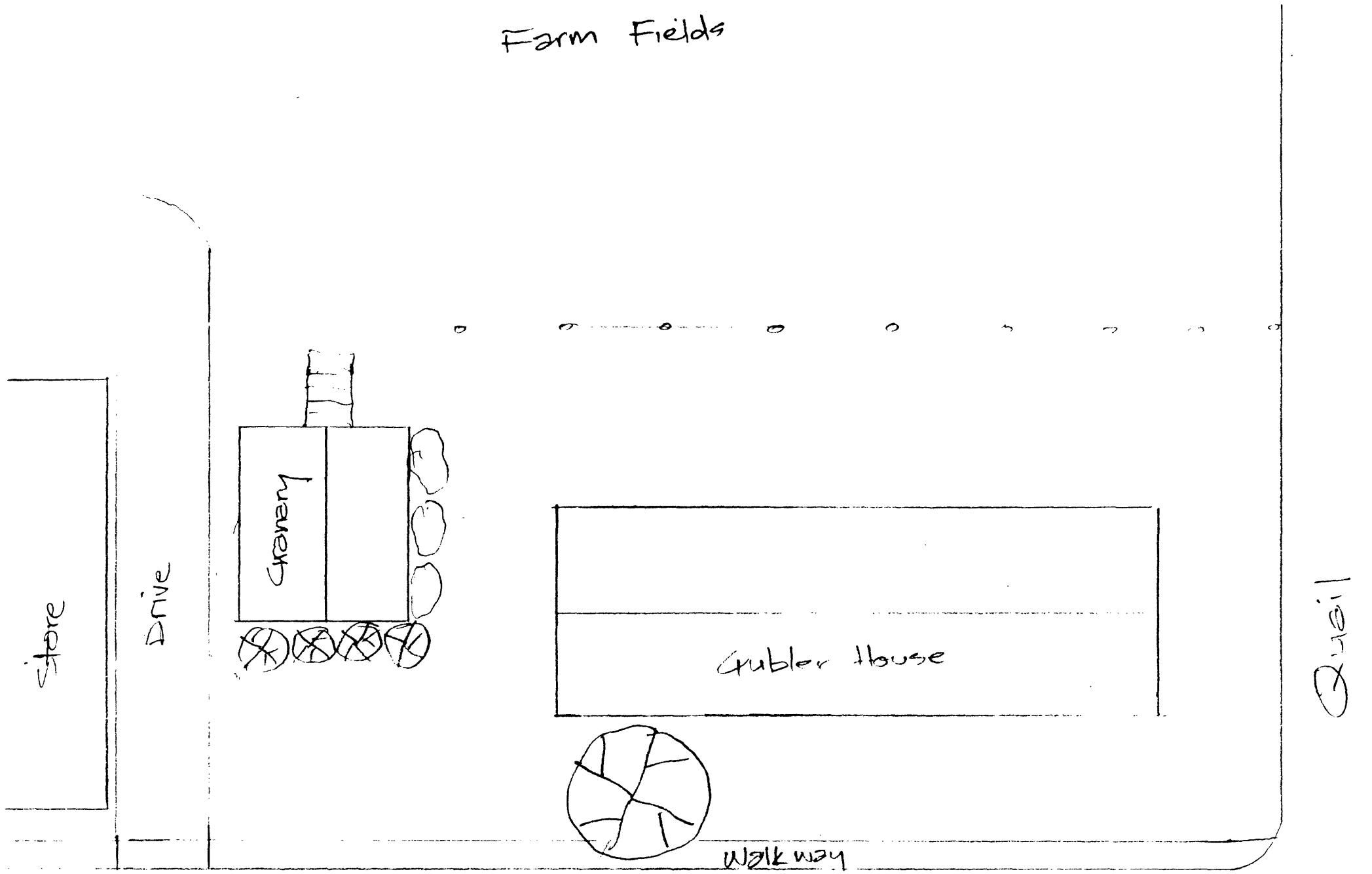

store

Drive

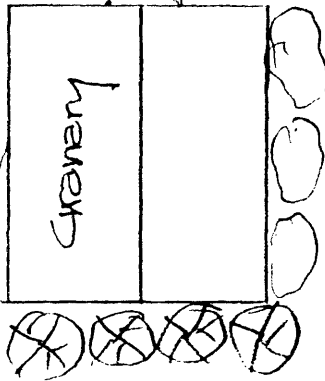

Granery

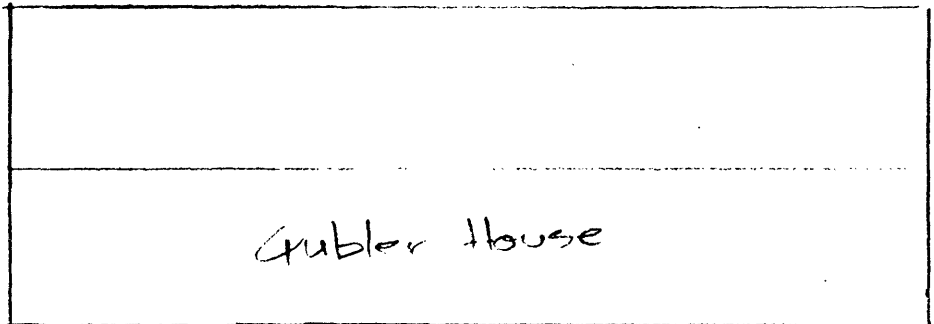

Gubler House

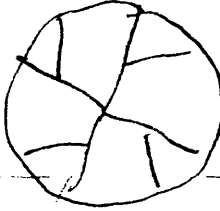

Walkway

Santa Clara Dr.

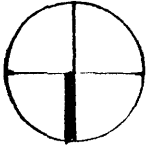

Quail

MORMON TITHING GRANA
SITE PLAN APRIL 1998
NOT TO SCALE
DRAWN BY: COEY JENSEN

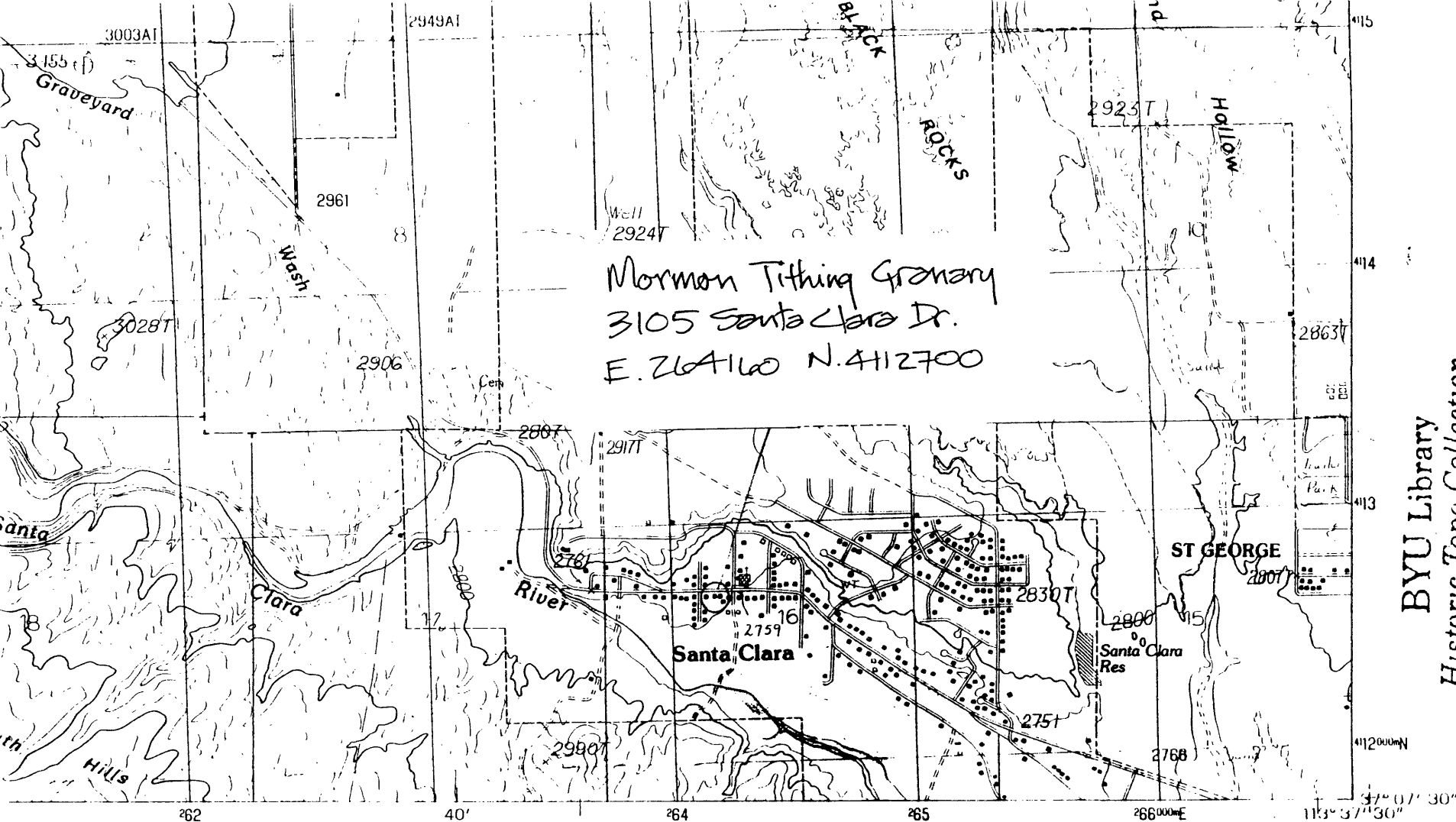

BYU Library
 Historic Topo Collection
DO NOT CIRCULATE

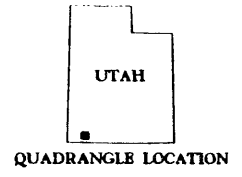
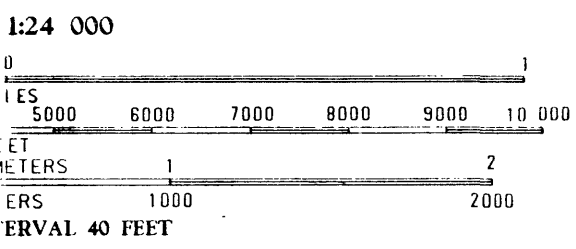

1	2	3	1 Goshute
			2 Vero
			3 Saddle Mountain
4		5	4 Shivwits
			5 Washington
			6 Jarvis Peak
			7 White Hills
6	7	8	8 St. George

ADJOINING 7.5' QUADRANGLE NAMES

INTERIOR GEOLOGICAL SURVEY, RESTON, VIRGINIA 1987

ROAD LEGEND

- Improved Road
- Unimproved Road
- Trail
- Interstate Route ○ U.S. Route ○ State Route

SANTA CLARA, UTAH
 PROVISIONAL EDITION 1986

37113-B6-TP-024

BYU LIBRARY
 MAP COLLECTION
 JUN 11 1987
 PROVO, UTAH

NATIONAL MAP ACCURACY STANDARDS
 SURVEY, DENVER, COLORADO 80225
 VIRGINIA 22092

copy 2