

United States Department of the Interior
National Park Service

National Register of Historic Places
Registration Form

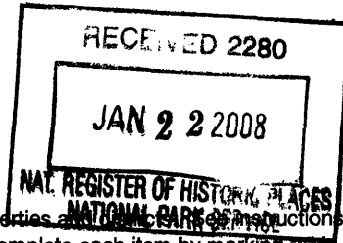

155

This form is for use in nominating or requesting determinations for individual properties and districts. See instructions in How to Complete the National Register of Historic Places Registration Form (National Register Bulletin 16A). Complete each item by marking "x" in the appropriate box or by entering the information requested. If any item does not apply to the property being documented, enter "N/A" for "not applicable." For functions, architectural classification, materials, and areas of significance, enter only categories and subcategories from the instructions. Place additional entries and narrative items on continuation sheets (NPS Form 10-900a). Use a typewriter, word processor, or computer to complete all items.

1. Name of Property

historic name Rock Hill Body Company
other names/site number Victoria Yarn Mill # 2

2. Location

street & number 601 West Main Street not for publication
city or town Rock Hill vicinity
state South Carolina code SC county York code 091 zip code 29730

3. State/Federal Agency Certification

As the designated authority under the National Historic Preservation Act of 1986, as amended, I hereby certify that this X nomination request for determination of eligibility meets the documentation standards for registering properties in the National Register of Historic Places and meets the procedural and professional requirements set forth in 36 CFR Part 60. In my opinion, the property X meets does not meet the National Register Criteria. I recommend that this property be considered significant nationally statewide X locally. (See continuation sheet for additional comments.)

Signature of certifying official Elizabeth M. Johnson Date 1/18/2008
Elizabeth M. Johnson, Deputy State Historic Preservation Officer, S.C. Dept. of Archives and History, Columbia, S.C.
State or Federal agency and bureau

In my opinion, the property meets does not meet the National Register criteria. (See continuation sheet for additional comments.)

Signature of commenting or other official _____ Date _____

State or Federal agency and bureau _____

4. National Park Service Certification

I, hereby certify that this property is:

- entered in the National Register
 See continuation sheet.
- determined eligible for the
 National Register
 See continuation sheet.
- determined not eligible for the
 National Register
- removed from the National Register
- other (explain):

Edson H. Beall Signature of the Keeper Date of Action 3-6-08

Rock Hill Body Company
Name of Property

York County, South Carolina
County and State

5. Classification

Ownership of Property
(Check as many boxes as apply)

Category of Property
(Check only one box)

Number of Resources within Property
(Do not include previously listed resources)

- private
- public-local
- public-State
- public-Federal

- building(s)
- district
- site
- structure
- object

Contributing

Noncontributing

_____ 1 _____

_____ _____

_____ _____

_____ 1 _____ 0 _____

buildings
sites
structures
objects
Total

Name of related multiple property listing
(Enter "N/A" if property is not part of a multiple property listing.)
Historic Properties of Rock Hill, S.C.

Number of contributing resources previously listed
in the National Register _____ 0 _____

6. Function or Use

Historic Functions

(Enter categories from instructions)

Category: Industry

Subcategory: Manufacturing Facility

Current Functions

(Enter categories from instructions)

Category: Commerce/Trade

Subcategory: Warehouse

7. Description

Architectural Classification

(Enter categories from instructions)

No Style

Materials

(Enter categories from instructions)

foundation Brick

walls Brick

roof _____

other Metal

Narrative Description

(Describe the historic and current condition of the property on one or more continuation sheets.)

United States Department of the Interior
National Park Service

National Register of Historic Places
Continuation Sheet

Section number 7 Page 5

Rock Hill Body Company
Name of Property
York County, South Carolina
County and State

The Rock Hill Body Company is a two-story brick industrial building located on West Main Street in Rock Hill. It was built ca. 1915 as a textile mill (Victoria Yarn Mill #2) and was the home of the Rock Hill Body Company from 1938 to 1986. It is currently being used for storage.

The front façade (facing northeast) has six bays and each side elevation has eleven bays. The large windows are wooden with an arrangement of eight-over-eight lights in a top section, nine-over-nine lights in a middle section, and eight-over-eight lights in the bottom section. A few windows have been altered by being reduced in size or being infilled with brick. On the façade, the lower floor has two windows, a large wooden freight door and a one-story office addition. On the Hardin Street side elevation (northwest), the windows have been covered with plywood and insulation materials. The windows are capped by arched brick openings. Along the sides, there are three brick buttress structures located at the front corner and evenly spaced along the wall. The rear (southwest) has a one-story brick addition with unevenly spaced windows and freight doors.

Alterations to the building include a one-story brick office section on the front. This section, which was added when the Rock Hill Body Company occupied the building in 1938, has a front gable and windows with arched brick above and a three-over-three-over-one arrangement of window panes. The rear of the building has a one-story additional and a tower addition housing a freight elevator. The southeast side also has a one-story extension. The original flat roof has been replaced with a metal roof structure with a gradual slope from a center ridgeline.

The surroundings of the building include a mixture of single-family residential and commercial uses and vacant land. In 2007, an apartment complex is under construction across Hardin Street from the property. The Rock Hill Body Company is located in the Rock Hill Textile Corridor, an area formerly heavily used by the textile industry and now under redevelopment by the City of Rock Hill and private developers.

Rock Hill Body Company
 Name of Property

York County, South Carolina
 County and State

8. Statement of Significance

Applicable National Register Criteria

(Mark "x" in one or more boxes for the criteria qualifying the property for National Register listing)

- A Property is associated with events that have made a significant contribution to the broad patterns of our history.
- B Property is associated with the lives of persons significant in our past.
- C Property embodies the distinctive characteristics of a type, period, or method of construction or represents the work of a master, or possesses high artistic values, or represents a significant and distinguishable entity whose components lack individual distinction.
- D Property has yielded, or is likely to yield information important in prehistory or history.

Criteria Considerations

(Mark "X" in all the boxes that apply.)

- a owned by a religious institution or used for religious purposes.
- b removed from its original location.
- c a birthplace or a grave.
- d a cemetery.
- e a reconstructed building, object, or structure.
- f a commemorative property.
- g less than 50 years of age or achieved significance within the past 50 years.

Areas of Significance

(Enter categories from instructions)

Industry

Period of Significance

ca. 1915-1958

Significant Dates

ca. 1915, 1938

Significant Person

(Complete if Criterion B is marked above)

Cultural Affiliation

N/A

Architect/Builder

Unknown

Narrative Statement of Significance

Explain the significance of the property on one or more continuation sheets.)

9. Major Bibliographical References

(Cite the books, articles, and other sources used in preparing this form on one or more continuation sheets.)

Previous documentation on file (NPS):

- preliminary determination of individual listing (36 CFR 67) has been requested.
- previously listed in the National Register
- previously determined eligible by the National Register
- designated a National Historic Landmark
- recorded by Historic American Buildings Survey # _____
- recorded by Historic American Engineering Record # _____

Primary location of additional data:

- State Historic Preservation Office
 - Other State agency
 - Federal agency
 - Local government
 - University
 - Other
- Name of repository:
York County Library, Rock Hill, S.C.

**United States Department of the Interior
National Park Service**

**National Register of Historic Places
Continuation Sheet**

Section number 8 Page 6

Rock Hill Body Company
Name of Property
York County, South Carolina
County and State

The Rock Hill Body Company building is an early twentieth century two-story industrial building located within Rock Hill's textile corridor. The Victoria Cotton Mill (originally the Globe Mill) began operation as Rock Hill's third textile mill in 1890. As the business grew, an annex was built about 1915 at this site nearby and was named Victoria Yarn Mill #2. During the Depression operations ceased at Victoria Yarn Mill #2, and the building was purchased in 1936 by J.C. Hardin. Hardin had been an employee of the Rock Hill Buggy Company and withdrew about 1916 when it was converted to the Anderson Motor Car Company to begin his own business repairing buggies and wagons on Black Street in downtown Rock Hill. By the early 1920s, Hardin had begun expanding his operations to include assembly of custom auto and truck bodies. He later added school bus bodies to the line. The Rock Hill Body Company became one of the earliest makers of truck bodies and school bus bodies in South Carolina. As the business grew, its manufacturing operations were moved to the Victoria Yarn Mill #2 in 1938, operated here until 1986. For many years, it was one of the largest producers of truck and school bus bodies in the Southeast. The company pioneered the development of special bodies for soft drink distribution trucks. The building, now used for storage, is owned by the third generation of the Hardin family.

The property is significant for its association with the early development of the textile industry in Rock Hill and also for its association with the important automotive manufacturing business of Rock Hill. Changes to the building after its purchase by the Rock Hill Body Company include a one-story office addition on the facade, an elevator tower on the rear (south), and a metal roof structure. The Rock Hill Body Company building meets the criteria of the property type "Textile Mill Buildings and Related Buildings" of the multiple property submission "Historic Resources of Rock Hill."

Rock Hill Body Company
Name of Property

York County, South Carolina
County and State

10. Geographical Data

Acreeage of Property Approximately 1 acre

UTM References

(Place additional UTM references on a continuation sheet)

Zone Easting Northing	Zone Easting Northing
1 <u>17 496526 3865302</u>	3 <u>17 496539 3865212</u>
2 <u>17 496571 2865268</u>	4 <u>17 496484 3865256</u>

See continuation sheet.

Verbal Boundary Description (Describe the boundaries of the property on a continuation sheet.)

Boundary Justification (Explain why the boundaries were selected on a continuation sheet.)

11. Form Prepared By

name/title Paul Gettys
 organization _____ date 18 January 2008
 street & number 4180 Cureton Ferry Road telephone (803) 329-3567
 city or town Catawba state SC zip code 29704

Additional Documentation

Submit the following items with the completed form:

Continuation Sheets

Maps

- A USGS map (7.5 or 15 minute series) indicating the property's location.
- A sketch map for historic districts and properties having large acreage or numerous resources.

Photographs

Representative **black and white** photographs of the property.

Additional items

(Check with the SHPO or FPO for any additional items)

Property Owner

(Complete this item at the request of the SHPO or FPO.)

name Daddy Rabbit, LLC c/o James C. Hardin, III
 street & number P.O. Box 190 telephone 803) 329-1612
 city or town Rock Hill state S.C. zip code 29731

Paperwork Reduction Act Statement: This information is being collected for applications to the National Register of Historic Places to nominate properties for listing or determine eligibility for listing, to list properties, and to amend existing listings. Response to this request is required to obtain a benefit in accordance with the National Historic Preservation Act, as amended(16 U.S.C. 470 et seq.). **Estimated Burden Statement:** Public reporting burden for this form is estimated to average 18.1 hours per response including the time for reviewing instructions, gathering and maintaining data, and completing and reviewing the form. Direct comments regarding this burden estimate or any aspect of this form to the Chief, Administrative Services Division, National Park Service, P.O. Box 37127, Washington, DC 20013-7127; and the Office of Management and Budget, Paperwork Reductions Project (1024-0018), Washington, DC 20503.

United States Department of the Interior
National Park Service

National Register of Historic Places
Continuation Sheet

Section number 10 Page 7

Rock Hill Body Company
Name of Property
York County, South Carolina
County and State

Verbal Boundary Description

The boundary of the nominated property is illustrated as a portion of the parcel at the corner of West Main Street and Hardin Street (formerly Lee Street), York County Tax Parcel # 5980901001, with a heavy black line marked "Rock Hill Body Company."

Boundary Justification

The boundary is restricted to the historic building associated with the operation of the Victoria Yarn Mill #2 and the Rock Hill Body Company and its immediate surrounding. It excludes a portion of the front section of the parcel, as well as the rear extension of the parcel along Hardin Street to Finley Road, because these portions contain non-historic buildings.

United States Department of the Interior
National Park Service

National Register of Historic Places
Continuation Sheet

Section number Photographs Page 8 Rock Hill Body Company
Name of Property
York County, South Carolina
County and State

The following information is the same for photographs 1-9:

Name of Property: Rock Hill Body Company
Location of Property: 601 West Main Street, Rock Hill
York County, South Carolina

Name of Photographer: Paul Gettys
Date of Photographs: 24 May 2007
Location of Original
Digital Images: S.C. Department of Archives & History, Columbia, S.C.

1. Northeast elevation [facade]
2. Oblique view of northeast elevation from West Main Street [looking southwest]
3. Oblique view of northeast elevation from near Hardin St./West Main St. intersection
4. Oblique view of northeast elevation [closer view]
5. Detail of Hardin Street elevation with window detail
6. Oblique view of southeast elevation with one-story section at left
7. Southeast elevation [looking northwest]
8. Oblique view of southwest elevation [rear] of one-story portion [with freight elevator tower]
9. Southwest elevation [rear, looking north]

York County GIS

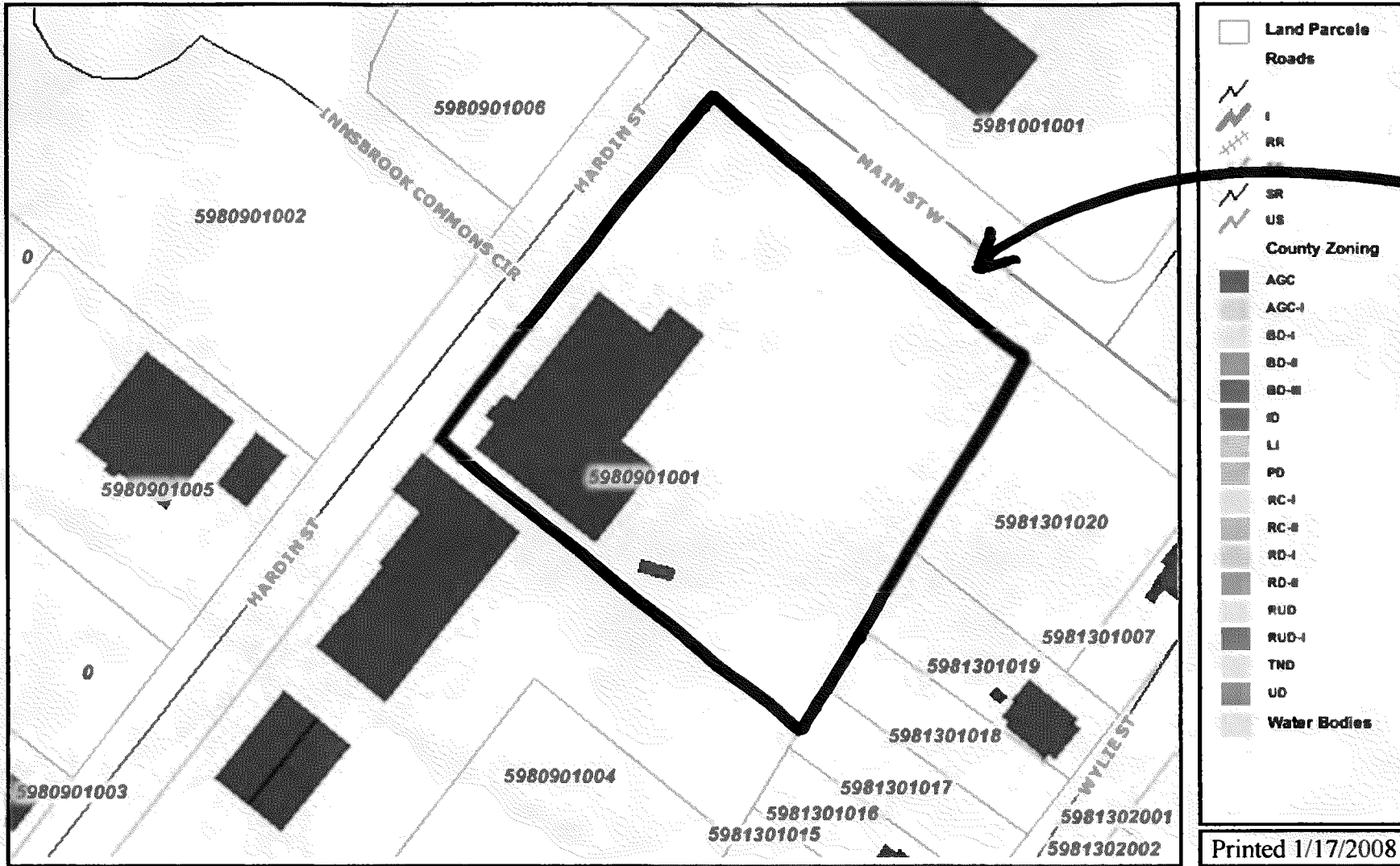

ROCK HILL
BODY
COMPANY

YORK COUNTY GOVERNMENT SOUTH CAROLINA, AND ITS MAPPING CONTRACTORS DO NOT WARRANT THE ACCURACY OF THE DISPLAYED INFORMATION AND SPECIFICALLY DISCLAIM ANY WARRANTY FOR MERCHANTABILITY OR FITNESS FOR A PARTICULAR PURPOSE. THIS MAP IS NOT A LEGAL SURVEY.