

**United States Department of the Interior
National Park Service**

**National Register of Historic Places
Continuation Sheet**

Section number _____ Page _____

SUPPLEMENTARY LISTING RECORD

NRIS Reference Number: 02001243

Date Listed: October 24, 2002

Property Name: Lincoln Elementary School

County: Delaware

State: Iowa

Public Schools for Iowa: Growth and Change
Multiple Name

This property is listed in the National Register of Historic Places in accordance with the attached nomination documentation subject to the following exceptions, exclusions, or amendments, notwithstanding the National Park Service certification included in the nomination documentation.

for Daniel J. Vivian
Signature of the Keeper

October 24, 2002
Date of Action

Amended Items in Nomination:

Section 8. Statement of Significance

"c. 1950" is hereby deleted as a significant date because it is not within the period of significance.

The Iowa State Historic Preservation Office was notified of this amendment.

DISTRIBUTION:

**National Register property file
Nominating Authority (without nomination attachment)**

AUG 27 2002

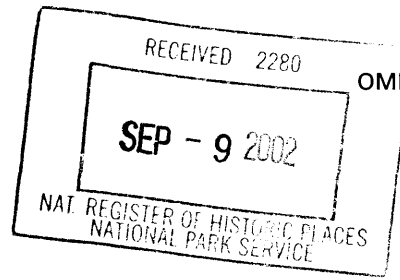

United States Department of the Interior
National Park Service

1243

NATIONAL REGISTER OF HISTORIC PLACES REGISTRATION FORM

This form is for use in nominating or requesting determinations for individual properties and districts. See instructions in How to Complete the National Register of Historic Places Registration Form (National Register Bulletin 16A). Complete each item by marking "x" in the appropriate box or by entering the information requested. If any item does not apply to the property being documented, enter "N/A" for "not applicable." For functions, architectural classification, materials, and areas of significance, enter only categories and subcategories from the instructions. Place additional entries and narrative items on continuation sheets (NPS Form 10-900a). Use a typewriter, word processor, or computer, to complete all items.

1. Name of Property

historic name Lincoln Elementary School

other names/site number

2. Location

street & number 401 Lincoln Street

not for publication N/A

city or town Manchester

vicinity N/A

state Iowa code IA county Delaware

code 055 zip code 52057

3. State/Federal Agency Certification

As the designated authority under the National Historic Preservation Act of 1966, as amended, I hereby certify that this nomination request for determination of eligibility meets the documentation standards for registering properties in the National Register of Historic Places and meets the procedural and professional requirements set forth in 36 CFR Part 60. In my opinion, the property meets does not meet the National Register Criteria. I recommend that this property be considered significant nationally statewide locally.

(See continuation sheet for additional comments.)

Rowell J. Sorlie
Signature of certifying official

August 28, 2002
Date

STATE HISTORICAL SOCIETY OF IOWA

State or Federal agency and bureau

In my opinion, the property meets does not meet the National Register criteria.

(See continuation sheet for additional comments.)

Signature of commenting or other official

Date

State or Federal agency and bureau

4. National Park Service Certification

I hereby certify that this property is:

entered in the National Register
See continuation sheet.

determined eligible for the
National Register

See continuation sheet.
determined not eligible for the
National Register

removed from the National Register
other (explain):

Daniel J. Vivian 10/24/02

DJV

Signature of the Keeper

Date of Action

5. Classification

Ownership of Property

(Check as many boxes as apply.)

- private
 public-local
 public-State
 public-Federal

Category of Property

(Check only one box.)

- building(s)
 district
 site
 structure
 object

Number of Resources within Property

| Contributing | Noncontributing | |
|--------------|-----------------|------------|
| <u>1</u> | <u>0</u> | buildings |
| <u>—</u> | <u>—</u> | sites |
| <u>—</u> | <u>—</u> | structures |
| <u>—</u> | <u>—</u> | objects |
| <u>1</u> | <u>0</u> | Total |

Number of contributing resources previously listed in the National Register: 0

Name of related multiple property listing (enter "N/A" if property is not part of a multiple property listing):

Public Schools for Iowa: Growth and Change, 1848-1966

6. Function or Use

Historic Functions (enter categories from instructions)

Cat: EDUCATION Sub: School

Current Functions (enter categories from instructions)

Cat: EDUCATION Sub: School

7. Description

Architectural Classification (enter categories from instructions):

Cat: LATE 19th AND EARLY 20th CENTURY AMERICAN MOVEMENTS Sub: Prairie

Materials (enter categories from instructions):

foundation Concrete

roof Tin

walls Brick

other

Narrative Description (Describe the historic and current condition of the property on one or more continuation sheets.)

8. Statement of Significance

Applicable National Register Criteria

(Mark "x" in one or more boxes for the criteria qualifying the property for National Register listing.)

- A Property is associated with events that have made a significant contribution to the broad patterns of our history.
- B Property is associated with the lives of persons significant in our past.
- C Property embodies the distinctive characteristics of a type, period, or method of construction or represents the work of a master, or possesses high artistic values, or represents a significant and distinguishable entity whose components lack individual distinction.
- D Property has yielded, or is likely to yield information important in prehistory or history.

9. Major Bibliographical References

(Cite the books, articles, and other sources used in preparing this form on one or more continuation sheets.)

Previous documentation on file (NPS)

- preliminary determination of individual listing (36 CFR 67) has been requested.
- previously listed in the National Register
- previously determined eligible by the National Register
- designated a National Historic Landmark
- recorded by Historic American Buildings Survey #
- recorded by Historic American Engineering Record #

Primary Location of Additional Data

- State Historic Preservation Office
- Other State agency
- Federal agency
- Local government
- University
- Other

Name of repository

10. Geographical Data

Acreage of Property: Less than one acre

UTM References (Place additional UTM references on a continuation sheet)

| | Zone | Easting | Northing | | Zone | Easting | Northing |
|---|-----------|------------------|--------------------|---|-------|---------|----------|
| 1 | <u>15</u> | <u>626389.67</u> | <u>4703753.894</u> | 3 | _____ | _____ | |
| 2 | _____ | _____ | _____ | 4 | _____ | _____ | |

See continuation sheet.

Verbal Boundary Description (Describe the boundaries of the property on a continuation sheet.)

Boundary Justification (Explain why the boundaries were selected on a continuation sheet.)

11. Form Prepared By

name/title Peggy Beedle, Architectural Historian

organization The Louis Berger Group, Inc. date 7/24/02

street & number 950 50th Street telephone 319-373-3043

city or town Marion state Iowa zip code 52302

Additional Documentation

(Submit the following items with the completed form.)

Continuation Sheets

Maps: A USGS map (7.5 or 15 minute series) indicating the property's location.

A sketch map for historic districts and properties having large acreage or numerous resources.

Photographs: Representative black and white photographs of the property.

Additional items (check with the SHPO or FPO for any additional items)

Property Owner

(Complete this item at the request of the SHPO or FPO.)

name West Delaware Community Schools

street & number 601 New Street telephone 563-927-3515

city or town Manchester state Iowa zip code 52057

Paperwork Reduction Act Statement: This information is being collected for applications to the National Register of Historic Places to nominate properties for listing or determine eligibility for listing, to list properties, and to amend existing listings. Response to this request is required to obtain a benefit in accordance with the National Historic Preservation Act, as amended (16 U.S.C. 470 et seq.).

Estimated Burden Statement: Public reporting burden for this form is estimated to average 18.1 hours per response including the time for reviewing instructions, gathering and maintaining data, and completing and reviewing the form. Direct comments regarding this burden estimate or any aspect of this form to the Chief, Administrative Services Division, National Park Service, P.O. Box 37127, Washington, DC 20013-7127; and the Office of Management and Budget, Paperwork Reductions Project (1024-0018), Washington, DC 20503.

Criteria Considerations

(Mark "x" in all the boxes that apply.)

- A owned by a religious institution or used for religious purposes
- B removed from its original location
- C a birthplace or a grave
- D a cemetery
- E a reconstructed building, object, or structure
- F a commemorative property
- G less than 50 years of age or achieved significance within the past 50 years

Areas of Significance (enter categories from instructions):

Architecture

Period of Significance

1916

Significant Dates

1916
c. 1950

Significant Person (complete if Criterion B is marked above)

N/A

Cultural Affiliation

Architect/Builder

Mayberry, R. R.

Narrative Statement of Significance (Explain the significance of the property on one or more continuation sheets.)

United States Department of the Interior
National Park Service

**NATIONAL REGISTER OF HISTORIC PLACES
CONTINUATION SHEET**

Section 7 Page 1

name of property: Lincoln Elementary School
county, state: Delaware County, Iowa

DESCRIPTION SUMMARY

The Lincoln Elementary School was designed by the architect R. R. Mayberry of Cedar Rapids, Iowa in 1916, in the Prairie Style. It is located on the corner of Lincoln Street and South Third Street, in a working-class residential area. There is open space to the west of the school; beyond that it is surrounded by houses, set on large lots, that were constructed before World War II. The area is separated from downtown Manchester by the Maquoketa River. A modern industrial area is being constructed several miles to the southwest of the school.

GENERAL DESCRIPTION

The Lincoln Elementary School is composed of the main block, which consists of three classrooms, and the addition that houses the mechanical elements. The school is one story, set on a basement, and constructed of reinforced concrete and brick. Above ground, it is finished with multi-colored brown brick, and accented with buff Bedford stone. There is a small addition on the west side, which houses the mechanical system. There are no outbuildings.

The front facade consists of a recessed entrance flanked by classrooms. The left classroom wall consists of ribbon windows, with transoms above; the right classroom has a blind window on the south side. The entrance is composed of a double door with sidelights and transom above. Each classroom has two exterior walls. One has ribbon windows with transoms, with stone sills, which are bracketed by perpendicular buttresses. The other wall has blind windows, which are flanked by buttresses. The buttresses are finished with stone saddleback caps. Decorative stonework adorns the buttresses and appears over the windows and main entrance.

The interior arrangement consists of a central hall with a terrazzo floor, and the three classrooms. At the front of each classroom there is a separate teacher's storage area, and a combined washroom/bathroom with separate entrances for boys and girls. Each room also had a built-in Wilson Sanitary Wardrobe, consisting of a set of storage cubbies with a roller door that closed over them. Bangor slate blackboards are on the two interior walls.

United States Department of the Interior
National Park Service

**NATIONAL REGISTER OF HISTORIC PLACES
CONTINUATION SHEET**

Section 8 Page 2

name of property: Lincoln Elementary School
county, state: Delaware County, Iowa

SIGNIFICANCE SUMMARY

Lincoln Elementary School is locally significant under Criterion C as an excellent example of the Prairie style. Evaluation of the Lincoln Elementary School for National Register eligibility is based upon criteria outlined in the Multiple Property Documentation Form *Public Schools for Iowa: Growth and Change, 1848-1966* (Beedle and Deiber 2002), under the property type "Elementary School." Lincoln Elementary embodies the design characteristics for a small school defined in *School Architecture*, by John J. Donovan in that schools with fewer than ten rooms were best constructed on one level. It is constructed of fire resistant brick and clay tile.

RESOURCE HISTORY AND HISTORIC CONTEXT

The Lincoln Elementary School was constructed in 1916. The architect was Robert R. Mayberry of Cedar Rapids, Iowa. He was also a builder, and designed houses, stores, and the school in Garrison, Iowa. His practice ran from c. 1911 to c. 1928, after which he worked for the Cedar Rapids Sash & Door Company.

The school was constructed in a small suburb of Manchester, separated from the main part of town by the Maquoketa River. Each classroom contained two grades, and the kindergarten was held in the hall. There were approximately fifteen to twenty students in each grade. The school was always named Lincoln, and the street was named after the school. Originally students went home for lunch, then during the 1950s and 1960s they were bussed to another school. Lunch is now delivered and served in the hall.

The school was originally heated by a coal-fired boiler in the basement, which has since been removed. The heating system is now housed in an addition.

Lincoln Elementary was closed in 1965, but reopened in 1967 as a first grade school. In the 1970s it was used for special education purposes. In the 1990s it once more became an elementary school.

United States Department of the Interior
National Park Service

**NATIONAL REGISTER OF HISTORIC PLACES
CONTINUATION SHEET**

Section 9 Page 3

name of property: Lincoln Elementary School
county, state: Delaware County, Iowa

MAJOR BIBLIOGRAPHICAL REFERENCES

Donovan, John J.
1921 *School Architecture*. The Macmillan Company, New York.

1916 Lincoln School Specifications.

Logan, Donna
2001 Personal Communication.

United States Department of the Interior
National Park Service

**NATIONAL REGISTER OF HISTORIC PLACES
CONTINUATION SHEET**

Section 10 Page 4

name of property: Lincoln Elementary School
county, state: Delaware County, Iowa

GEOGRAPHICAL DATA

Verbal Boundary Description

The proposed boundary for the Lincoln School includes the main block of the school and the open space associated with the school. The boundary consists of Lincoln Street to the south, South Third on the east, the alleyway between Lincoln and Kane streets on the north, and the tracks of the Chicago, Central Pacific Railroad on the west.

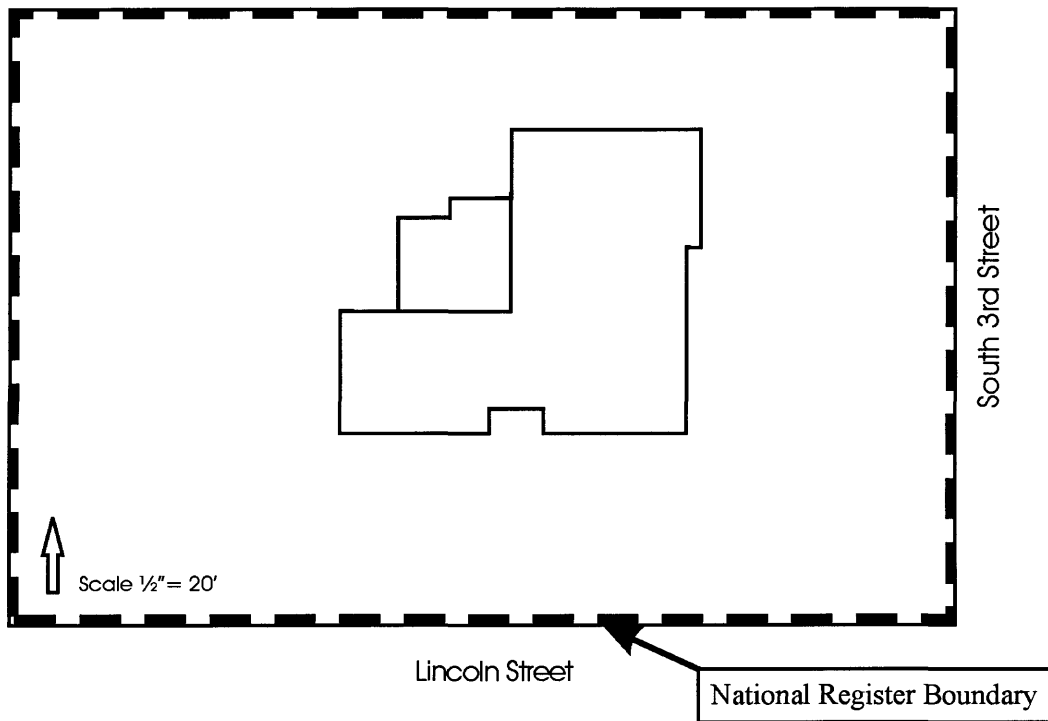

Boundary Justification

The proposed boundary includes the school and its associated open space that contribute to the setting of the architecturally significant resource. This includes all the historic features of the property but does not exceed the area of significance.

United States Department of the Interior
National Park Service

**NATIONAL REGISTER OF HISTORIC PLACES
CONTINUATION SHEET**

Section Photos Page 5 name of property: Lincoln Elementary School
county, state: Delaware County, Iowa

The following items apply to all photographs:

Property Name: Lincoln Elementary School

Location: Manchester, Delaware County, Iowa

Photographer: Peggy Beedle

Date of Photographs: 2002

Location of Negatives: The State Historical Society of Iowa, Community Programs Bureau, 600 E. Locust, Des Moines, Iowa.

Individual Photograph Identifications:

1. South elevation, facing north
2. South and west elevations, facing northeast
3. East and north elevations, facing southwest
4. North and west elevations, facing southeast
5. Open space, facing west
6. Entry hall, facing south
7. Classroom, facing northeast

United States Department of the Interior
National Park Service

**NATIONAL REGISTER OF HISTORIC PLACES
CONTINUATION SHEET**

Section Photos Page 6 name of property: Lincoln Elementary School
county, state: Delaware County, Iowa

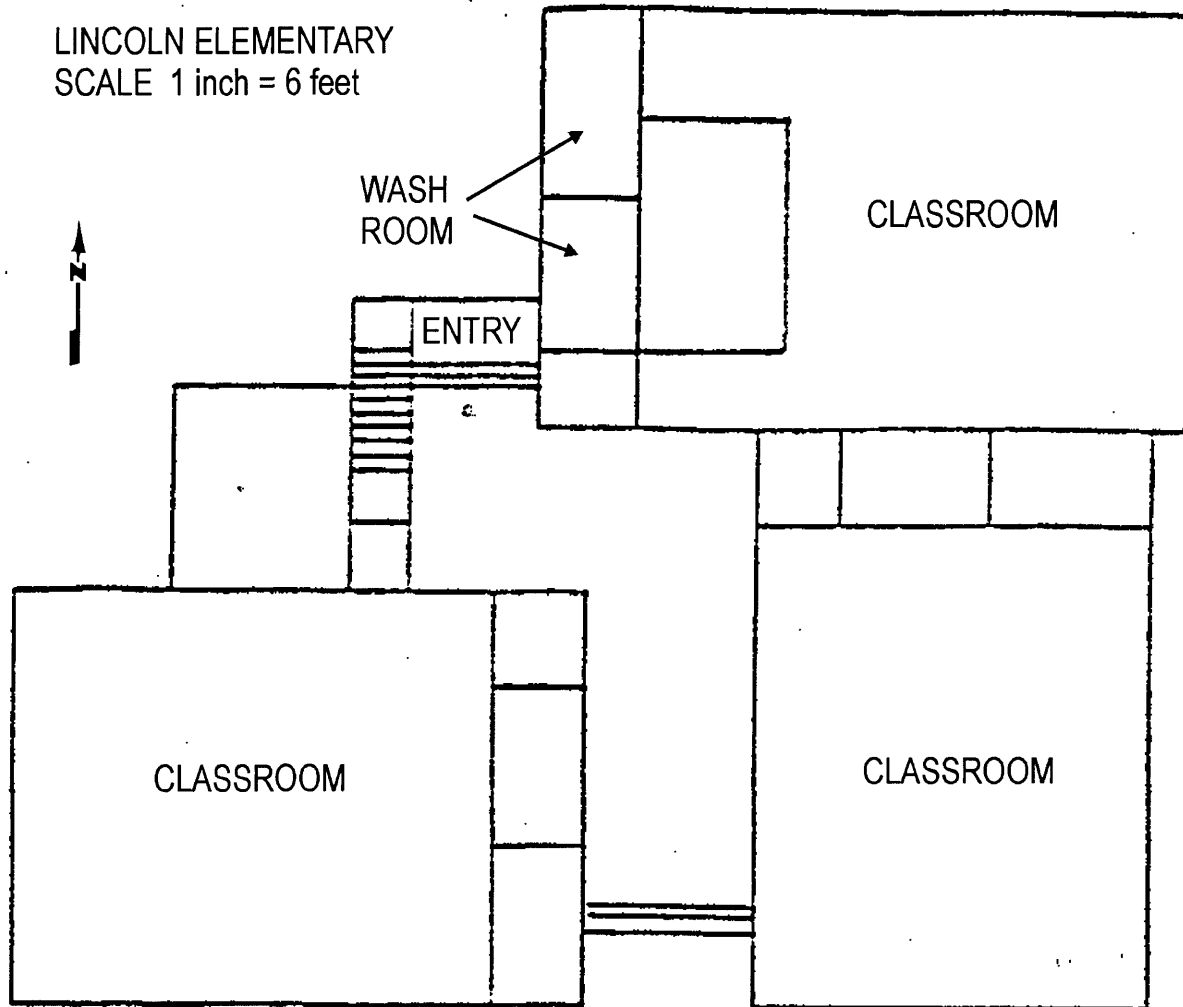

Main Office, Lincoln Elementary School, Manchester, Iowa, January 2002.