

KENTUCKY HISTORIC RESOURCES
Individual Inventory Form

Resource # 68
Shelby County

1. Name of Resource: Redmon House

2. Original Owner: Unknown

3. Other Names: None

4. Prehistoric Site Building Object
Historic Site Structure Other

5. Location: East side KY 395, 2 mi. N of Bagdad

6. Owner's Name: John Cook [P]

7. Owner's Address: Route 1, Box 318 Bagdad, KY 40083

8. Evaluation: NR [N]

9. Recognition & Date:
Nat.Landmark _____ Local Landmark _____
Nat.Register _____ HABS/HAER _____
Highway Marker _____ KY Inventory 8-15-80
KY Landmark Certificate _____

10. N.R.Status & Date:

11. N.R.Group:
District Name: []
Mult.Resource Area: Shelby County []
Thematic Name: []

12. Historical Theme:
Primary: Architecture [030]
Secondary: []
Other: []

13. Statement of Significance:
This property is significant under criteria C as a rare example of the log dogtrot form in Shelby County. Only one other dogtrot plan is recorded and it has been altered beyond recognition. Alterations to the structure do not compromise its form. [C]

14. History:
Property was occupied by Bohanon family in 1872. Owned by R.M. Redmon in 1882.

16. Date:
Original Building c. 1850 [6]
Addition c. 1980 [1]

17. Style: Antebellum Vernacular [3V]

18. Architect/Builder: Unknown

19. No. of Stories: 2 [2.0]

20. Original Floor Plan: Dogtrot [DT]

21. Single Pile Double Pile N.A.

22. Roof Form & Material: Original
Gable, standing seam metaNot Original

23. Structural Material: Log (hewn) [L]

24. Exterior Material: Sawn weatherboard [W]

25. Foundation Material: Stone, rubble [S]

26. Major Alterations: None
Moved/Rebuilt Other
 Additions

27. Special Features: None

28. Outbuildings: None [0]

29. Original Function: Residential/Domestic, single dwelling [01A]

30. Present Use: As above [01A]

31. Condition: Excellent [E]

32. Endangered: Yes _____
No

33. Attach Photos:
Roll: 5 Photo Nos: 13-17 No. of Slides: 1

15. Source of historical information and/or contact person: Interview with Mrs. John Cook, February 1986. Atlas of Henry and Shelby Counties, KY, 1882.

34. Prepared by: C. Worsham
35. Organization: V, Shelby Co. Hist. Society
36. Date: February 1986
37. New Survey _____ Resurvey

KENTUCKY HISTORIC RESOURCES
 Individual Inventory Form

Resource # 68

38. UTM Point of Primary Building:	Zone	Easting	Northing	39. G.I.S. Mod.	[]
Quadrant: No. Pleasureville	16	6 6 9 6 8 0	4 2 3 9 2 6 0	40. Coordi.Accuracy	[]

41. UTM Points of Boundary (for N. R. eligible sites only):

A.	-----	D.	-----
B.	-----	E.	-----
C.	-----	F.	-----

42. Total Acreage in Present Property: 1.37 43. Acreage included in proposed N.R. boundary: 0.42

44. Site Plan (and boundary description and justification for N.R. sites):

Beginning at A, in a corner of the drive, S 150' along the drive to B, W 120' along a fence to C, NW 100' with a fence to D, at KY 395, NE 100' along the east side of KY 395 to E, E 120' along the drive to the point of origin. Boundaries drawn to encompass the house and domestic space as defined by fences and drive as separate from fields. No contributing outbuildings.

Point A is at the intersection of a fence with the southern edge of the drive and is 83 feet north northeast of the northeastern corner of the ell.

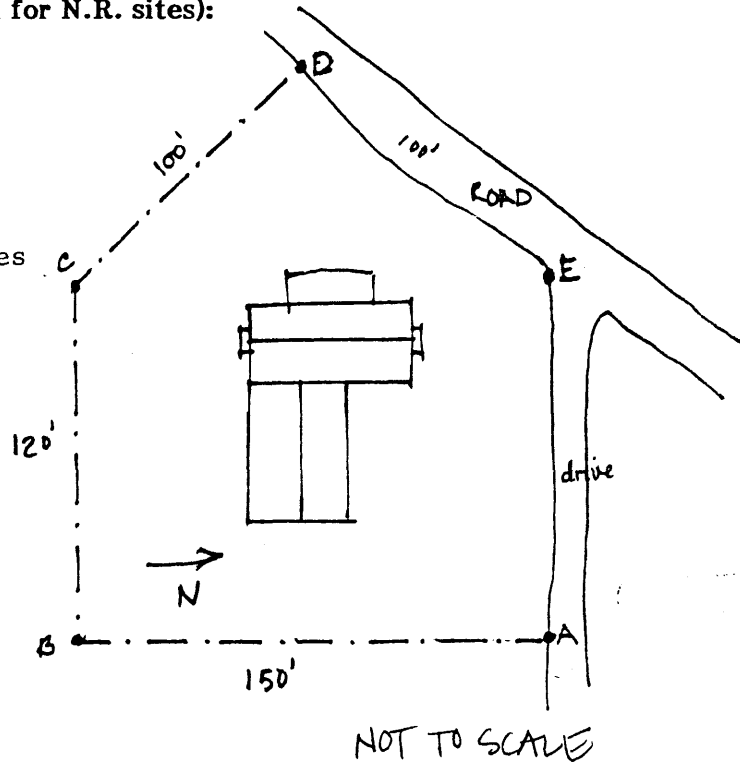

45. Description and House Plan:

Exterior

2-story, 3-bay log dogtrot with exterior stone end chimneys, rubble stone foundation, weatherboard, frame one-story replaced c. 1980 with brick veneer ell of same shape and proportions, hipped roof porch on brick piers 20th century, original 6/6 sash

Interior

Logs exposed in rear of house inside connection to ell, ell designed as self-contained unit for modern living so that log portion may be left intact, Greek Revival mantel in south log pen, mantel removed and closet added in north pen, high baseboard in north pen, low baseboard with no bead in south room, baseboard profiles similar in both pens and dogtrot, square open wall stair in dogtrot, eared on surrounds in dogtrot.

The boundaries enclose one contributing building.

