

United States Department of the Interior  
National Park Service

APR 19 1991

National Register of Historic Places  
Registration Form

NATIONAL  
REGISTER

This form is for use in nominating or requesting determinations of eligibility for individual properties or districts. See instructions in *Guidelines for Completing National Register Forms* (National Register Bulletin 16). Complete each item by marking "x" in the appropriate box or by entering the requested information. If an item does not apply to the property being documented, enter "N/A" for "not applicable." For functions, styles, materials, and areas of significance, enter only the categories and subcategories listed in the instructions. For additional space use continuation sheets (Form 10-900a). Type all entries.

1. Name of Property

historic name East Home Avenue Historic District  
other names/site number \_\_\_\_\_

2. Location Along East Home Avenue, from North Fifth Street to

street & number just east of First Avenue  not for publication  
city, town Hartsville  vicinity  
state South Carolina code SC county Darlington code 031 zip code 29550

3. Classification

Ownership of Property	Category of Property	Number of Resources within Property	
		Contributing	Noncontributing
<input checked="" type="checkbox"/> private	<input type="checkbox"/> building(s)	<u>54</u>	<u>6</u> buildings
<input type="checkbox"/> public-local	<input checked="" type="checkbox"/> district	_____	_____ sites
<input type="checkbox"/> public-State	<input type="checkbox"/> site	_____	_____ structures
<input type="checkbox"/> public-Federal	<input type="checkbox"/> structure	_____	_____ objects
	<input type="checkbox"/> object	_____	_____ Total

Name of related multiple property listing: Historic Resources of Hartsville, SC, c. 1817-c. 1941  
Number of contributing resources previously listed in the National Register 1

4. State/Federal Agency Certification

As the designated authority under the National Historic Preservation Act of 1966, as amended, I hereby certify that this  nomination  request for determination of eligibility meets the documentation standards for registering properties in the National Register of Historic Places and meets the procedural and professional requirements set forth in 36 CFR Part 60. In my opinion, the property  meets  does not meet the National Register criteria.  See continuation sheet.  
Mary W. Edmonds 3/4/91  
Signature of certifying official Date  
Mary W. Edmonds, Deputy SHPO, SC Department of Archives & History, Columbia, SC  
State or Federal agency and bureau

In my opinion, the property  meets  does not meet the National Register criteria.  See continuation sheet.  
\_\_\_\_\_  
Signature of commenting or other official Date  
\_\_\_\_\_  
State or Federal agency and bureau

5. National Park Service Certification

I, hereby, certify that this property is:  
 entered in the National Register.  
 See continuation sheet.  
 determined eligible for the National Register.  See continuation sheet.  
 determined not eligible for the National Register.  
 removed from the National Register.  
 other, (explain:) \_\_\_\_\_

Ray Federman 5/3/91  
\_\_\_\_\_  
Signature of the Keeper Date of Action

Signature of the Keeper

Date of Action

## 6. Function or Use

Historic Functions (enter categories from instructions)

Domestic/Single Dwelling  
Religion/Religious Structure  
Funerary/Cemetery  
Education/School

Current Functions (enter categories from instructions)

Domestic/Single Dwelling  
Religion/Religious Structure  
Funerary/Cemetery  
Education/School  
Education/College

## 7. Description

Architectural Classification

(enter categories from instructions)

Late 19th & 20th Century Revivals  
Colonial Revival; Classical Revival  
Italian Renaissance Revival

Materials (enter categories from instructions)

foundation Brick  
walls Wood/Weatherboard  
Brick  
roof Asphalt; Slate; Ceramic Tile  
other Stone

Describe present and historic physical appearance.

The East Home Avenue Historic District is a collection of 60 primarily residential properties located on East Home Avenue from North Fifth Street to just east of First Avenue. The district contains 54 properties which contribute to the historic character of the district and 6 which are non-contributing. One property, the John L. Hart House, was listed individually in the National Register in 1983. The historic resources of the district date from c. 1840 to c. 1938. The majority of resources date from c. 1890 to c. 1938, a particularly significant period of development in Hartsville.

These properties generally conform to the descriptions of property types "Residences" and "Public Facilities." The contributing properties meet the registration requirements outlined under these property types.

1. 104 East Home Ave., Lawton Building, First Baptist Church: c. 1938; two-story, stuccoed building with raised basement and cross gable roof, classical influence.
2. 104 East Home Ave., First Baptist Church: 1908; designed by Charles Coker Wilson; temple-front Neoclassical church with symmetrical five bay facade. Stucco covered masonry construction. Engaged, full facade portico with six fluted Ionic columns. Central entry with elaborate pedimented surround. Starburst traceried windows. Side elevations feature large arched windows. This building was constructed to house the congregation of the Hartsville Baptist Church, established in 1850 and located on land donated by John L. Hart. It served as the sanctuary until a new facility was built in 1964 and has been used as a chapel since. Charles Coker Wilson (1864-1933) was a native of Hartsville and 1886 graduate of South Carolina College (now the University of South Carolina) with postgraduate study in civil engineering. His notable designs included many buildings for schools and colleges, such as Neville Hall at Presbyterian College (1907) and Davis and LeConte Colleges at the University of South Carolina (1908 and 1910, respectively). His other designs in Hartsville include the J.L. Coker and Company Building (1910), and Davidson Hall at Coker College (1909-1910), both of which were individually listed in the

**8. Statement of Significance**

Certifying official has considered the significance of this property in relation to other properties:

nationally  statewide  locally

Applicable National Register Criteria  A  B  C  D

Criteria Considerations (Exceptions)  A  B  C  D  E  F  G

Areas of Significance (enter categories from instructions)

Architecture  
Industry  
Social History

Period of Significance

c. 1840 - c. 1938

Significant Dates

1890

Cultural Affiliation

N/A

Significant Person

Multiple

Architect/Builder

Wilson, Charles Coker

Johnson, J. Carroll

State significance of property, and justify criteria, criteria considerations, and areas and periods of significance noted above.

The East Home Avenue Historic District is significant for its association with the residential development of Hartsville from c. 1850 to c. 1938; as a reflection of the diverse architectural styles and influences of that period; and for its association with the leading figures of the town's history. Home Avenue has historically been the major residential street in Hartsville since it was laid out and landscaped in 1890. This district specifically illustrates the residential and commercial/industrial growth of Hartsville for the period 1890-c. 1938.

See continuation sheet

## 9. Major Bibliographical References

See continuation sheet

### Previous documentation on file (NPS):

- preliminary determination of individual listing (36 CFR 67) has been requested
- previously listed in the National Register
- previously determined eligible by the National Register
- designated a National Historic Landmark
- recorded by Historic American Buildings Survey # \_\_\_\_\_
- recorded by Historic American Engineering Record # \_\_\_\_\_

See continuation sheet

### Primary location of additional data:

- State historic preservation office
- Other State agency
- Federal agency
- Local government
- University
- Other

### Specify repository:

SC Department of Archives & History,  
Columbia, SC

## 10. Geographical Data

Acreage of property 44.3 acres

### UTM References

A 

1	7	5	8	5	9	0	0	3	8	0	4	7	5	0
Zone	Easting		Northing											

C 

1	7	5	8	5	0	4	0	3	8	0	4	0	0	0
Zone	Easting		Northing											

B 

1	7	5	8	6	1	4	0	3	8	0	4	5	2	0
Zone	Easting		Northing											

D 

1	7	5	8	4	8	2	0	3	8	0	4	3	6	0
Zone	Easting		Northing											

See continuation sheet

### Verbal Boundary Description

The boundary of the nomination is shown as the broken line labeled "East Home Avenue Historic District," on the accompanying map, "City of Hartsville," drawn at a scale of 1" = 500'.

See continuation sheet

### Boundary Justification

The nominated property includes significant and intact properties along East Home Avenue from North Fifth Street to a point just east of First Avenue, and retains integrity of location, design, setting, materials, workmanship, feeling, and association.

See continuation sheet

## 11. Form Prepared By

name/title Julie Turner, Survey Architectural Historian/J. Tracy Power, NR Historian

organization SC Department of Archives & History date 13 June 1990

street & number PO Box 11669 telephone (803) 734-8610

city or town Columbia state SC zip code 29211

United States Department of the Interior  
National Park Service

National Register of Historic Places  
Continuation Sheet

Section number 7 Page 2

---

- National Register in 1983; and the David R. Coker House (1915-1916), also in this historic district. (1)
3. 104 East Home Ave., First Baptist Church Cemetery: earliest graves appear to date to c. 1840. Several prominent Hartsville residents are buried in the cemetery including Major James Lide Coker.
  4. 104 East Home Ave., First Baptist Church Family Life Center: non-historic, non-contributing.
  5. 100 Block East Home Ave., John L. Hart House: c. 1850; one-and-one-half story, lateral gable, frame house. Individually listed in the National Register in 1983.
  6. 107 East Home Ave., R.J. Fletcher House: 1910-1915; two-story frame house, hip roof with lower cross gable, asymmetrical facade, full facade porch which wraps to left elevation, pedimented entries at porch corner and central facade, Ionic column porch supports, bracketed cornice, decorative shingles in gable. Built for R.J. Fletcher, a local businessman who operated a livery stable on College Street. (2)
  7. 113 East Home Ave.: c. 1930; two-story, lateral gable, frame house; alterations include synthetic siding and screened porch.
  8. 114 East Home Ave., George J. Wilds, Jr., House: c. 1920; two-and-one-half story, frame, Colonial Revival residence. Lateral gable roof, pedimented gable roof dormers, symmetrical three bay facade, central entry, pedimented one-story portico. Sleeping porch with deck at left elevation. Frame garage. Built c. 1920 for Dr. George J. Wilds, Jr. Wilds, a 1913 graduate of the University of South Carolina with a graduate degree from Cornell University, was a horticulturalist who worked closely with David R. Coker in the propagation of improved strains of cotton, wheat, and oats. Wilds served as president of Coker's Pedigreed Seed Company from 1938-1951. (3)
  9. 115 East Home Ave.: c. 1930; one-story frame residence, hip roof; altered siding, porch, addition; non-contributing. A garage is at rear.
  10. 100 Block East Home Ave.: c. 1905; one-and-one-half story, gambrel roof, Colonial Revival cottage with shingle siding. Moved from 207 E. College Street.

United States Department of the Interior  
National Park ServiceNational Register of Historic Places  
Continuation SheetSection number 7 Page 3

11. 100 Block East Home Ave.: c. 1905; one-and-one-half story, cross gambrel roof, Colonial Revival cottage with shingle siding.
12. 122 East Home Ave., First Baptist Church Parsonage: 1943; non-historic, non-contributing.
13. 123 East Home Ave.: c. 1930; one-story, lateral gable, brick veneer residence; Colonial Revival influence. Built for W.H. Sory as rental property.
14. 125 East Home Ave.: c. 1930; one-story, gable roof, brick veneer residence; Craftsman influence. A brick veneer garage is at rear.
15. 127 East Home Ave., A.L.M. Wiggins House: 1916-1917; designed by W.J. Wilkins & Co. of Florence; Craftsman/Bungalow. One-and-one-half story, hip roof, hip dormer, engaged full facade porch with brick piers, stucco cladding, exposed rafters. A stuccoed garage is at rear. Built for A. Lee M. Wiggins (1891-1980), prominent Hartsville businessman, banker, executive, and public servant. Wiggins, a 1913 graduate of the University of North Carolina, was an officer of J.L. Coker and Company for many years, as well as Coker's Pedigreed Seed Company, and the Coker Cotton Company, and served as president of the Bank of Hartsville. He also served as Under Secretary of the United States Treasury 1947-48, and chairman of the board of the Atlantic Coast Line and Louisville and Nashville Railroads 1948-1961. (4)
16. 210 East Home Ave., James L. Coker, Jr., House: 1924; designed by J. Carroll Johnson; Italian Renaissance residence. Two-story, hip roof with red Spanish tile roofing (Ludovici Celadon), over-hanging eaves with exposed decorative rafters, structural clay tile construction with stuccoed exterior walls, symmetrical facade, central entry within arcaded loggia, balcony above loggia with decorative iron work, terrace across full facade, pergolas at each side elevation. Frame building at rear. Built for James L. Coker, Jr. (1863-1931), engineer and prominent local manufacturer. Coker, an 1888 graduate of the Stevens Institute of Technology, established the Carolina Fiber Company in 1890 with his father, Major James Lide Coker. He later served as its president 1918-1931 and was instrumental in the creation of the Southern Novelty Company (later Sonoco Products Company) in 1899, which is included as an individual property in this multiple property submission. (5) The house was designed by J. Carroll Johnson (1882-1967), prominent twentieth-century architect of Columbia. Johnson's other Hartsville designs

United States Department of the Interior  
National Park ServiceNational Register of Historic Places  
Continuation SheetSection number 7 Page 4

included the J.B. Gilbert House (1929), an individual property in this multiple property submission, and Memorial Hall (1913), part of the Memorial Hall/General Service Building at Coker College, which was individually listed in the National Register in 1989. The house is located on the site of Major James Lide Coker's house, which burned in 1922.

17. 213 East Home Ave., David R. Coker House: 1915-1916; designed by Charles Coker Wilson. Two-and-one-half story, slate hip roof with wide eaves, gable roof dormer with flared eaves, asymmetrical facade, one-story, flat roofed porch across partial facade and left elevation, porte cochere, herringbone and diamond motif decorative brickwork below eaves. Built for David R. Coker (1870-1938), an 1891 graduate of South Carolina College (now the University of South Carolina) who undertook an extensive program of scientific research and development of new strains of cotton and other crops resistant to blight and vermin, extension services to tens of thousands of farmers, and pedigreed seeds. He established the Pedigreed Seed Company (later Coker's Pedigreed Seed) in 1914. The Coker Experimental Farms complex associated with these scientific developments was designated a National Historic Landmark in 1964.(6) The house was designed by Charles Coker Wilson, prominent twentieth-century South Carolina architect, whose other Hartsville designs include the First Baptist Church (1908), also part of this historic district.
18. 222 East Home Ave.: constructed 1908, integrity from 1934 remodelling probably designed by Willis Irvin. Two-story, brick veneer, Colonial Revival residence. Slate hip roof with lower cross gable, asymmetrical facade, projecting entry bay, modillion cornice, broken pediment door surround. Garage with living quarters. Landscape architect Earle S. Draper drew plans for this property in 1920. It is not known if this landscape design was implemented or is intact.
19. 303 East Home Ave., Walter F. Smith House: c. 1905; two-story, rectangular plan, frame residence with shingle cladding, showing Colonial Revival influence. Truncated hip roof with balustrade (balustrade lost in Hurricane Hugo, September 1989), interior chimneys with corbelled caps, symmetrical three bay facade, paired 16/1 double-hung-sash windows, central entry with fanlight and sidelights. Balcony above entry with balustrade, double doors, side lights and transom. One-story porch across full facade wraps to side elevations, simple tuscan column supports on pedestals,

United States Department of the Interior  
National Park ServiceNational Register of Historic Places  
Continuation SheetSection number 7 Page 5

slat balustrade. Built for Walter F. Smith, prominent manufacturer who came to Hartsville in 1899 from the Pairpoint Corporation in New Bedford, Massachusetts. Smith was recruited by the Southern Novelty Company for his expertise in manufacturing paper cones for the textile industry and was instrumental in the company's early technological success. He also founded the Eastern Carolina Silver Company, which manufactured silver plated ware in Hartsville from 1907 to 1909. (7)

20. 306 East Home Ave., Joseph J. Lawton House: 1938 remodelling by New York architect Penrose Stout. Two-story, frame, Neoclassical residence. Gable roof, engaged two-story portico, monumental Tuscan columns, second floor balcony, dentil course, modillion cornice. Shiplap siding, flushboard siding below balcony, paired and single six-over-six double-hung-sash windows with transoms, central entry with decorative side lights and transom, classical architrave. Solarium to left elevation. Associated with Joseph James Lawton (1861-1941), a prominent local industrial leader. Lawton, who attended Furman University, established the Hartsville Oil Mill in 1900, and became a leader in the cotton seed oil industry in South Carolina. He was also associated with the Hartsville Fertilizer Company, Hartsville Ice and Fuel Company, Arcade Hotel Company, J.L. Coker & Company, Coker's Pedigreed Seed Company, and Carolina Fiber Company. (8)
21. 314 East Home Ave., Fitchett House: constructed c. 1900; 1947 remodelling designed by C. Hardy Oliver. Frame, two-story Colonial Revival residence. Non-contributing.
22. 404 East Home Ave., J.S. White House: constructed c. 1890 as one-story, remodelled with second story addition c. 1910. Two-and-one-half story, rectangular plan, cross gable roof, house. Symmetrical three bay facade, paired and single two-over-two double-hung-sash, Queen Anne block glass sash in front gable, decorative shingle work and spindle gable motifs. Wrap-around porch with canted entry to right elevation. A garage is at the rear. Built for J.S. White, prominent local merchant and civic leader who served as mayor of Hartsville 1894-95 and 1897-99. (9)
23. 408 East Home Ave., Leonce Vaughan House: c. 1908. Two-story, hip roof, frame residence showing Colonial Revival influence. Tall interior chimneys with corbelled caps. Symmetrical three bay facade, paired one-over-one double-hung-sash windows, central entry, broken sidelights and transom. One-story, hip roof porch wraps to right



United States Department of the Interior  
National Park ServiceNational Register of Historic Places  
Continuation SheetSection number 7 Page 6

- elevation, fluted Ionic columns, pedimented entry, pedimented balcony at second story. Built for Leonce Vaughan (1860-1933), a prominent local banker who helped organize the Bank of Hartsville in 1903 and served as its president from 1910 to his death.(10)
24. 414 East Home Ave.: c. 1920; one-and-one-half story, lateral gable, frame, Craftsman residence.
  25. 502 East Home Ave.: 1910-1915; two-story, hip roof, frame residence. One-story porch with classical supports, pedimented entry, left end bay enclosed.
  26. 506 East Home Ave.: 1870-1890; one-story, lateral gable, frame residence. Exterior end chimney, three bay symmetrical facade, six-over-six double-hung-sash windows, central entry with sidelights and transom, molded surround, full facade porch, chamfered supports, sawn balustrade. A frame garage is located at the rear.
  27. 507 East Home Ave., Watt House: 1904-1910; one-story, frame residence, hip roof with lower cross gables. Shed addition to right elevation. A frame garage is at the rear.
  28. 511 East Home Ave.: 1905-1910; one-story, frame residence, lateral gable roof with lower cross gable over canted bay. Left porch bay enclosed with glass. A frame garage is at the rear.
  29. 512 East Home Ave.: 1937; designed by Thomas Harmon, Colonial Revival residence. One-story, lateral gable, brick veneer, pedimented portico, flushboard siding under portico. Shed. Built for Ivey Harmon of McBee as rental property.
  30. 514 East Home Ave.: c. 1935; one-story, hip roof, frame residence, Colonial Revival influence. Siding.
  31. 515 East Home Ave.: c. 1905; one-story, frame residence, ell plan, cross clipped gable roof. Siding.
  32. 516 East Home Ave., George M. Camp House: c. 1900; one-story, frame, cross gable roof, residence. Alterations: enclosed porch bay, siding. Built for George Mills Camp, who was associated with Carolina Fiber Company.(11)
  33. 519 East Home Ave.: c. 1910; one-story, cross gable, frame residence. A frame shed is at rear.

United States Department of the Interior  
National Park Service

National Register of Historic Places  
Continuation Sheet

Section number 7 Page 7

---

34. 520 East Home Ave.: 1901; one-story, frame residence, hip roof with lower cross gables. Alterations: enclosed porch bay, asbestos shingle siding. A frame garage is at rear.
35. 523 East Home Ave., G.A. Kalber House: c. 1910; one-story, frame residence, hip roof with lower cross gables. Alterations: shed additions to right elevation. A frame garage is at rear. Associated with Gustave A. Kalber, who purchased the house in 1916. Kalber was a founding partner in the Coker Cotton Company.(12)
36. 500 Block East Home Ave., Apartment Complex: two, two-story buildings with deep setback. Non-historic, non-contributing.
37. 527 East Home Ave., John Denny House: c. 1910; one-and-one-half story, frame residence, lateral gable roof, large gable dormer, decorative shingles. A garage is at rear. Associated with John Denny, a local merchant and civic leader who purchased the house in 1915. He established Denny Brothers Jewelry Store in 1908, served on the city council, and helped plan Magnolia Cemetery.(13)
38. 530-530A East Home Ave.: c. 1905: one-story, cross gable, frame residence. Alteration: porch partially removed.
39. 531 East Home Ave.: c. 1930; one-story, hip roof, frame residence, gable roof porch.
40. 533 East Home Ave.: c. 1930; one-story, lateral gable, frame residence, gable roof porch. Siding. A garage is at rear.
41. 601 East Home Ave.: 1923; one-story, gable roof, frame, Craftsman residence. A garage is at rear.
42. 604 East Home Ave., Thornwell Elementary School: 1926; designed by Wilkins and Hopkins of Florence. Two-story, rectangular plan, brick school. Single, paired, and grouped nine-over-nine double-hung-sash windows. Projecting end bays, projecting central entry bay, decorative brick courses and cast stone work. Built to replace an earlier grammar school on the same site which burned in 1925. Named for Dr. J.H. Thornwell, who was superintendent of Hartsville's schools from 1919-1944.(14)
43. 606 East Home Ave., Hartsville Public School: 1902. Two-story, rectangular plan, hip roof, brick school. Paired and single six-over-six double-hung-sash windows, central entry, transom.

United States Department of the Interior  
National Park ServiceNational Register of Historic Places  
Continuation SheetSection number 7 Page 8

Chimneys removed. Built in 1902 as a public school on land donated by Major Coker. After the construction of a graded school on an adjacent site in 1909, this building served as Hartsville's high school until 1925. (15)

## NOTES

(1) Yates Snowden, Editor, History of South Carolina, Volume V (Chicago and New York: The Lewis Publishing Company, 1920), pp. 182-83; Who's Who in the South: A Business, Professional and Social Record of Men and Women of Achievement in the Southern States: 1927. Washington: The Mayflower Publishing Company, 1927), p. 785; Henry F. Withey and Elsie Rathburn Withey, Biographical Dictionary of American Architects (Deceased), Reprint Edition (Los Angeles: Hennessey and Ingalls, 1970), pp. 662-63; National Register of Historic Places Files, South Carolina State Historic Preservation Office, South Carolina Department of Archives and History, Columbia, S.C.

(2) Lucile Boswell Neely, Hartsville: Our Community, Revised Edition (Columbia: R.L. Bryan Company, 1965), p. 17.

(3) Ibid., pp. 222-23; George Lee Simpson, Jr., The Cokers of Carolina: A Social Biography of a Family (Chapel Hill: University of North Carolina Press for the Institute for Research in Social Science, 1956), pp. 159, 217, 273-74, 282-83; "The Hartsville Lawtons," unpublished paper in National Register of Historic Places Files, South Carolina State Historic Preservation Office, South Carolina Department of Archives and History, Columbia, S.C.

(4) A. Lee M. Wiggins, Autobiography of A. Lee M. Wiggins, Limited Edition for Private Distribution (Columbia: R.L. Bryan Company, 1969), passim.; Who's Who in the South . . . 1927, p. 773; Simpson, pp.159, 274; Neely, pp. 153, 222, 231-32.

(5) Simpson, pp. 109-130; Charles W. Coker, The Story of Sonoco Products Company (New York: The Newcomen Society in North America, 1976), pp. 14-15; "James Lide Coker, Jr.," in The National Cyclopaedia of American Biography . . . Volume XXIII (New York: James T. White and Company, 1933), p. 77.

United States Department of the Interior  
National Park Service

National Register of Historic Places  
Continuation Sheet

Section number 7 Page 9

---

(6) Simpson, pp. 144-170, 190-218; "David Robert Coker" in The National Cyclopaedia of American Biography . . . Volume XXIX (New York: James T. White and Company, 1941); National Historic Landmark and National Register of Historic Places Files, South Carolina State Historic Preservation Office, South Carolina Department of Archives and History, Columbia, S.C.

(7) J.L. Coker, Hartsville: Its Early Settlers. The Growth of the Town with Sketches of its Institutions and Enterprises (Darlington: Pee Dee Historical Society, 1911; Reprint Edition, Hartsville: Hartsville Messenger and Press, 1976), p. 36; Simpson, pp. 128-130, 220-21, 223; Neely, pp. 200-201, 203; Patricia J. Wilmot, Hartsville's Eastern Carolina Silver Company (Hartsville: The Hartsville Museum, 1983), passim.

(8) Simpson, pp. 107-08, 130-31, 159; Geddings Hardy Crawford, Editor, Who's Who in South Carolina: A Dictionary of Contemporaries Containing Biographical Notices of Eminent Men of South Carolina (Columbia: McCaw of Columbia, 1921), p. 103; Who's Who in the South . . . 1927, pp. 435-36.

(9) Neely, p. 258; South Carolina Statewide Survey Files, South Carolina State Historic Preservation Office, South Carolina Department of Archives and History, Columbia, S.C.

(10) Yates Snowden, Editor, History of South Carolina, Volume IV (Chicago and New York: The Lewis Publishing Company, 1920), p. 111; Neely, p. 231; Wiggins, p. 84.

(11) South Carolina Statewide Survey Files, South Carolina State Historic Preservation Office, South Carolina Department of Archives and History, Columbia, S.C.

(12) Neely, p. 225.

(13) Ibid., p. 151; South Carolina Statewide Survey Files, South Carolina State Historic Preservation Office, South Carolina Department of Archives and History, Columbia, S.C.

(14) Neely, pp. 27, 65; South Carolina Statewide Survey Files, South Carolina State Historic Preservation Office, South Carolina Department of Archives and History, Columbia, S.C.

(15) Neely, pp. 25-26.

**United States Department of the Interior**  
**National Park Service**

# **National Register of Historic Places**

## **Continuation Sheet**

**Section number**   8   **Page**   2  

---

Architect/Builder(s):

Stout, Penrose  
W.J. Wilkins and Company  
Irvin, Willis

United States Department of the Interior  
National Park Service

National Register of Historic Places  
Continuation Sheet

PHOTOGRAPHS

Section number \_\_\_\_\_ Page 1

---

Name of property: East Home Avenue Historic District  
(Historic Resources of Hartsville  
multiple property submission)

Location of property: Hartsville, South Carolina

Location of negative: South Carolina Department of Archives and History

1. First Baptist Church, 104 East Home Avenue  
Staff, SC Dept. of Archives & History  
September 1989
2. First Baptist Church Family Life Center, 104 East Home Avenue  
(non-contributing)  
Staff, SC Dept. of Archives & History  
May 1990
3. John L. Hart House, 100 Block East Home Avenue  
(individually listed in 1983)  
Staff, SC Dept. of Archives & History  
December 1982
4. R.J. Fletcher House, 107 East Home Avenue  
Staff, SC Dept. of Archives & History  
May 1990
5. Dr. George J. Wilds House, 114 East Home Avenue  
Staff, SC Dept. of Archives & History  
September 1989
6. 115 East Home Avenue (non-contributing)  
Staff, SC Dept. of Archives & History  
September 1989
7. 100 Block East Home Avenue  
Staff, SC Dept. of Archives & History  
May 1990
8. First Baptist Church Parsonage, 122 East Home Avenue  
(non-contributing)  
Staff, SC Dept. of Archives & History  
September 1989

United States Department of the Interior  
National Park Service

National Register of Historic Places  
Continuation Sheet

Section number \_\_\_\_\_ Page <sup>PHOTOGRAPHS</sup> 2

---

9. 123 East Home Avenue  
Staff, SC Dept. of Archives & History  
September 1989
10. A.L.M. Wiggins House, 127 East Home Avenue  
Staff, SC Dept. of Archives & History  
November 1989
11. James L. Coker, Jr., House, 210 East Home Avenue  
Staff, SC Dept. of Archives & History  
November 1989
12. David R. Coker House, 213 East Home Avenue  
Staff, SC Dept. of Archives & History  
May 1990
13. 222 East Home Avenue  
Staff, SC Dept. of Archives & History  
September 1989
14. Walter F. Smith House, 303 East Home Avenue  
Staff, SC Dept. of Archives & History  
May 1990
15. Joseph J. Lawton House, 306 East Home Avenue  
Staff, SC Dept. of Archives & History  
September 1989
16. Joseph J. Lawton House, 306 East Home Avenue  
Entry Detail  
Staff, SC Dept. of Archives & History  
September 1989
17. Fitchett House, 314 East Home Avenue  
(non-contributing)  
Staff, SC Dept. of Archives & History  
September 1989
18. J.S. White House, 404 East Home Avenue  
Staff, SC Dept. of Archives & History  
November 1989

United States Department of the Interior  
National Park Service

National Register of Historic Places  
Continuation Sheet

PHOTOGRAPHS

Section number \_\_\_\_\_ Page 3

---

19. Leonce Vaughan House, 408 East Home Avenue  
Staff, SC Dept. of Archives & History  
November 1989
20. 414 East Home Avenue  
Staff, SC Dept. of Archives & History  
November 1989
21. 506 East Home Avenue  
Staff, SC Dept. of Archives & History  
November 1989
22. 511 East Home Avenue  
Staff, SC Dept. of Archives & History  
November 1989
23. 512 East Home Avenue  
Staff, SC Dept. of Archives & History  
September 1989
24. 519 East Home Avenue  
Staff, SC Dept. of Archives & History  
November 1989
25. Kalber House, 523 East Home Avenue  
Staff, SC Dept. of Archives & History  
November 1989
26. Apartment Complex, 500 Block East Home Avenue  
(non-contributing)  
Staff, SC Dept. of Archives & History  
May 1990
27. 531 East Home Avenue  
Staff, SC Dept. of Archives & History  
September 1989
28. 601 East Home Avenue  
Staff, SC Dept. of Archives & History  
November 1989
29. Thornwell Elementary School, 604 East Home Avenue  
Staff, SC Dept. of Archives & History  
September 1989



**United States Department of the Interior  
National Park Service**

**National Register of Historic Places  
Continuation Sheet**

PHOTOGRAPHS

Section number \_\_\_\_\_ Page 4

---

30. Hartsville Public School, 606 East Home Avenue  
Staff, SC Dept. of Archives & History  
September 1989

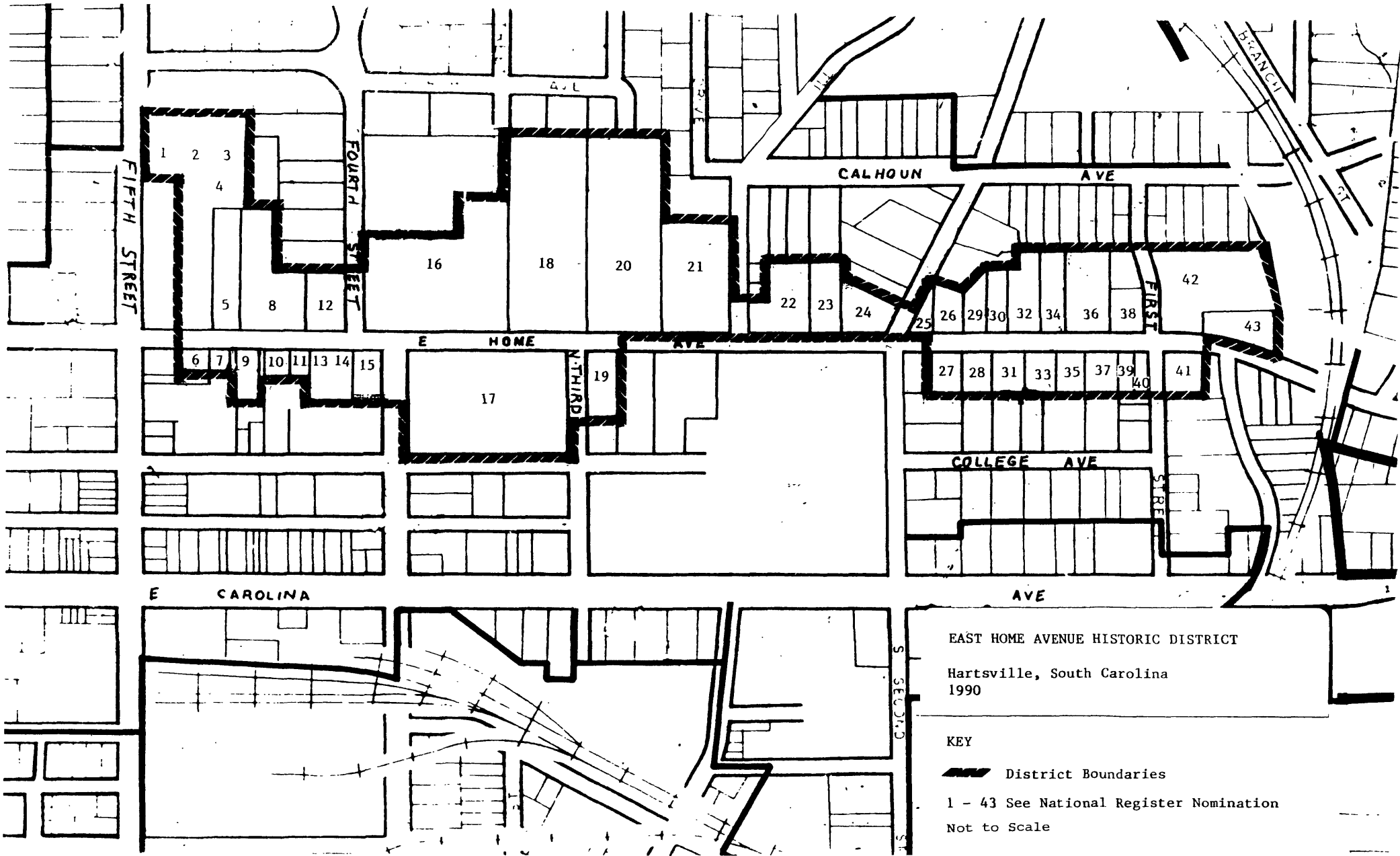

EAST HOME AVENUE HISTORIC DISTRICT

Hartsville, South Carolina  
1990

KEY

 District Boundaries

1 - 43 See National Register Nomination

Not to Scale

United States Department of the Interior  
National Park Service

# National Register of Historic Places Continuation Sheet

Section number \_\_\_\_\_ Page \_\_\_\_\_

### SUPPLEMENTARY LISTING RECORD

NRIS Reference Number: 91000475

Date Listed: 5/3/91

East Home Avenue H. D.  
Property Name

Darlington  
County

SOUTH CAROLINA  
State

Hartsville MPS  
Multiple Name

-----  
This property is listed in the National Register of Historic Places in accordance with the attached nomination documentation subject to the following exceptions, exclusions, or amendments, notwithstanding the National Park Service certification included in the nomination documentation.

Patrick Andrus  
Signature of the Keeper

7/8/91  
Date of Action

=====  
**Amended Items in Nomination:**

Section No. 3

This nomination is amended to show 52 contributing buildings (not including the one building already listed in the National Register), 1 contributing site (the First Baptist Church Cemetary), and 7 non-contributing buildings.

This amendment was confirmed by phone with the South Carolina SHPO (7/2/91).

**DISTRIBUTION:**

- National Register property file
- Nominating Authority (without nomination attachment)