

United States Department of the Interior
National Park Service

National Register of Historic Places
Inventory—Nomination Form

For NPS use only
received Mar 20 1983
date entered

See instructions in How to Complete National Register Forms
Type all entries—complete applicable sections

1. Name

historic Woodlands

and/or common Woodlands Historic District

2. Location

Roughly bounded by Main^{and} High Sts, Ashland
and Woodland Aves.

street & number See number 721 n/a not for publication

city, town Lexington n/a vicinity of congressional district

state Kentucky code 021 county Fayette code

3. Classification

Category	Ownership	Status	Present Use
<input checked="" type="checkbox"/> district	<input type="checkbox"/> public	<input checked="" type="checkbox"/> occupied	<input type="checkbox"/> agriculture
<input checked="" type="checkbox"/> 222 building(s)	<input type="checkbox"/> private	<input type="checkbox"/> unoccupied	<input checked="" type="checkbox"/> commercial
<input type="checkbox"/> structure	<input checked="" type="checkbox"/> both	<input type="checkbox"/> work in progress	<input type="checkbox"/> educational
<input type="checkbox"/> site	Public Acquisition	Accessible	<input type="checkbox"/> entertainment
<input type="checkbox"/> object	<input checked="" type="checkbox"/> n/a in process	<input checked="" type="checkbox"/> yes: restricted	<input type="checkbox"/> government
	<input type="checkbox"/> n/a being considered	<input type="checkbox"/> yes: unrestricted	<input type="checkbox"/> industrial
		<input type="checkbox"/> no	<input type="checkbox"/> military
			<input type="checkbox"/> museum
			<input checked="" type="checkbox"/> park
			<input checked="" type="checkbox"/> private residence
			<input checked="" type="checkbox"/> religious
			<input type="checkbox"/> scientific
			<input type="checkbox"/> transportation
			<input type="checkbox"/> other:

4. Owner of Property

name Multiple Owners

street & number

city, town _____ vicinity of _____ state

5. Location of Legal Description

courthouse, registry of deeds, etc. Fayette County Courthouse

street & number 251 West Main Street

city, town Lexington state Kentucky

6. Representation in Existing Surveys

title Kentucky Historic Resources Inventory has this property been determined eligible? ___ yes no

date 1981 ___ federal state ___ county ___ local

depository for survey records Kentucky Heritage Council

city, town Frankfort state Kentucky

7. Description

Condition		Check one	Check one
<input checked="" type="checkbox"/> excellent	<input type="checkbox"/> deteriorated	<input checked="" type="checkbox"/> unaltered	<input checked="" type="checkbox"/> original site
<input checked="" type="checkbox"/> good	<input type="checkbox"/> ruins	<input checked="" type="checkbox"/> altered	<input checked="" type="checkbox"/> moved date 1883, moved between 1907 and 1934
<input checked="" type="checkbox"/> fair	<input type="checkbox"/> unexposed		720 Central Avenue

Describe the present and original (if known) physical appearance

The Woodlands Historic District, with 222 contributing buildings, consists primarily of residential structures, the majority of which are still residential in use with some professional and commercial use as well. The boundaries of the district are roughly the rear property lines of houses on the west side of Woodland Avenue, the rear property lines of buildings facing Main Street, the rear property lines of houses on the east side of Ashland Avenue and the rear property lines of houses on the south side of East High Street. The neighborhood is at the eastern edge of the commercial downtown with Woodland Park occupying a central portion of the district. Houses are set back about the same distance from the streets with the area having a large number of trees. Streets are relatively wide with Park Avenue being exceptionally so, it having been the streetcar route to Woodland Park. Development of the farm "Woodlands" began in 1884 with the Woodland Park Association subdividing the property. The majority of the houses are late nineteenth and early twentieth century, the area having developed rapidly as the city grew eastward. Houses in the area are both brick and frame and reflect all the styles of the period. The majority of the houses are 2 or 2½ story with about one-third being 1½ story cottages. The district includes a variety of architectural styles including Italianate, Eastlake, Queen Anne, late Richardsonian, Colonial Revival, Tudor Revival, Dutch Colonial Revival, Arts and Crafts and Bungalowoid. Many of the structures reflect combinations of styles, typical of the period. As well as residential buildings there are four churches in the district, all built in the Colonial Revival style (photos 23, 24), and one commercial building, 290 Clay Avenue, also in the Colonial Revival style. A full listing of the buildings in the district, their style and approximate date follows after this summary. Some of the more important examples of the styles represented include: 114 Woodland (photo 1), a circa 1890, 2½ story brick, late Italianate house with Gothic and Eastlake characteristics as well. This house is attributed to the local architect-builder John McMurtry, who designed a number of important buildings in the Lexington area. Other Italianate buildings include 136 Park Avenue (photo 2), a 2½ story frame, circa 1898 with paired brackets and pedimented hoodmolds and Eastlake porch details intact. Other houses with these characteristics are scattered through the district including numbers 710 and 720 Central Avenue (photo 3), 310 is an Eastlake 2½ story frame house with handsome Eastlake lintels, fishscale shingle and peak trim in gable end intact. 720 Central, built by one of the developers of the area, John E. Keller, in 1884, is a handsome Stick style house with its fishscale shingle and decorative boards applied in the "half timber" manner. The house at 244 South Ashland is a brick Eastlake building with bold geometric "cross-bow" in the apex of the gable end, as well as handsome urn-shaped chimneys.

The influence of the Queen Anne style is seen throughout the district. An unusual example is the George Land house at 147 Park Avenue (photo 4). This charming house is an 1½ story brick and shingle with a fine porch highlighted by a "Palladianized entrance arch on coupled Indianized...square colonettes," according to architectural historian Clay Lancaster. The corner of the porch is formed by a circular gazebo with lattice in the spandrels of its arches, topped by a "drum" surfaced with fishscale shingle, topped by a "reverse-curve dome." Other Shingle/Queen Anne houses included 147 Kentucky, probably designed by its first occupant, an architect, F. Paul Anderson. Its neighbors at 151 and 155 Kentucky Avenue (photo 5) also utilize shingle in their construction. A cottage in the Queen Anne style is at 152 Woodland Avenue and its combines Colonial Revival elements as well in its front porch.

Some of the finest houses in the district are late Richardsonian. 298 South Ashland is brick, set on a high basement, on the northeast corner of Ashland and High. The house dominates its corner location and is very much intact. One more typical of those found in

(continued)

8. Significance

Period	Areas of Significance—Check and justify below			
<input type="checkbox"/> prehistoric	<input type="checkbox"/> archeology-prehistoric	<input checked="" type="checkbox"/> community planning	<input type="checkbox"/> landscape architecture	<input type="checkbox"/> religion
<input type="checkbox"/> 1400-1499	<input type="checkbox"/> archeology-historic	<input type="checkbox"/> conservation	<input type="checkbox"/> law	<input type="checkbox"/> science
<input type="checkbox"/> 1500-1599	<input type="checkbox"/> agriculture	<input type="checkbox"/> economics	<input type="checkbox"/> literature	<input type="checkbox"/> sculpture
<input type="checkbox"/> 1600-1699	<input checked="" type="checkbox"/> architecture	<input type="checkbox"/> education	<input type="checkbox"/> military	<input type="checkbox"/> social/humanitarian
<input type="checkbox"/> 1700-1799	<input type="checkbox"/> art	<input type="checkbox"/> engineering	<input type="checkbox"/> music	<input type="checkbox"/> theater
<input checked="" type="checkbox"/> 1800-1899	<input type="checkbox"/> commerce	<input type="checkbox"/> exploration/settlement	<input type="checkbox"/> philosophy	<input type="checkbox"/> transportation
<input checked="" type="checkbox"/> 1900-	<input type="checkbox"/> communications	<input type="checkbox"/> industry	<input type="checkbox"/> politics/government	<input type="checkbox"/> other (specify)
		<input type="checkbox"/> invention		

Specific dates

Builder/Architect

Statement of Significance (in one paragraph)

The Woodlands Historic District is a primarily residential neighborhood, south of Main Street, just southeast of the commercial downtown area, that was platted in 1884 and developed in the late nineteenth and early twentieth centuries. The houses in the area consist of a wide range of architectural styles including Italianate, Eastlake, Queen Anne, late Richardsonian, Colonial Revival, Tudor Revival, Dutch Colonial Revival, Arts and Crafts and Bungalowoid. The majority of the houses are 2½ story, brick residences with a large number of 1½ story cottages. The area was lived in by middle to upper middle class Lexingtonians, with bankers, merchants, doctors, attorneys, horsemen and general contractors being some of the early residents. Some of the known architects whose work is to be found in the district include: John McMurtry, Frank L. Smith, H.A. Churchill, F. Paul Anderson and Obediah Bass, all of whom worked in the Lexington area. Some of the known contractors for the buildings include Frank Corbin, Albert Howard, John McMurtry, Combs Lumber Company and the Hendricks Brothers. The area includes Woodland Park, the site of political rallies, chautauqua meetings and other gatherings, since the 1870's. Trees abound in the area, not only in the park, but on the streets and in yards as well. The district is a good example of a late nineteenth and early twentieth century residential neighborhood.

* * * * *

The area that forms the Woodlands Historic District consists of land that was part of a large farm known as "Woodlands". This land originally belonged to James Trotter, who owned over 400 acres here from 1794 until his death in the 1820's. James Trotter was a prominent citizen of Lexington who came from Virginia in the 1780's. Colonel Trotter died in August 1825, his wife Margaret having died in 1816. The Trotter residence, a Federal house with four octagonal flankers, added in the 1830's, stood in what is now Woodland Park, where the swimming pool is now located. The house was demolished about 1900. In the 1830's the property known as Woodlands was owned by Colonel James Erwin and his wife Ann, a daughter of Henry Clay. James Erwin was from New Orleans and owned considerable property there as well as in Lexington. In the 1850's the property was sold to John B. Tilford, who sold the property to John B. Bowman, president of Kentucky University (now University of Kentucky). Bowman and his wife sold the property to Kentucky University in 1869 and the land was used by the Agricultural and Mechanical College. In 1882, Kentucky University sold Woodlands to the Woodland Park Association, which had been formed to develop property being "that tract of land known as Woodlands between Richmond and Lexington Turnpike Road and Tates Creek Turnpike Road, partly within and partly without the city of Lexington and having 110 acres. John E. Keller, the president of Woodland Park Association was a real estate developer and president of Red Circle Pill Company. The plat of the subdivision was recorded in the Fayette County Courthouse in 1884 and shows the layout out of streets and division of lots. In 1885, a plat showing a "re-subdivision" of part of the area was recorded. The subdivision was bounded by East Main on the north, East High on the south, the rear property lines of lots on the west side of Woodland Avenue and the rear property lines of the lots on the east side of Ashland Avenue. The Woodland Park Association sold the lots, some in parcels to other developers and others one lot at a time.

The south side of East High Street was developed in several different tracts, all in approximately the same period. The 500 and 600 blocks of East High Street on the south side between Kentucky and Clay Avenues were developed as part of the Chautauqua Woods addition,

9. Major Bibliographical References

See continuation sheet.

10. Geographical Data

Acreeage of nominated property 80.28

Quadrangle name Lexington east

Quadrangle scale 1:24,000

UMT References

A	1 6	7 2 0 8 4 0	4 2 1 2 4 3 5
	Zone	Easting	Northing

B	1 6	7 2 0 3 4 0	4 2 1 1 9 5 0
	Zone	Easting	Northing

C	1 6	7 2 0 2 0 0	4 2 1 2 0 4 0
	Zone	Easting	Northing

D	1 6	7 2 0 0 2 0	4 2 1 2 5 2 0
	Zone	Easting	Northing

E	1 6	7 2 0 0 0 0	4 2 1 2 7 2 0
	Zone	Easting	Northing

F	1 6	7 2 0 2 9 5	4 2 1 3 0 0 0
	Zone	Easting	Northing

G			
	Zone	Easting	Northing

H			
	Zone	Easting	Northing

Verbal boundary description and justification

See Continuation Sheet

List all states and counties for properties overlapping state or county boundaries

state	n/a	code	n/a	county	n/a	code	n/a
-------	-----	------	-----	--------	-----	------	-----

state	n/a	code	n/a	county	n/a	code	n/a
-------	-----	------	-----	--------	-----	------	-----

11. Form Prepared By

name/title Bettie L. Kerr
Historic Resources Administrator

organization Lexington-Fayette County
Historic Commission

date May 1983

street & number 253 Market Street

telephone 606/255-8312

city or town Lexington

state Kentucky 40508

12. State Historic Preservation Officer Certification

The evaluated significance of this property within the state is:

national state local

As the designated State Historic Preservation Officer for the National Historic Preservation Act of 1966 (Public Law 89-665), I hereby nominate this property for inclusion in the National Register and certify that it has been evaluated according to the criteria and procedures set forth by the National Park Service.

State Historic Preservation Officer signature

Mary Curran Appel

title State Historic Preservation Officer

date July 13, 1983

For NPS use only

I hereby certify that this property is included in the National Register

J. Nelson Byrum
Keeper of the National Register

Entered in
National Register

date 8/18/83

Attest:
Chief of Registration

date

**United States Department of the Interior
National Park Service**

**National Register of Historic Places
Inventory—Nomination Form**

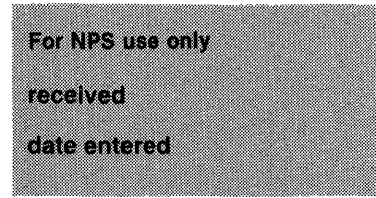

Fayette County, Kentucky
Continuation sheet Woodlands Historic District Item number 7 Page 2

the district is at 132 Woodland Avenue (photo 6). It has rough stone lintels, a triple parlor window with shaped dividers and a handsome porch with colonettes atop piers and turned spindle frieze and balustrade. The house retains its slate roof as well. Number 169 Woodland Avenue is another good example of the Richardsonian/Romanesque houses in the area with its rough stone trim and paneled, urn-shaped chimneys. Its next door neighbor, number 173 Woodland Avenue (photo 7) is much more elaborate with a 3 story octagonal tower and decorative bands in brick and both rough and smooth surface stone. It has lost its original porch. Numbers 136 and 145 Woodland, 518 East Main (photo 8) and 156 Kentucky Avenue (photo 9) are all particularly intact 2½ story, brick, Richardsonian houses with handsome stone trim and other details.

The Colonial Revival style is well represented in the district with large houses as well as cottages scattered throughout that are excellent examples of the period. Of the large 2½ story brick houses numbers 124, 224, 227, 241 and 248 South Ashland are some of the best examples. 241 (photo 10) was designed and built by the Lexington firm of Hendricks Brothers and is very intact. Some of the best cottages are 145 Kentucky Avenue and 225 and 262 South Ashland Avenue. Colonial Revival residences are to be found on each street in the district. (photo 11, 12) All four of the churches in the district, 499, 530, 502 and 637 East High Street are built in the Colonial Revival style as well. Two good examples of the Dutch Colonial Revival style are at 232 and 240 South Ashland, with some on East High Street as well (photo 13).

Tudor Revival buildings in the district include a residence at 290 South Ashland and the Wellington Arms apartment building, 508 East Main (photo 8) which utilizes stone as well as the half timber effect in its design.

There are a number of cottages in the district, reflecting all the previously discussed styles. The majority of these cottages are built in the t-plan style with several pyramidal roof ones as well. (Photos 14, 15, 16, 17)

Arts and Crafts houses, particularly the American Foursquare, are scattered throughout the district (photo 18). There are also several bungalows and bungalow cottages in the area (photo 19).

* * * * *

The following list, by street address, records the approximate date of the house, its style and first city directory listing of occupant.

South Ashland

- 107 - Circa 1918, 2½ story, brick, American Foursquare. 1919 directory - Henry Edmunds Coleman.
- 111 - Circa 1914, 2½ story, tan wire brick, American Foursquare, 1916 - Samuel Carrington Stofer.
- 117 - Circa 1905, 2½ story, brick, Colonial Revival house with a pedimented gable rising above entrance bay. House is very intact and is an excellent example of Colonial Revival style. 1906 directory - N.L. Bosworth.
- 118 - Circa 1912, 2½ story, brick, Colonial Revival with 1 story porch running across the front of the house. 1913 directory - N.F. Ryan.
- 119-21 - Circa 1920, 2 story, wire brick, Arts and Crafts duplex with a monitor at the apex of the roof. 1921 directory - Harry Skuller.
- 124 - Circa 1904, 2 story, brick, Colonial Revival house with center bay projecting very slightly forward and having pedimented gable end. Eyebrow dormers project from slate roof. Built by Combs Lumber Company for John F. Van Deren.
- 125 - Circa 1922, 2 story, wire brick, American Foursquare house. 1923 directory - W.L. Williams.

United States Department of the Interior
National Park ServiceNational Register of Historic Places
Inventory—Nomination Form

Fayette County, Kentucky

Continuation sheet Woodlands Historic District Item number 7

Page 3

For NPS use only

received

date entered

South Ashland (cont.)

- 128 - Circa 1904, 1½ story, brick cottage built by Combs Lumber Company. House is very intact. 1906 directory - Thomas Combs, president of Combs Lumber Company and president of Lexington Telephone Company. Mayor of Lexington from 1904 to 1907.
- 207 - Circa 1928, 2 story, Colonial Revival, brick house with red tile roof. Pedimented porch over center bay has tile roof as well. 1928 directory - James Pryor, manager of Lexington Leaf Department of Liggett and Myers Tobacco Company.
- 210 - Circa 1920, 1 story, brick, Colonial Revival house with pedimented portico with fluted Ionic columns and recessed entry. 1921 directory - J.W. Richardson, vice president of Bank of Commerce.
- 211 - Circa 1918, 2½ story, wire brick, Arts and Crafts house with red tile. House is very intact. 1919 directory - J.W. Beard.
- 212 - Circa 1905, 2½ story, brick, Colonial Revival house with large 1 story porch that runs across the front and continues around on both sides. Entrance bay of porch has pediment with classical coat of arms and vine motif decorating it. 1906 directory - B.D. Berry, prominent Lexington attorney.
- 215 - Circa 1918, 2½ story, stuccoed, Arts and Crafts house with wide eaves with paired large geometric brackets. Porch has segmental arches with deep overhanging eave and brackets. Porch piers are stuccoed like the rest of the house. 1919 directory - C.R. Dulin.
- 217 - Circa 1915, 2½ story, wire brick, Arts and Crafts/Colonial Revival. Eaves have large modillions. Two story porch runs across the front of the house. 1916 directory - Harry Reid.
- 218 - Circa 1885 with after turn of the century changes. 2 story, stuccoed house that was Eastlake and was later altered in the Colonial Revival manner, possibly inspired by the construction of 225 across the street. 1887 directory H.F. Given.
- 219 - Circa 1915, 2½ story, tan wire brick, American Foursquare with hipped roof and hipped roof dormers. 1916 directory - Mrs. E.B. Toph, widow of Abner R. Toph.
- 221 - Circa 1915, 2½ story, brick, Arts and Crafts/Colonial Revival house with parlor bay projecting slightly forward. 1916 directory - J.R. Bush, prominent Lexington attorney.
- 224 - Circa 1915, 2½ story, wire brick, Colonial Revival house with recessed mortar joints. One story porch with massive Tuscan columns runs across the front facade. Doorway has elliptical fan and gable roof dormers project from roof. 1916 directory - S.A. Glass, retail grocery and loan company executive.
- 225 - Circa 1905, 2 story, brick, cottage with very large dormer projecting over the entrance bay. Dormers are shingled and gable ends stuccoed. Porte-cochere on south side of house. 1906 directory - B.F. Van Meter, physician.
- 227 - Circa 1915, 2½ story, stuccoed, Colonial Revival house. One of the largest massed houses on the block, its entrance portico rises 1½ floors and has fluted Corinthian columns with exquisitely detailed capitals. Magnificent elliptical fanlight above entrance door stretches to just beneath the edge of the portico. 1916 directory - Oliver H. Chenault, farmer and horse breeder.
- 232 - Circa 1906, 2 story, Dutch Colonial Revival house that is rough surface brick on the first floor and shingled on the dormer and gable ends of the second. Facade of house is an interesting combination of angles. Porch columns are "bulbous" rough stone ones. Crenolated parapet above projecting parlor bay. 1908 directory - J.B. Hall.
- 237 - Circa 1915, 2 story, brick, Arts and Crafts/Colonial Revival house with projecting 1 story entrance vestibule that is a semi-octagon. 1916 directory - Mrs. S. Elmore, wife of Dr. Louis Elmore.
- 240 - Circa 1898, 2½ story, stone house with gambrel roof. Gable ends of gambrel roof are shingled. 1898 directory - Albert Howard. Howard was a contractor in Lexington.

United States Department of the Interior
National Park ServiceNational Register of Historic Places
Inventory—Nomination Form

Fayette County, Kentucky

Continuation sheet Woodlands Historic District Item number 7

Page 4

For NPS use only

received

date entered

- 241 - Circa 1904, 2 $\frac{1}{2}$ story, buff brick, Colonial Revival house with some late Richardsonian characteristics. Porch covers entrance bay and has balustrade around its top forming a second floor porch. A "widow's walk" is on the top of the house and a porte-cochere is on the north side, off of the bay that contains the stairwell. Both the exterior and the interior are very intact, with the original floor plans on record. The house was designed and built by Hendricks Brothers of Lexington. William David Watts had the house constructed in 1904.
- 244 - Circa 1890, 2 $\frac{1}{2}$ story, brick, stripped Eastlake house with gable end of parlor bay facing the street. The apex trim in this gable end is a bold, geometric "cross-bow". Hoodmolds are on the second floor but have been removed from the first, probably when Colonial Revival porch put on. 1895 directory - R. Prewitt.
- 247 - Circa 1896, 2 story, brick, late Italianate/Colonial Revival house with paired brackets beneath cornice. Windows are in pairs and triples and have segmental arch above them. 1898 directory - Mrs. Elizabeth V. Logan.
- 248 - Circa 1906, 2 $\frac{1}{2}$ story, brick, Colonial Revival house with center bay rising to gabled dormer whose facade is flush with that of the main house, creating a very vertical appearance. 1 story porch with pedimented center bay runs across the front of the house. 1911 directory - J.S. Owsley.
- 251 - Circa 1912, 2 $\frac{1}{2}$ story, brick house, red brick on the first floor and tan on the second. The Prairie style house was designed by Frank Bedford, Lexington architect, and built by Hendricks, Moore and Company. 1915 directory - C.L. Foster.
- 254 - Circa 1886, 2 story, frame, Eastlake truncated t-plan house with handsome lintels. 1887 directory - Harry B. Reed, horse trainer.
- 255 - Circa 1893, 2 $\frac{1}{2}$ story, brick, Richardsonian/Queen Anne house which is very intact. 1893 directory - Tolbert W. Berkley.
- 258 - Circa 1920, 1 $\frac{1}{2}$ story, brick bungalow with porch that stretches across 2 bays and wraps around the northwest corner of the house in a rounded curve. Red tile roof, complete with peak knobs, is intact. Dormer roof curves in something of an "eyebrow" fashion. 1921 directory - Simeon Weil, farmer and extensive land owner.
- 259 - Circa 1895, 2 story, brick, Queen Anne house with 1 story porch that wraps around the northeast corner of the house and is pedimented in the center bay. Porch is Colonial Revival replacement. 1895 directory - N.A. Nichols.
- 262 - Circa 1900, 2 story, buff brick with red mortar, Colonial Revival house with green tile roof. A porte-cochere, also with tile roof, is on south side of the house. 1902 directory - James B. Moore.
- 263 - Circa 1938 - built in the yard of 259 to the north this is the most recent house on the street. In keeping with the scale and character of the street, it is a 2 $\frac{1}{2}$ story, small townhouse in the Colonial Revival style.
- 265 - Circa 1915, 2 $\frac{1}{2}$ story, brick Colonial Revival house with gable roof and 3 pedimented dormers. "Keystone" set in the lintels. 1916 directory - Alice Clare, widow of Fulton Clare.
- 270 - Circa 1890, 2 $\frac{1}{2}$ story, brick, Queen Anne/Eastlake house with a series of set backs in facade, created by projecting bays. A large porte-cochere was added to the south side of the house by 1907 when large brackets were put on the house as well, giving it a transitional appearance. 1890 directory - Archibold H. Goodloe, a captain in the U.S. Army.
- 273 - Circa 1893, 2 story, brick, stripped Richardsonian house with large projecting, multi-sided parlor bay. A wrap around porch is on the northeast corner of the house. House is very intact. 1893 directory - Dr. J.Y. Oldham.
- 276 - Circa 1931, 2 story, brick, Colonial Revival house with Georgian Revival broken pediment doorway. House was designed by Lexington architect Warfield Gratz for William Pettit in 1932.

**United States Department of the Interior
National Park Service**

**National Register of Historic Places
Inventory—Nomination Form**

For NPS use only

received

date entered

Woodlands Historic District

Continuation sheet Fayette County, Kentucky

Item number 7

Page 5

- 280 - Circa 1913, 2 story, slick surface brick, Arts and Crafts house. 1916 directory - J.B. Moore
- 281 - Circa 1893, 2½ story, brick stripped Richardsonian house very similar to 273. 1893 directory shows house as vacant.
- 282 - Circa 1900, 1½ story, frame cottage that appears to have an earlier portion as there are foundation differences. 1906 directory - M.L. Rouse.
- 285 - Circa 1925, 2 story, brick, Colonial Revival house with 1 story, 1 bay portico over the entrance bay. 1925 directory - A.E. Hammel.
- 290 - Circa 1915, 2 ½ story, brick on the first floor, stucco in "half timber" manner on second. House is Arts and Crafts/Tudor Revival in style. A monitor is set on the rear side of the peak of the roof. 1916 directory - H.S. Brooker.
- 291 - Circa 1920, 2½ story, stone house in the American Foursquare style. Porte cochere on the north side of the house. 1921 directory - H.S. McGuire.
- 293 - Circa 1905, 2 story, frame house, with projecting parlor bay with gable end toward street, which has been covered with aluminum siding. 1906 directory J.E. Harbaugh.
- 294 - Circa 1920, 2½ story, stuccoed house with green tile roof. Portico has paired Doric columns with triglyphs on the frieze. One story sunporch with extended rafters in the Prairie style is on the northwest corner of the house. 1921 directory - T.J. Cassidy.
- 298 - Circa 1885, 2½ story, brick, Richardsonian house set high on an English basement. Entrance bay has pedimented gable end and curving steps approach the double doors. Brick hood molds are above all windows. Elliptical parlor bay has 3 windows set in the curve. House is very intact. 1888 - R.J. Law, manager of the Lexington Brick Company, whose yard was along both sides of Ashland Avenue at this time.

Central Avenue

- 611-613 - Circa 1913, 2½ story, frame that has been covered with composition siding, Arts and Crafts house. House has undercut porch. 1913 directory - Mrs. B. Williamson. Built as a duplex.
- 614 - Circa 1900, 1½ story, frame, T-plan cottage. 1902 directory - Joseph Chandler and Joseph Heffner.
- 615 - Late 1920's, frame Colonial Revival cottage. 1928 directory - T.E. Rix.
- 618 - Circa 1895, 1½ story, frame, T-plan cottage with fishscale shingle in gable end and porch intact. Roof has been raised in center. 1895 directory - D.S. Rice, who retained the property through the 1950's.
- 622 - Circa 1895, 1 story, frame, modified shotgun cottage. Pedimented Eastlake lintels, paired brackets. Original porch gone. 1895 directory - A. Howard, contractor, who built other houses in the area.
- 631 - Circa 1905, 1½ story, frame hipped roof cottage with wrap around porch. Fishscale shingle and peak trim remain in gable ends. 1906 directory - D.H. Keller.
- 634 - Circa 1898, 1½ story, T-plan cottage that has had some alteration. Pedimented lintels. 1898 directory - Porter L. Christie.
- 635 - Circa 1908, 1½ story, frame cottage that has been altered with a roof addition. Parlor window retains sunburst motif and apex trim is on fishscale shingled gable end. 1908 directory - J.A. Stevens.
- 637 - Circa 1906, 1½ story, frame, pyramidal roof cottage with wrap around porch. 1906 directory - F.H. Randolph
- 638 - Circa 1890, 1½ story, frame T-plan cottage with modern porch. Lintels are pedimented and incised. 1890 directory - Mrs. M.C. Berry.

United States Department of the Interior
National Park Service

National Register of Historic Places
Inventory—Nomination Form

For NPS use only

received

date entered

Fayette County, Kentucky

Continuation sheet Woodlands Historic District Item number 7

Page 6

- 642 - Circa 1888, 1½ story, frame, Eastlake/Queen Anne Cottage. Projecting oriel-like parlor window treatment. Dormer, with its fishscale shingled gable end, is recessed in roofline. 1887 directory - Mrs. V. Bullitt.
- 702 - Circa 1898, 1½ story, brick, Neo-Classical cottage with original patterned slate roof. Gable end has "Palladian" inspired window in it. 1908 directory - Willa S. Viley and Jacob Harris.
- 706 - Circa 1906, 1½ story, frame, Queen Anne/Colonial Revival cottage with cornice having large dentils beneath it. House has classic decorative motif above gable end window and large brackets on canted corner. 1906 directory - J.T. Smith.
- 707 - Circa 1902, 1½ story, frame, hipped roof cottage with lacy peak trim in apex of gable end. Wrap around porch. 1906 directory - H.V. Rouse.
- 710 - Circa 1895, 2½ story, frame, Eastlake house with Colonial Revival porch. House is very intact with fishscale shingle and peak trim in all gable ends. Incised lintels and original shuttters. 1898 directory - Wm. M. Faulconer. House remained in Faulconer family until 1983.
- 717 - Circa 1902, 1½ story, frame, pyramidal roof cottage that has been covered with composition siding and has modern porch. 1906 directory - H.H. Lampst.
- 720 - Circa 1883, 2½ story, frame, Stick style house with fishscale shingle on second floor. Band of vertical boards at "belt course" level between first and second floors. Applied boards in the "half timber" style on gable end. Turned post and spindle frieze porch. House moved from further back on lot to present location between 1907 and 1934. Built by John E. Keller, the house is one of the earliest in the area. Keller was one of the developers of the subdivision.
- 721 - Circa 1902, 1½ story, frame cottage with fishscale shingled "tower" filling in what was probably a set back entry. 1902 directory - P.K. Farra.
- 723 - Circa 1906, 1½ story, brick cottage with projecting parlor bay with fishscale shingle and apex trim in the gable intact. 1906 directory - Mrs. Julia Gunn.
- 727 - Circa 1906, 1½ story, brick, hipped roof cottage that is the mate to 723. House is very intact. 1906 directory - P.J. Jaynord.

Clay Avenue

- 110-112 - Circa 1925, 2 story, brick, Arts and Crafts house, with green tile roof. 1 story porch with tile roof runs across the front of the house. 1925 directory - E.J. Meyers, one of the founders of Meyer Brothers store.
- 113 - Circa 1908, 1½ story, frame cottage with pyramidal roof. 1911 directory - W.E. Muncy.
- 114 - Circa 1915, 1½ story, brick, bungalow cottage that has had its front porch filled in (relatively successfully, with brick piers remaining visible.) Cottage retains shingle on gable ends. 1916 directory - Mrs. J.J. Spears.
- 115 - Circa 1890, 1 story, brick, T-plan cottage with segmental arch jackarches. Modern porch. 1895 directory - C. Jordan.
- 116 - Circa 1890, 1 story, frame, T-plan cottage with handsome pedimented and incised lintels. Porch intact. 1890 directory - Edward Erd.
- 119 - Circa 1893, 1 story, frame, T-plan cottage with Eastlake lintels and a particularly elaborate apex trim in gable end of parlor bay. Modern porch. 1893 directory - W.H. Cavins.
- 120 Circa 1898, 1½ story, frame, pyramidal roof cottage that has been resided. Projecting dormer has decorative shaped frames flanking double windows. 1898 directory - Augustus Clark.

**United States Department of the Interior
National Park Service**

**National Register of Historic Places
Inventory—Nomination Form**

For NPS use only

received

date entered

Fayette County, Kentucky

Continuation sheet Woodlands Historic District Item number 7

Page 7

- 121 - Circa 1905, 2 story, frame, Bungalow house with undercut porch with extended rafter ends. The large dormer on the second floor has a shed roof. Large geometric brackets beneath eave on gable ends. 1906 directory - J.S. Bradley.
- 124 - Circa 1900, 1½ story, frame cottage that was originally a T-plan. Has been filled in and gable roof put over all. Projecting bay on north side of house has bullseye corner blocks and incised frames. 1902 directory - George A. Farra.
- 125 - Circa 1893, 2 story, brick, stripped Richardsonian/ Queen Anne house with large multi-sided projecting parlor bay. Gable on parlor bay has elaborate peak trim. 1893 directory - B. Clay.
- 126 - Circa 1900, 1½ story, frame, hipped roof cottage. Original parlor bay projects forward and porch area was filled in soon after construction, making facade straight across. 1902 directory - Mrs. Linda Koster.
- 128 - Circa 1923, 2½ story, wire brick, American Foursquare with green tile roof. Built in yard of 130 Clay Avenue, the 1923 directory - C.S. Vermillion.
- 129 - Circa 1890, 2 story, brick Richardsonian house with Colonial Revival pedimented porch. Almost identical to 135 Clay Avenue. No directory listing until 1906 - C. Bohannon.
- 130 - (also 701 Central Avenue) Circa 1900, 2 story, frame, American Foursquare with two story gallery porch on west side. 1902 directory - William Blanding.
- 131 - Circa 1900, 2½ story, frame Colonial Revival house with standing seam metal roof. Parlor bay projects slightly forward. 1902 directory - William A. Walker.
- 135 - Circa 1890, 2 story, brick Richardsonian house that is almost identical to 129 Clay. 1890 directory - Z.T. Newman.
- 213 - Circa 1890, 1 story, frame, Eastlake/Queen Anne cottage with elaborate wood lintel over the parlor window. Gable ends covered with shingle and have trefoil. 1890 directory - J.E. Rogers.
- 216 - Circa 1905, 1½ story, brick T-plan cottage with slate roof. Colonial Revival details. 1906 directory - W.C. Embry.
- 217 - Circa 1890, 1½ story, frame truncated T-plan cottage. Incised lintels and fish-scale covered gable end. 1890 directory - H.H. Hopson.
- 218 - Circa 1905, 1½ story, frame, T-plan cottage that has been covered with composition siding. 1906 directory - D.T. Henry.
- 220 - Circa 1914, 1½ story, brick, Bungalow style house with extended rafter ends and geometric brackets. Modern porch. 1914 directory - O.C. Flynn.
- 222 - Circa 1914, 1½ story, brick, Bungalow house with shed roof dormer. Windows have segmental arch jackarch. 1914 directory - W.H. Porter.
- 224 - Circa 1914, 1½ story, brick, Colonial Revival cottage with patterned slate roof. Large triple window dormer on front and double window dormer on sides. 1914 directory - J.A. McConathy.
- 236 - Circa 1916, 2½ story, brick, Colonial Revival house with recessed mortar joints. Three single window dormers project from the roof and deep eaves have large flat modillions. 1916 directory - R.T. Bryant.
- 244 - Circa 1912, 2½ story, brick, Arts and Crafts/Colonial Revival house. Almost identical to 248 and 252 Clay Avenue. 1912 directory - Thomas Witt.
- 248 - Circa 1912, 2½ story, brick, Arts and Crafts/Colonial Revival house with hipped roof and double window dormer. 1912 directory - W.T. Cogswell.
- 252 - Circa 1912, 2½ story, brick, Arts and Crafts/Colonial Revival house. Very similar to 244 Clay Avenue, except 252 is a little less intact. 1914 directory - Mrs. M. Crosthwait.
- 242 - Circa 1900, 1½ story, frame, hipped roof cottage that appears to originally have been a T-plan cottage. The house may have suffered a fire as the entire roofline was changed as well, the changes made by 1934. 1911 directory - C.A. Spicer.

United States Department of the Interior
National Park Service

National Register of Historic Places
Inventory—Nomination Form

For NPS use only

received

date entered

Fayette County, Kentucky
Continuation sheet Woodlands Historic District Item number 7

Page 8

(Clay Avenue Continued)

- 256 - Circa 1905, 2 story, frame, late Eastlake/Queen Anne house with decorative blind arch on gable ends. North and south gable ends have "Palladian" inspired window treatment. 1911 directory - T.P. Brown.
- 260 - Circa 1914, 2½ story, brick, American Foursquare with hipped roof dormer. Front porch gone, otherwise intact. 1914 - J.S. Hickey.
- 266 - Circa 1914, 1½ story, brick, Bungalow style house with large shed roof dormer. 1916 directory - C.B. Calvert.
- 268 - Circa 1914, 1½ story, brick house in Bungalow style. Very similar to 266 Clay Avenue. 1916 directory - A.W. Partee.
- 271 - Circa 1918, 1½ story, brick, Bungalow style house with undercut porch on the northeast corner. 1919 directory - E.W. Helen.
- 276 - Circa 1911, 1½ story, frame, Bungalow style house with "kick" or shed roof that continues over porch. Tuscan columns on porch that stretches across the front of the house. 1912 directory - G.A. Farra.
- 280 - Circa 1900, 1½ story, frame, T-plan cottage with handsome Eastlake lintels and fishscale shingle intact. 1902 directory - Massillon Alexander Cassidy, superintendent of public schools.
- 288 - Circa 1900, 1½ story, frame covered with composition siding, T-plan cottage. Eastlake lintels intact. 1902 directory - John Clem.
- 286 - Circa 1900, 1½ story, frame covered with siding, cottage. Undercut porch on the northwest corner of the house. Porch modern. 1902 directory - F.P. Hoover.
- 290 - (703-702 East High) circa 1915, 2 story, brick, Colonial Revival commercial building with canted southwest corner. Three sided oriel on canted corner of second floor.

East High Street

- 499 - Circa 1921, 2 story, brick, Colonial Revival church with tetrastyle portico with Ionic columns. Two story, round arched windows on front facade and sides. Built as Immanuel Baptist Church. Designed by Frank L. Smith, Lexington architect, and built by L.M. Moore. Sunday school addition, also brick, added 1929.
- 530 - Circa 1924, 2 story, brick, Colonial Revival church with portico with Doric columns and entablature topped by a blind-arch pediment. A parapet at the top of the building repeats the arch over the center bay. Cornice, set below the parapet edge, has large modillions. Woodland Christian Church designed by H. A. Churchill, Lexington architect.
- 548 - Circa 1900, 2½ story, brick, stripped Richardsonian/Colonial Revival house with slightly projecting parlor bay. Brick segmental arch hood molds. Colonial Revival wrap-around porch. 1902 directory - Wash Kelly.
- 552 - Circa 1900, 1½ story, frame, hipped roof cottage with projecting parlor bay. Cottage very intact with fishscale shingle in gable end, apex trim and porch with turned posts and frieze. 1902 directory - William H. Meadows.
- 558 - Circa 1905, 1½ story, frame hipped roof cottage with slightly projecting parlor bay, intact except for porch. 1905 directory - P.M. Eggleton.
- 560 - Circa 1905, 1½ story frame, hipped roof cottage that has been covered with siding. Porch is intact. 1908 directory - G.Y. Reynolds.
- 562 - Circa 1920, 1½ story, brick, Bungalow style cottage with low pitched hipped roof. Modern porch supports.
- 598 - Circa 1905, 1½ story, buff brick, Colonial Revival cottage. Shingled gable end curves into a recessed window. 1906 directory - listed, but no occupant.
- 600 - Circa 1915, 1½ story, brick on the first floor and frame second, Dutch Colonial Revival house. Shed roof dormers on either side. Undercut porch has been framed in. Not listed in 1908 directory.

**United States Department of the Interior
National Park Service**

**National Register of Historic Places
Inventory—Nomination Form**

Fayette County, Kentucky

Continuation sheet Woodlands Historic District Item number 7

Page 9

For NPS use only

received

date entered

(East High Street continued)

- 602 - Circa 1906, 1 story, brick, Colonial Revival church. Rather plain facade has two round arched stained glass windows with stone voussoirs. Entrance is on northwest corner of building. Built as Park Avenue Church, building was sold in 1914 when congregation built another building (Park Methodist Church, 637 East High).
- 608 - 2 story, frame (covered with siding) house built in the shape of a cross, with what were corner porches filled in. House not listed in 1908 city directory.
- 610 - Circa 1910, 2½ story, brick, Arts and Crafts/Colonial Revival house that is intact except for the loss of its front porch. City directory listings do not go out this far until after 1908.
- 615 - Circa 1905, 2½ story, brick on the first and frame on the second, Dutch Colonial Revival house. The southwest corner has an undercut porch and an oriel is on the west side of the house. Built by 1907, according to Sanborn map.
- 622 - 1½ story, brick, rectangular house with gable end facing the street, reminiscent of a Homestead house. Large dormers project on either side. A porch has been removed. Not shown on 1907 Sanborn.
- 623 - 2½ story, hipped roof, yellow brick with pedimented center bay, Colonial Revival/Arts and Crafts house. Built on site of cottage that had burned down, as this house had been built by 1934.
- 626 - Circa 1910, 1½ story, brick, Colonial Revival cottage with patterned slate roof. very intact with wrap around porch with Ionic colonettes set on brick piers. Not on 1907 Sanborn.
- 629 - Circa 1908, 1½ story, frame, hipped roof cottage with wrap around porch extending across facade of house. House is very intact. 1908 directory - J.P. Harmon.
- 632 - 1½ story, brick, hipped roof, Colonial Revival cottage with modern porch. Not shown on 1907 Sanborn map.
- 633 - Circa 1906, 2 story, frame house which reflects the Dutch Colonial Revival style. House has hipped roof with large second floor projection, part of which is recessed in the roofline. The roofline at the peak of the house is "hooded". An undercut porch stretches across the facade. 1908 directory - W.P. Parrish.
- 636 - Modified Dutch Colonial Revival house with shingle second floor ending in a raked edge over the frame first floor. Entrance has fan door with sidelights. Pedimented entrance overhang with segmental arched ceiling. Not shown on 1907 Sanborn map.
- 646 - Ca. 1901, 2 story, frame and shingle, Dutch Colonial Revival house. "Palladian" windows set in gable ends on the east and west. Built by Mrs. Abraham Barton Lancaster.
- 656 - 2 story, frame, Dutch Colonial Revival house with shed roof dormers. A triple window oriel forms the parlor bay window. House not shown on 1907 Sanborn map.
- 637 - Circa 1920, 2 story, brick, Colonial Revival church with tetrastyle portico with Doric columns. Pediment of portico has elliptical fan. Built as Park Methodist Church in 1920, the congregation having previously been at 602 East High.
- 702 - 2½ story, brick, American Foursquare with well scaled modern porch. Not shown on 1907 Sanborn map.
- 703-707 - See 190 Clay Avenue.
- 710 - 2½ story, stuccoed, American Foursquare with projecting dormers. Facade of dormer has a parapet with stepped sides and rounded center. Not shown on 1907 Sanborn map.
- 719 - 1 story, frame, T-plan cottage that has been covered with siding. Eastlake window trim remains. Not shown on 1907 Sanborn map.
- 720 - 1½ story, brick, bungalowoid cottage, not shown on 1907 Sanborn map.
- 722 - Circa 1905, 2 story, brick on the first and fishscale shingle on the second floor Dutch Colonial Revival house. 1908 directory - M.L. Rouse.

**United States Department of the Interior
National Park Service**

**National Register of Historic Places
Inventory—Nomination Form**

For NPS use only

received

date entered

Fayette County, Kentucky

Continuation sheet Woodlands Historic District Item number 7

Page 10

(East High Street Continued)

- 726 - Stone veneered, 1½ story, Colonial Revival house with series of gable roofs, giving the house a rather vertical appearance. Not on 1907 Sanborn map.
- 729 - 1½ story, frame bungalow cottage with projecting rafter ends on the single bay porch and gabled dormer, as well as on main roof. Not shown on 1907 Sanborn.
- 732 - Circa 1905, 2½ story, brick, stripped late Richardsonian with slate roof. Parlor bay has gable end facing the street. Lintels are rough stone. Filled in porch, later addition. 1908 directory - A.P. Taylor.

Kentucky Avenue

- 111 - Circa 1887, 1 story, frame cottage with gable end facing the street. The Eastlake porch is very much intact. 1888 directory - W. Rosenfield.
- 113 - Circa 1890, frame, T-plan cottage. 1890 directory - Rev. A.M. Fraser.
- 117 - Circa 1886, 1 story, frame, modified shotgun cottage with trefoil in gable end. 1887 directory - M.R. Cozine.
- 119 - Circa 1886, 1½ story, frame, T-plan cottage with Eastlake pedimented lintels. 1887 directory - Charles Butler.
- 121 - Circa 1885, 1 story, frame, cottage with pedimented lintels, original porch removed and Colonial Revival door installed. 1888 directory - George Sharp.
- 125 - Circa 1887, 1½ story, frame cottage with gable over center bay. Original porch removed and doorway changed. 1888 directory - C.M. Treacy.
- 145 - Circa 1905, 1½ story, brick, Neo-Classical cottage with pyramidal roof with large projecting dormers. Well scaled, with pedimented porch with Ionic columns on brick piers. 1906 directory - V.K. Dodge, pioneer in the manufacture of automobiles and one of the developers of the Lafayette Hotel in Lexington.
- 147 - Circa 1895, 1½ story, frame and shingle, Queen Anne house with undercut porch with arched spandrel. 1895 directory - F. Paul Anderson, who appears to have designed the building as well.
- 150 - Circa 1900, 1½ story, brick cottage that is unusually vertical. 1902 directory - J. Howard Downing.
- 151 - Circa 1900, 2½ story, frame, and shingle house with a center bay that rises to join "pedimented" roof dormer. Half timber "motif" decorates center bay. This unusual house may have been designed also by F. Paul Anderson. 1902 directory - Harry C. Swift.
- 154 - Circa 1900, 1½ story, brick, truncated T-plan cottage with Richardsonian and Eastlake details. Porch is one of the most handsome in the district with elaborate frieze.
- 1906 - C.E. Powell. Builder was probably Frank Corbin, a local builder who also constructed 156 Kentucky Avenue.
- 155 - Circa 1900, 2½ story, frame, Queen Anne/Colonial Revival house with "A-frame" type center gable extending to the northern corner of the house. Entrance off center with a 2 story, 3-sided bay beneath the central gable. 1902 directory - Richard H. Ellett.
- 156 - Circa 1900, 2½ story, brick, late Richardsonian/Romanesque house with slate roof and peak knobs intact. One of the most intact houses in district with elaborate detailing, including a small iron balcony on the second floor, south side. 1902 directory - Frank Corbin, prominent builder in Lexington.
- 171 - Circa 1900, 1½ story, pyramidal roof cottage with decorative bands of rough surface brick as well as stone voussoir over the parlor window. Gable end of porch filled with rough surface brick, overlaid with wood bands of "half-timbering." 1902 directory - William Wilkerson.

United States Department of the Interior
National Park Service

National Register of Historic Places
Inventory—Nomination Form

For NPS use only
received
date entered

Fayette County, Kentucky

Continuation sheet Woodlands Historic District Item number 7

Page 11

(Kentucky Avenue, continued)

- 175 - Circa 1885, 1 story, frame, truncated T-plan cottage with triple sided projecting parlor bay. 1887 directory - J.T. Wilkerson, Sheriff of Fayette County at one time.
- 179 - Circa 1900, 2½ story, frame, Queen Anne/Colonial Revival house with pedimented gable end facing the street. Porch has swags of leafy garlands decorating the fascia. 1902 directory - Charles W. Aitkin.
- 181 - Circa 1900, 2½ story, brick and frame, Neo-Classical/Queen Anne house. May have been a 1 story cottage earlier and had serious alteration about the turn of the century. 1902 - J.W. Porter.
- 185 - 2 story, brick, Colonial Revival four-plex in keeping with the character and scale of the neighborhood.
- 189 - Circa 1912, 2½ story, Arts and Crafts/Colonial Revival house with parlor bay projecting slightly forward. House built on site of earlier one.
- 191 - Circa 1912, 2½ story, brick, Arts and Crafts/Colonial Revival house that appears to have been built as a pair with 189. 1914 directory - W.W. Anderson.
- 193 - Circa 1900, 1½ story, frame, pyramidal roof cottage that has been somewhat altered and a new porch added. 1906 directory - J.R. Smith.

Lafayette Avenue

- 124 - Circa 1900, 1½ story, frame, truncated T-plan cottage with original porch with paneled frieze decorated with "tear drops" across the bottom. Second entrance has been created in parlor bay. 1902 directory - Thomas Woodyard.
- 125 - Circa 1905, 1½ story, brick, T-plan cottage with sunburst relief in parlor window. Modern porch. 1906 directory - J.C. Sheridan.
- 130 - Circa 1900, 1½ story, frame, truncated T-plan cottage with fishscale shingle covered gable end. Frieze on porch intact. 1902 directory - B. Harry Reed.
- 131 - Circa 1905, 1½ story, brick, truncated T-plan cottage with rough surface brick forming the segmental arch over the parlor bay. 1906 directory - R.B. Snyder.
- 135 - Circa 1905, 1½ story, brick, truncated T-plan cottage with rough surface brick forming segmental arch over parlor window and entrance door. Wrap-around porch. 1906 - C.B. Spear.
- 136 - Circa 1894, 2½ story brick, stripped Richardsonian house with projecting parlor bay having gable end facing street. Rough stone lintels on most of facade and brick segmental jackarches on rest of house. 1895 directory - house vacant, 1898 - Lewis H. Ramsey.
- 137 - Circa 1905, 1½ story brick, truncated T-plan Cottage with rough surface brick forming the segmental arch over the parlor bay and entrance door. Wrap-around porch. 1908 directory - C.B. Speer.
- 139 - Circa 1905, 1½ story, brick, truncated T-plan cottage with rough surface brick forming segmental jackarch over parlor window and door. Parlor window has sunburst motif in upper corners. 1906 directory - Alexander Rodas.
- 141 - Circa 1915, 1½ story, brick, cottage that is slightly later than others on the street and varies in style. The house has a gable roof, gable end to the street, with the projecting parlor bay also having a gable roof. Wrap-around porch. Sanborn map shows house by 1920.
- 142 - Circa 1895, 2½ story, brick, stripped Richardsonian houses that is almost identical to 136 Lafayette, except for the parlor window treatment which is a large 1/1 window with fan window above. A rough stone impost course runs above. Modern porch. 1895 directory - vacant. 1898 - J.H. Talbutt.

**United States Department of the Interior
National Park Service**

**National Register of Historic Places
Inventory—Nomination Form**

Fayette County, Kentucky

Continuation sheet Woodlands Historic District Item number 7

Page 12

For NPS use only

received

date entered

East Main Street

- 508 - Circa 1930, 4 story, brick and stone, Tudor Revival apartment building. Center 3 bays covered with stone and each rise to a peaked gable with finial atop each one. Entrance is stone with segmental arch doorway with heraldic lions and shield decorating entablature above. Remainder of building is brick on first 3 floors with parts of third and fourth floor having half-timber motif. This design is carried out on the west side (Woodland Avenue side) of the building as well. Very handsome Tudor Revival building on a prominent corner location. Designed by Obediah Bass, architect and engineer in Lexington and built about 1930.
- 512 - Circa 1885, 1 story, brick, late Italianate hipped roof cottage with Colonial Revival changes. Windows have brick pedimented hood molds and rows of brick corbels are beneath sills. Northeast corner of the house has been filled in, creating a new entrance. Standing seam metal roof. 1887 directory - Henry Schaeffer.
- 518 - Circa 1899, 2½ story, brick, Richardsonian/Romanesque house with entrance bay rising to a third story gable. Parlor window has handsome fan above, articulated by stone band that ends in rams horns. Several window sills have rows of brick corbels beneath. Neo-Classical porch with pediment over entrance with low relief sunburst set in it. Original porte-cochere on the east side of the house. Slate roof intact. 1902 directory - James E. McFarland, who built the house. McFarland was a prominent banker.
- 522 - Circa 1900, 2½ story, brick, Richardsonian/Eastlake house with parlor bay projecting slightly forward. Palladian-inspired window in pedimented gable end. Parlor window has rows of brick corbels beneath. Northwest corner of house canted, has large brackets. Patterned slate roof. One story porch on entrance bay. 1902 directory - Theodore B. Wood.

Park Avenue

- 121 - Circa 1886, 1 story, brick, Italianate cottage with paired brackets on parlor gable end. Brick segmental arch hood molds above windows. 1887 directory - James E. Shryock.
- 122 - Circa 1900, 1½ story, frame, pyramidal roof, Queen Anne/Colonial Revival cottage. Large center dormer with single window dormer flanking it one either side have applied decorative work in their gable end. One story porch over entrance bay. Slightly recessed entry. 1902 directory - Dr. R. Craig Falconer.
- 126 - Circa 1895, 2½ story, frame, late Queen Anne house that has been re-sided. Sunburst decoration remains in the upper corners of parlor window. Modern porch. 1895 directory - George Wieman.
- 127 - Circa 1900, 1 story, frame, truncated T-plan cottage that has had its porch filled in. Fishscale shingle remains on gable end, as does apex trim and the large brackets on the canted corner. 1902 directory - George R. Warren.
- 128 - Circa 1898, 1 story, frame, T-plan cottage with turned spindle frieze on wrap-around porch. 1898 directory - W.T. Brock.
- 132 - Post-1934, 2½ story, wire brick, Arts and Crafts building with standing seam metal roof. Building fits in well with streetscape in both scale and materials.
- 135 - Circa 1900, 1½ story, frame, truncated T-plan cottage. Wrap around porch with turned spindle frieze intact. 1902 directory - Dr. S.L. Helm.
- 136 - Circa 1892, 2 story, frame, late Italianate/Eastlake house, Parlor bay, which projects forward, has chevron pattern boards and paired brackets decorating the gable end. A three sided bay projects from the parlor bay on the first floor. 1893 directory - E.W. Smith, Lexington architect.

**United States Department of the Interior
National Park Service**

**National Register of Historic Places
Inventory—Nomination Form**

For NPS use only

received

date entered

Fayette County, Kentucky

Continuation sheet Woodlands Historic District Item number 7

Page 13

(Park Avenue, continued)

- 140 - Circa 1892, 2 story, frame, late Italianate/Eastlake house that is very similar to 136 Park Avenue. 140 has had porch replaced with a 2 story, Colonial Revival one and some other alterations. 1893 directory - W.A. Hart.
- 141 - Circa 1900, 1½ story, brick, T-plan cottage that is very intact. Handsome wrap around porch has turned spindle frieze and lacy brackets. 1902 directory - Samuel S. Miller.
- 146 - Circa 1900, 1½ story, frame pyramidal roof cottage with fishscale shingle in the gable ends and wrap around porch intact. 1902 directory- Thomas F. Kelly.
- 147 - Circa 1894, 1½ story, brick and shingle Eastlake/Queen Anne cottage that is very intact. House is unique in the district and in the city. The parlor bay angles out to a narrow chimney that rises through the cornice. There are decorative bands of rough surface brick and stone. The focal point of the house is the porch which is a delightful combination of shaped colonettes, arched spandrel, decorated gable end, and round gazebo-like corner with a reverse-curve dome roof atop it. There have been wide dormers added to the house on either side. 1895 directory - George Land.
- 152 - Circa 1890, 1½ story, brick, Queen Anne cottage with highly articulated "Palladian" parlor window. Modern porch. 1893 directory - W. Cook.
- 164 - Circa 1886, 2 story, frame, late Italianate/Eastlake house with chevron panels decorating gable ends. Lacy brackets remain on the canted corners and the pierced frieze is intact. 1888 directory - M. Ambrose.
- 170 - Circa 1890, 2½ story, frame, late Italianate house that has been covered with siding. Pedimented lintels remain on first floor. Modern porch. 1890 directory - Rev. S.J. French.
- 173 - Circa 1886, 1½ story, frame, T-plan cottage. Modern porch. 1888 directory - John Clem.
- 174 - Circa 1890, 2½ story, frame, Eastlake house with pedimented lintels. Modern porch. 1890 directory - Rev. C.F. O'Ney.
- 178 - Circa 1890, 1½ story, frame, T-plan cottage with pedimented lintels. Porch has been replaced. 1890 directory - G.W. Land
- 179 - Circa 1895, 1½ story, brick, truncated T-plan cottage. Rough surface brick over windows and on corners like koins. Porch replaced. 1895 - P.W. Grinstead.
- 183 - Circa 1900, 2½ story, frame, Colonial Revival house with pedimented gable end over projecting parlor bay. Wrap-around porch has paired Ionic colonettes atop stone piers. 1902 directory - Orlando Hanna.
- 187 - Circa 1895, 2½ story, frame, late Italianate house that has been covered with composition siding. Parlor window detail and lintels all intact. 1895 directory - Hez Brown.

Woodland Avenue

- 110 - Circa 1890, 2 story, frame house with projecting parlor bay, been covered with aluminum siding, however retains paired brackets beneath eaves. Eastlake/Colonial Revival style. 1893 city directory - Mary F. Cook.
- 114 - Circa 1890, 2 story, brick house that is a combination of late Italianate, Gothic and Eastlake styles. House is very intact with original turned post porch, paired brackets, brick hood molds and handsome paneled chimneys. Probably designed and built by local architect John McMurtry. 1890 city directory - R.D. Craig. Occupied by members of Totten family around the turn of the century.

United States Department of the Interior
National Park Service

National Register of Historic Places
Inventory—Nomination Form

For NPS use only

received

date entered

Fayette County, Kentucky

Continuation sheet Woodlands Historic District Item number 7

Page 14

(Woodland Avenue, Continued)

- 121-23 - Circa 1919, 2 story, tan brick, Arts and Crafts/American Foursquare built as a duplex. The 1919 city directory - 121 - E.W. Bright and 123 - Embry Allen.
- 122 - Circa 1905, brick, 1½ story, T-plan cottage. 1906 city directory - C.H. Bower.
- 125-27 - Circa 1920, Arts and Crafts, 2½ story, stucco house with pyramidal roof with projecting hipped roof dormer. Two story porch, partially enclosed runs across front of the house. 1921 city directory - W.T. Lafferty.
- 132 - Circa 1893, 2½ story, brick, Richardsonian/Eastlake house with projecting parlor bay. Slate roof and original porch intact. 1893 city directory - W.G. Simpson.
- 135 - Circa 1906, 2½ story, brick, Colonial Revival house with projecting parlor bay. One story Tuscan columned porch stretches across front facade. 1906 city directory - Mrs. E. Kelly.
- 136 - Circa 1890, 2½ story, brick, Eastlake/Richardsonian house with triple parlor window with shaped dividers and rows of brick corbels beneath sill. Rough stone lintels. 1890 city directory - George Clark, who was a contractor. Originally from Ireland, he was the builder of the present Fayette County Courthouse.
- 138 - Circa 1910, 2½ story, brick, Arts and Crafts/Colonial Revival house, nicely intact. 1911 city directory - Elizabeth S. Kelly.
- 143 - Circa 1910, 1½ story, brick t-plan cottage with gable ends having a blind-arch decorating them. 1911 city directory Lewis A. and Susie Ruckno.
- 144 - Circa 1900, T-plan cottage that has been covered with aluminum siding. 1902 city directory - Era G. Wilhelm.
- 145 - Circa 1895, 2½ story, brick, late Richardsonian house that is very intact. Impost course of rough stone adorns triple parlor window. Brick corbels in decorative pattern flank upstairs windows on parlor bay. House retains slate roof and very tall corbeled chimneys. 1895 city directory - J.W. Throckmorton.
- 147 - Circa 1911, 2½ story, brick, Arts and Crafts/Colonial Revival with projecting parlor bay. 1 story porch stretches across facade. 1911 directory - W.G. Kerr.
- 148 - Circa 1893, 2½ story, brick, Richardsonian/Queen Anne with parlor bay projecting slightly forward. Particularly handsome parlor window. 1893 directory - F. Pfieffer.
- 149 - Circa 1910, Arts and Crafts, 2½ story brick that has had its porch removed. 1911 directory - W.C. Greening.
- 152 - Circa 1900, 1½ story, frame, Queen Anne/Colonial Revival cottage with "diamond" shingles covering the large dormer with modified gambrel roof. A large Palladian-type window is in the gable end. Porch has bowed center projecting over the steps. 1902 directory - W.H. Warren.
- 154 - Circa 1893, 2½ story, late Richardsonian/Queen Anne, brick on the first floor and shingle on the second. Very intact. 1893 directory - F.E. Johns, a leading photographer in Lexington from the 1870's on.
- 155 - Circa 1900, 2½ story, brick, stripped Richardsonian house intact except for the front porch, which is gone. 1902 directory - J.W. Throckmorton.
- 157 - Circa 1888, 2½ story, stuccoed, late Richardsonian with Arts and Crafts porch. 1888 directory - O.F. Jackson.
- 158 - Circa 1902 cottage that has been remodeled in the Colonial style, probably originally having combined frame and shingle. 1902 directory - Edward Farley.
- 160 and 164 - Circa 1893 built as a pair of late Richardsonian/Eastlake 2½ story brick houses. Both intact except for 164 having lost its original turned post and spindle porch, which 160 retains. 1893 directory - 160 - James Jones, 164 - W.F. White.
- 161 - Circa 1893, 2½ story, brick, late Richardsonian house with projecting parlor bay. House retains standing seam metal roof. 1893 directory - R. Smith. In 1898 lived in by John E. Keller, one of the developers of Woodlands area (see also 720 Central Avenue).

**United States Department of the Interior
National Park Service**

**National Register of Historic Places
Inventory—Nomination Form**

Fayette County, Kentucky

Continuation sheet Woodlands Historic District Item number 7

Page 15

For NPS use only

received

date entered

(Woodland Avenue, continued)

- 165 - Circa 1900, Colonial Revival/Queen Anne, 2½ story, frame house with shingle. 1902 directory - John F. Van Deren, of Van Deren Hardware store.
- 168 - Circa 1900, 1½ story, frame, T-plan cottage that has been re-sided and had other alterations, yet retains its scale. 1902 directory - Mrs. Somerville Davis.
- 169 - Circa 1893, 2½ story, brick, Richardsonian/Romanesque that is very intact and has particularly nice paneled and corbeled chimneys. 1893 directory - W.B. Nelson, hemp and seed merchant.
- 172 - Circa 1900, 1½ story, frame, Queen Anne Cottage with shingle on gable ends and apex trim in gables intact. Porch decorated with applied "sunburst." 1902 directory - Edward Watkins.
- 173 - Circa 1893, 2½ story, brick, Richardsonian/Queen Anne house with 3 story, octagonal tower on the southwest corner. Richly decorated with bands of stone and brick. Original porch gone. 1893 Directory - W.J. Houlihan.
- 176 - Circa 1893, 1 story, brick, T-plan cottage. 1893 directory - O.R. King.
- 182 - Circa 1910, 2½ story, brick, American Foursquare with double window dormers projecting on all four sides. 1911 directory - Kenneth Walker.

**United States Department of the Interior
National Park Service**

**National Register of Historic Places
Inventory—Nomination Form**

Fayette County, Kentucky

Continuation sheet Woodlands Historic District

Item number 7

Page 16

For NPS use only

received

date entered

List of Intrusions

- 118 Woodland Avenue. Parking lot.
- 124 Woodland Avenue. Modern duplex.
- 137 Woodland Avenue. Modern apartment.
- 180 Woodland Avenue. Modern apartment.
- 109 Kentucky Avenue. Cottage covered with perma stone, lost architectural integrity.
- 159-69 Kentucky Avenue. Modern townhouses.
- 184 Park Avenue. Modern apartment.
- 143 Lafayette Avenue. Cottage covered with perma stone, lost architectural integrity.
- 203-211 Clay Avenue. Modern townhouses.
- 218 Clay Avenue. Cottage altered, lost architectural integrity.
- 270-272 Clay Avenue. Parking lot.
- 275 Clay Avenue. Parking lot.
- Swimming pool and park building in Woodland Park.
- 511 Central Avenue. Post 1934 house covered with perma stone.
- 630 Central Avenue. Modern apartment.
- 646-658 Central Avenue. Modern townhouses.
- 715 Central Avenue. Cottage covered with stone and Colonial Revivalized, lost architectural integrity.

RECEIVED

MAY 26 1983

**KY. HERITAGE
COMMISSION**

UNITED STATES DEPARTMENT OF THE INTERIOR
NATIONAL PARK SERVICE

**NATIONAL REGISTER OF HISTORIC PLACES
INVENTORY -- NOMINATION FORM**

FOR NPS USE ONLY

RECEIVED

DATE ENTERED

Fayette County, Kentucky
Woodlands Historic

CONTINUATION SHEET District

ITEM NUMBER 8 PAGE 2

opened at the turn of the century. The land was part of the Trotter farm in the nineteenth century and by the mid-nineteenth century the property was owned by O.P. Alford who had in his residence, Elley Villa, at what is now 320 Linden Walk (listed on the National Register, January 9, 1978). Alford lost his property in a mortgage foreclosure in 1897. The Chautauqua Woods addition was developed by C.K. Oldham and P.K. Finn in 1901, the plat of the addition having been recorded in 1907. The area developed quickly, part of a major opening up of the east end. A newspaper article in 1901, "Big Sale of Lots" states that over 150 lots were sold at "C.K. Oldham's sale of lots" in Chautauqua Woods. Charles K. Oldham was in the real estate business in Lexington for over 45 years, as well as dealing in fire insurance and being an auctioneer. He died in 1944, age 74. The south side of the 700 block of East High Street was platted (along with more area to the south) by L.B. Shouse in 1913. Shouse was president of the Lexington Wholesale Business Company, as well as organizer and president of the Lafayette Hotel. He had "extensive business in real estate after 1905."

For the occupant of the buildings at the time of their first city directory listings see inventory by street address in description - number 7.

**United States Department of the Interior
National Park Service**

**National Register of Historic Places
Inventory—Nomination Form**

Fayette County, Kentucky

Continuation sheet Woodlands Historic District Item number 9

Page 2

For NPS use only

received

date entered

MAJOR BIBLIOGRAPHICAL REFERENCES

- Coleman, J. Winston, Jr. The Squire's Sketches of Lexington. Lexington: The Henry Clay Press, 1972.
- Dunn, C. Frank. "Old Houses of Lexington, Kentucky." Unpublished Manuscript, Kentucky Historical Society, Frankfort, 1930-50.
- Fayette County Deeds, Wills and Plat Books
- Kerr, Judge Charles, ed. History of Kentucky (5 volumes) Chicago and New York: The American Historical Society, 1922.
- Lancaster, Clay. Ante Bellum Houses of the Bluegrass. Lexington: University of Kentucky Press, 1961.
- _____. Vestiges of the Venerable City. Lexington: Lexington-Fayette County Historic Commission, 1978.
- Leavy, William A. "A Memoir of Lexington and Its Vicinity." 1873, Published in Register, Kentucky Historical Society, Volumes 40, 41 and 42.
- Lexington Maps and Views
- Lexington Newspapers
- Perrin, William Henry, ed. History of Fayette County, Kentucky. Chicago: O.L. Baskin, and Co., 1882.
- Sanborn Insurance Maps (from University of Kentucky).

**United States Department of the Interior
National Park Service**

**National Register of Historic Places
Inventory—Nomination Form**

For NPS use only

received

date entered

Continuation sheet Woodlands Historic
District, Fayette Co., KY Item number 10

Page 2

VERBAL BOUNDARY DESCRIPTION AND JUSTIFICATION:

The boundary begins at a point (A) (which is 250 feet southeast of the southeast corner of Ashland and Main) and proceeds southeast along a line 2175 feet to a point (B), thence southwest along a line 500 feet to a point (C), thence northwest 1525 feet along a line to a point (D), thence northwest along a line 875 feet to a point (E) thence northwest along a line 800 feet to a point (F), thence northeast along a line 550 feet to a point (G), thence southeast along a line parallel with Main Street, 2300 feet to the point or origin, thereby incorporating the nominated neighborhood.

LEXINGTON

KENTUCKY

John Latham,

Publisher,

New York.

Drawn by A. I. Totten, C. E.

1887.

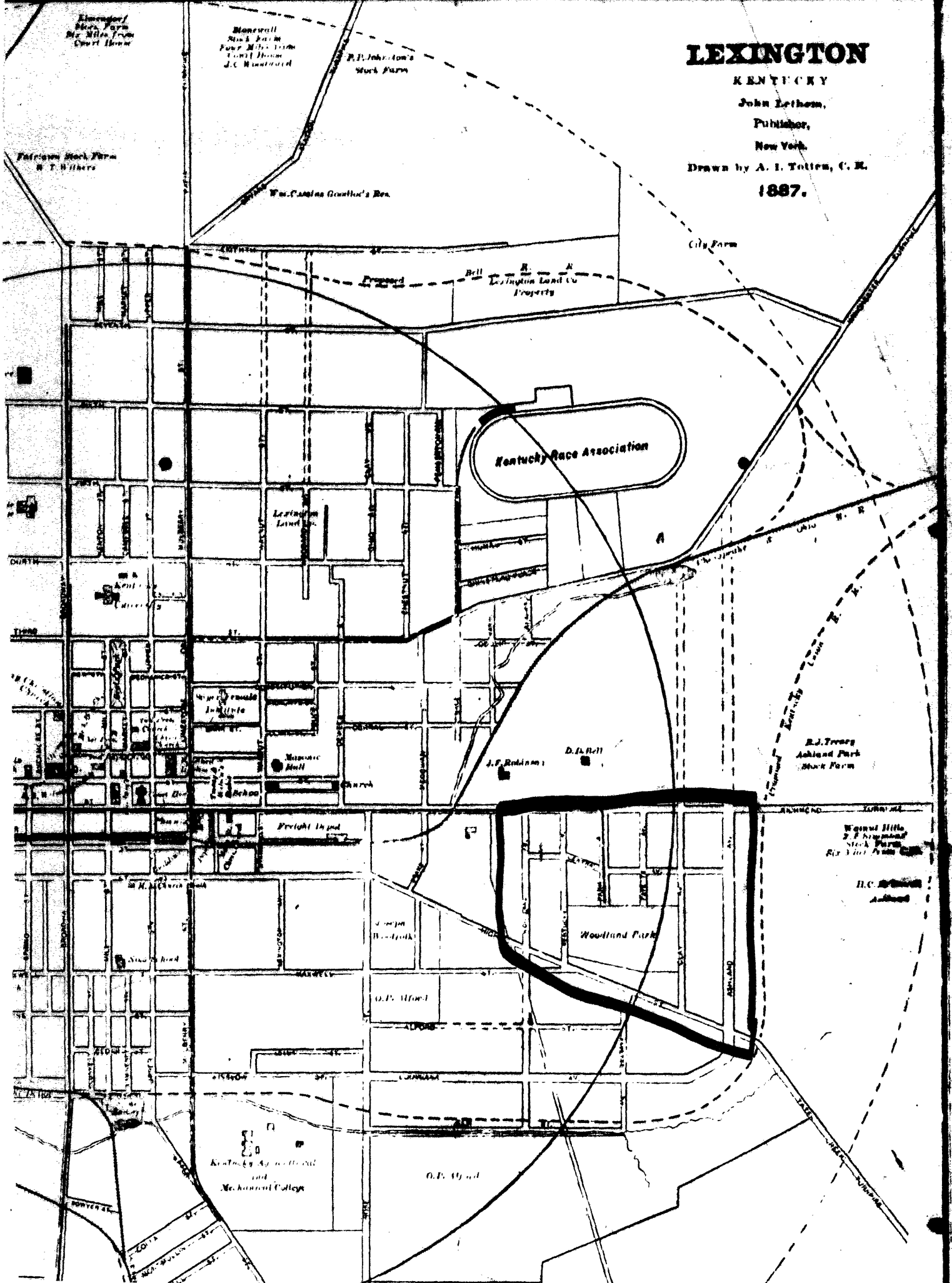

Woodlands Historic District
Fayette County, Kentucky
Lexington, Kentucky. John Lethom,
Publisher, New York
1887
Scale 1200 feet = 1"
Map 1 of 3

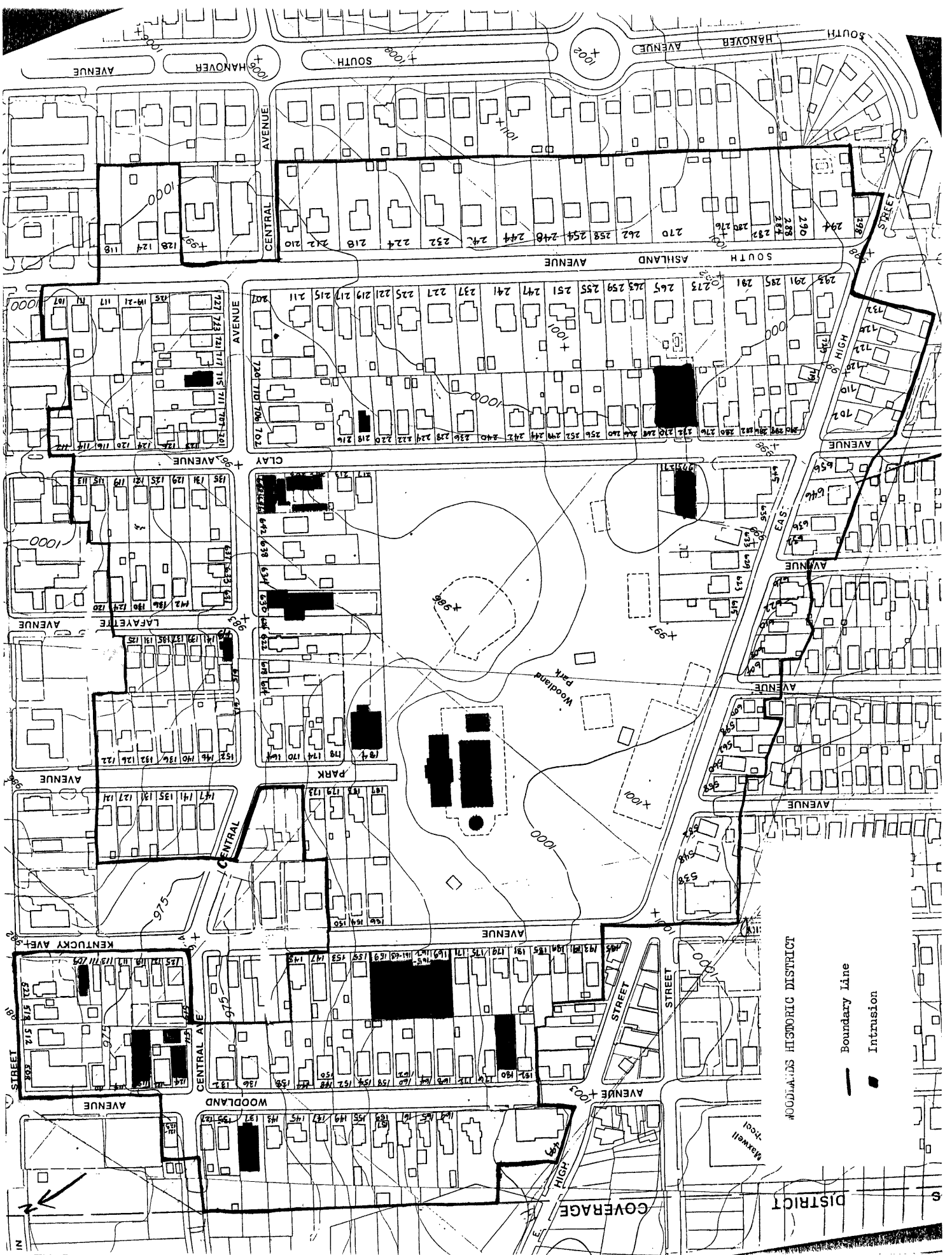

Woodlands Historic District
Fayette County, Kentucky
Planning Commission Map
Current
Scale 1" = 200 feet
Map 2 of 3