

UNITED STATES DEPARTMENT OF THE INTERIOR  
NATIONAL PARK SERVICE

FOR NPS USE ONLY  
RECEIVED NOV 14 1979  
DATE ENTERED

NATIONAL REGISTER OF HISTORIC PLACES  
INVENTORY -- NOMINATION FORM

SEE INSTRUCTIONS IN HOW TO COMPLETE NATIONAL REGISTER FORMS  
TYPE ALL ENTRIES -- COMPLETE APPLICABLE SECTIONS

**1 NAME**

HISTORIC

AND/OR COMMON

Newton West Church Street Historic District

**2 LOCATION**

STREET & NUMBER *W. Church St.*

CITY, TOWN

Newton

VICINITY OF

Third

STATE

Mississippi

CODE

28

COUNTY

Newton

CODE

101

**3 CLASSIFICATION**

CATEGORY	OWNERSHIP	STATUS	PRESENT USE
<input checked="" type="checkbox"/> DISTRICT	<input type="checkbox"/> PUBLIC	<input checked="" type="checkbox"/> OCCUPIED	<input type="checkbox"/> AGRICULTURE
<input type="checkbox"/> BUILDING(S)	<input checked="" type="checkbox"/> PRIVATE	<input type="checkbox"/> UNOCCUPIED	<input type="checkbox"/> MUSEUM
<input type="checkbox"/> STRUCTURE	<input type="checkbox"/> BOTH	<input type="checkbox"/> WORK IN PROGRESS	<input type="checkbox"/> COMMERCIAL
<input type="checkbox"/> SITE	<b>PUBLIC ACQUISITION</b>	<input checked="" type="checkbox"/> ACCESSIBLE	<input type="checkbox"/> EDUCATIONAL
<input type="checkbox"/> OBJECT	<input type="checkbox"/> IN PROCESS	<input type="checkbox"/> YES: RESTRICTED	<input type="checkbox"/> ENTERTAINMENT
	<input type="checkbox"/> BEING CONSIDERED	<input type="checkbox"/> YES: UNRESTRICTED	<input type="checkbox"/> GOVERNMENT
		<input type="checkbox"/> NO	<input type="checkbox"/> INDUSTRIAL
			<input type="checkbox"/> MILITARY
			<input checked="" type="checkbox"/> PRIVATE RESIDENCE
			<input type="checkbox"/> RELIGIOUS
			<input type="checkbox"/> SCIENTIFIC
			<input type="checkbox"/> TRANSPORTATION
			<input type="checkbox"/> OTHER:

**4 OWNER OF PROPERTY**

NAME

Multiple Ownership

STREET & NUMBER

CITY, TOWN

VICINITY OF

STATE

**5 LOCATION OF LEGAL DESCRIPTION**

COURTHOUSE, REGISTRY OF DEEDS, ETC. *Office of the Chancery Clerk  
Newton County Courthouse*

STREET & NUMBER

P. O. Box 68

CITY, TOWN

Decatur

STATE

Mississippi 39327

**6 REPRESENTATION IN EXISTING SURVEYS**

TITLE

Statewide Survey of Historic Sites

DATE

1979

FEDERAL  STATE  COUNTY  LOCAL

DEPOSITORY FOR SURVEY RECORDS

Mississippi Department of Archives and History

CITY, TOWN

Jackson

STATE

Mississippi

# 7 DESCRIPTION

CONDITION		CHECK ONE	CHECK ONE
<input checked="" type="checkbox"/> EXCELLENT	<input type="checkbox"/> DETERIORATED	<input checked="" type="checkbox"/> UNALTERED	<input checked="" type="checkbox"/> ORIGINAL SITE
<input checked="" type="checkbox"/> GOOD	<input type="checkbox"/> RUINS	<input checked="" type="checkbox"/> ALTERED	<input type="checkbox"/> MOVED      DATE _____
<input checked="" type="checkbox"/> FAIR	<input type="checkbox"/> UNEXPOSED		

---

## DESCRIBE THE PRESENT AND ORIGINAL (IF KNOWN) PHYSICAL APPEARANCE

West Church Street Historic District, Newton, Mississippi's historic neighborhood, comprises ~~thirty-one~~ architecturally significant residences. These dwellings are situated on both sides of West Church Street, and the tree-lined level grade of the street provides cohesiveness for a district which maintains the scale and density of its 1900-1930 building period. North and south of the district are more modern houses; east and west boundaries are marked by industrial and strip development.

Development of the district is reflected stylistically by the one-, one-and-one-half-, and two-story residences. Asymmetrically massed, frame Colonial Revival dwellings were constructed after the turn of the century on large lots, frequently separated by wide open spaces. Vernacular cottages and bungalows introduced some brick construction and tile roofs, and illustrate the district's later growth. A number of open spaces were filled, some lots were subdivided, and the neighborhood gained a continuity and a more urban character in the 1920s.

All of the houses are well maintained, and beautifully landscaped yards and parklike spaces are numerous. The district's only intrusion, a ranch-style house on the western border, has a very minimal effect on the character of the district.

### Buildings in the District

*The three-digit numbers beginning each entry refer to street addresses on West Church Street.*

1. 315. Built 1911. Colonial Revival. 2-story 3-bay frame dwelling with hip roof and double-tiered front facade gallery; Ionic columns on upper gallery.
2. 401. Ca. 1905. Bungalow. 1-story 3-bay frame dwelling with pyramidal roof, exposed rafter-tails, and front gallery with square columns on brick pedestals.
3. 403. Ca. 1928. Bungalow. 1-1/2-story frame dwelling; cross gables have projecting eaves with brackets and half-timbering.
4. 405. 1931. 1-1/2-story 3-bay frame dwelling; gable roof with eyelid dormers. Central projecting pavilion has brick round-arch entrance surmounted by gently pitched gable.
5. 407. Marginal contribution; see below.
6. 409. 1930. 1-1/2-story picturesquely massed brick residence combining elliptical flat- and round-arch fenestration and multiple gables. Small gabled entrance hood carried on brackets.
7. 411. Marginal contribution; see below.
8. 501. Ca. 1905. Colonial Revival. 1-1/2-story 5-bay picturesquely massed frame dwelling. Hip-roofed porch on front and side (east) facades carried by Ionic columns.

**NATIONAL REGISTER OF HISTORIC PLACES  
INVENTORY -- NOMINATION FORM**

FOR HCRS USE ONLY	
RECEIVED	NOV 14 1979
DATE ENTERED	23

CONTINUATION SHEET

ITEM NUMBER 4 PAGE 1

4 - OWNER OF PROPERTY

Thomas D. Brand  
607 West Church Street  
Newton, Miss. 39345

R. W. Bounds, Sr.  
505 West Church Street  
Newton, Miss. 39345

M. E. Brooks  
410 West Church Street  
Newton, Miss. 39345

Lucille S. Brown  
602 West Church Street  
Newton, Miss. 39345

Albert B. Carr  
611 West Church Street  
Newton, Miss. 39345

James L. Clark  
600 West Church Street  
Newton, Miss. 39345

Frederick C. Dundas  
400 West Church Street  
Newton, Miss. 39345

Monte W. Edwards  
407 West Church Street  
Newton, Miss. 39345

John Robert Henry  
404 West Church Street  
Newton, Miss. 39345

Mary Allen Hewlett  
503 West Church Street  
Newton, Miss. 39345

Bobby L. Hollingsworth  
304 West Church Street  
Newton, Miss. 39345

Mary Farrell Kee  
601 West Church Street  
Newton, Miss. 39345

Mrs. C. M. Knowles  
302 West Church Street  
Newton, Miss. 39345

James M. Landrum  
Route 2, Box 15  
Magee, Miss. 39111

Henry G. Lewis, Jr.  
502 West Church Street  
Newton, Miss. 39345

Cornelia Watts Logan  
315 West Church Street  
Newton, Miss. 39345

Eloise Majure  
411 West Church Street  
Newton, Miss. 39345

Mrs. James Mayfield  
308 West Church Street  
Newton, Miss. 39345

T. R. McGehee  
507 West Church Street  
Newton, Miss. 39345

Thelma B. McMullan  
700 West Church Street  
Newton, Miss. 39345

George S. Monroe II  
408 West Church Street  
Newton, Miss. 39345

Mamie H. Powe  
504 West Church Street  
Newton, Miss. 39345

FHR-8-300A  
(11/78)

UNITED STATES DEPARTMENT OF THE INTERIOR  
HERITAGE CONSERVATION AND RECREATION SERVICE

**NATIONAL REGISTER OF HISTORIC PLACES  
INVENTORY -- NOMINATION FORM**

FOR HCRS USE ONLY

RECEIVED

NOV 14 1979

DATE ENTERED

CONTINUATION SHEET

ITEM NUMBER 4 PAGE 2

4 - OWNER OF PROPERTY

Elizabeth H. Robelot  
405 West Church Street  
Newton, Miss. 39345

Sidney T. Roebuck  
508 West Church Street  
Newton, Miss. 39345

Chester L. Stanford  
409 West Church Street  
Newton, Miss. 39345

Maxwell H. Stewart  
403 West Church Street  
Newton, Miss. 39345

Ronnie G. Thrash  
401 West Church Street  
Newton, Miss. 39345

Stuart Tune  
306 West Church Street  
Newton, Miss. 39345

Jennie Jenkins Turnage  
510 West Church Street  
Newton, Miss. 39345

Grace Thompson Walton  
500 West Church Street  
Newton, Miss. 39345

Mrs. M. E. Walton  
501 West Church Street  
Newton, Miss. 39345

FOR HCRS USE ONLY	
RECEIVED	NOV 14 1979
DATE ENTERED	2-1

## NATIONAL REGISTER OF HISTORIC PLACES INVENTORY -- NOMINATION FORM

CONTINUATION SHEET

ITEM NUMBER 7 PAGE 3

7 - DESCRIPTION

9. 503. Ca. 1905. Colonial Revival. 1-1/2-story 3-bay picturesquely massed frame dwelling. Central projecting pavilion carried on coupled Ionic columns.
10. 505. Ca. 1905. Colonial Revival. 1-1/2-story 3-bay picturesquely massed frame dwelling with hip-roofed front porch and gable-ended pavilion.
11. 507. Ca. 1930. Bungalow. 1-story 3-bay frame bungalow with broad bracketed gables. Lower front facade gable supported by posts on brick pedestals covers an open porch.
12. 601. Ca. 1905. Colonial Revival. 2-1/2-story 3-bay picturesquely massed frame residence with 1-story hip-roofed gallery along front and side (east) facades. 2-story projecting end pavilion has jerkinhead roof with small Palladian window below.
13. 607. Ca. 1930. Bungalow. 1-story picturesquely massed frame dwelling; gable roof with exposed rafter-tails. Extended eaves of central projecting pavilion are bracketed.
14. 611. Intrusion; see below.
15. 302. Ca. 1905. Colonial Revival. 1-story 5-bay frame dwelling with pyramidal roof and hip-roof front (south) and side (east) gallery. Pyramidal-roofed polygonal projecting end pavilion.
16. 304. Ca. 1905. Colonial Revival. 1-1/2-story picturesquely massed frame residence with multigabled roof. Hip-roofed gallery across front (south) and side (east) facades; polygonal bay on projecting gable-ended pavilion.
17. 306. Marginal contribution; see below.
18. 308. Ca. 1905. Colonial Revival. 1-story 3-bay frame residence with pyramidal roof and Ionic-columned front (south) and side (west) gallery. Front doors have oval beveled glass, transoms, and side lights.
19. 400. Ca. 1905. Colonial Revival. 1-story 4-bay picturesquely massed frame dwelling. Gallery on front (south) and side (east facades) carried on Doric columns. Gabled sections have fish-scale shingles.
20. 404. Ca. 1905. Colonial Revival. 1-1/2-story 3-bay frame dwelling, picturesquely massed. Gabled end pavilion; pedimented central projecting pavilion carried by coupled Doric columns.

FOR HCRS USE ONLY	
RECEIVED	NOV 14 1979
DATE ENTERED	11 20 1979

## NATIONAL REGISTER OF HISTORIC PLACES INVENTORY -- NOMINATION FORM

CONTINUATION SHEET

ITEM NUMBER 7 PAGE 4

### 7 - DESCRIPTION

21. 406. Ca. 1905. Colonial Revival. 1-1/2-story 3-bay frame dwelling with pyramidal roof. Gabled end pavilion; pedimented central projecting pavilion.
22. 408. Ca. 1905. Colonial Revival. 1-1/2-story picturesquely massed frame dwelling with hip-roofed veranda carried on fluted Ionic columns. Gabled end pavilion with polygonal bay has central window flanked by diamond-shaped stained-glass windows.
23. 410. Marginal contribution; see below.
24. 500. Ca. 1905. Colonial Revival. 1-1/2-story 4-bay gable-on-hip-roof frame residence. Gallery on front and side (east) facades has been screened; gabled end pavilion with polygonal bay.
25. 502. Ca. 1930. Bungalow. 1-1/2-story 3-bay frame residence; central bay has round-arch brick entrance. Gabled projecting end pavilion with bracketed eaves.
26. 504. Ca. 1905. Colonial Revival. 1-1/2-story 4-bay picturesquely massed frame dwelling; hip-roofed front and side gallery. Gabled end pavilion.
27. 508. Marginal contribution; see below.
28. 510. Ca. 1930. Bungalow. 1-story 3-bay brick bungalow; exposed rafter-tails on front lower gable.
29. 600. Ca. 1905. Colonial Revival. 1-1/2-story 4-bay picturesquely massed frame dwelling with cross-gambrel roofs. Clustered Ionic columns carry hip-roofed gallery across front and side facades; pedimented pavilion at second bay below gambrel roof.
30. 602. Ca. 1905. Colonial Revival. 1-1/2-story 4-bay frame residence; pyramidal roof with cross gables. Hip-roofed front and side gallery.
31. 700. Ca. 1925. Bungalow. 1-1/2-story 4-bay brick bungalow with jerkinhead tile roof; porte-cochere on eastern facade. Gently pitched front facade gables are bracketed.

### Buildings Which Marginally Contribute to Character of the District

5. 407. Ca. 1930. 1-story 3-bay frame residence with board-and-batten siding.
7. 411. Ca. 1930. 1-story 3-bay frame residence with gable roof and 2-bay shed porch on brick piers.

**NATIONAL REGISTER OF HISTORIC PLACES  
INVENTORY -- NOMINATION FORM**

FOR HCRS USE ONLY	
RECEIVED	NOV 14 1979
DATE ENTERED	20

CONTINUATION SHEET

ITEM NUMBER 7, 9 PAGE 5

7 - DESCRIPTION

17. 306. Ca. 1905. 1-1/2-story 3-bay gable-roof frame dwelling; front porch altered and extended to form garage.
23. 410. Ca. 1930. 1-story gable-roof frame dwelling; central front facade gable with altered aluminum frame window.
27. 508. Ca. 1930. 1-story 3-bay frame residence with twin front gables. Ribbed awnings shade windows in gables.

Intrusions

14. 611. 1-story 5-bay hip-roof ranch-style residence with carport in end (western) bay.

9 - MAJOR BIBLIOGRAPHICAL REFERENCES

- Brieger, James F., comp. Hometown, Mississippi. Privately printed, n.d.
- Brown, A. J. History of Newton County from 1834 to 1894. Jackson, Miss: Clarion-Ledger Co., 1894.
- Brown, Dee Alexander. Grierson's Raid. Urbana: University of Illinois Press, 1954.
- Holt, David, comp. Along the Line of the Mobile, Jackson, and Kansas City Railroad. Mobile: Commercial Printing Co., n.d.
- Lowry, Robert, and William H. McCardle. A History of Mississippi. Spartanburg, S.C.: The Reprint Co., 1978.
- McLemore, Richard A. A History of Mississippi. 2 vols. Jackson: University and College Press of Mississippi, 1973.
- Meridian [Miss.] Public Library. Subject files on Newton County, Mississippi.
- Mississippi Department of Archives and History. Subject files on Newton and Newton County, Mississippi.
- Newton, Miss. Minute Book No. 1., 1903-1909. Municipal Book of Town of Newton. Minutes of the Boards of Aldermen.

# 6 SIGNIFICANCE

PERIOD	AREAS OF SIGNIFICANCE -- CHECK AND JUSTIFY BELOW			
<input type="checkbox"/> PREHISTORIC	<input type="checkbox"/> ARCHEOLOGY-PREHISTORIC	<input type="checkbox"/> COMMUNITY PLANNING	<input type="checkbox"/> LANDSCAPE ARCHITECTURE	<input type="checkbox"/> RELIGION
<input type="checkbox"/> 1400-1499	<input type="checkbox"/> ARCHEOLOGY-HISTORIC	<input type="checkbox"/> CONSERVATION	<input type="checkbox"/> LAW	<input type="checkbox"/> SCIENCE
<input type="checkbox"/> 1500-1599	<input type="checkbox"/> AGRICULTURE	<input type="checkbox"/> ECONOMICS	<input type="checkbox"/> LITERATURE	<input type="checkbox"/> SCULPTURE
<input type="checkbox"/> 1600-1699	<input checked="" type="checkbox"/> ARCHITECTURE	<input type="checkbox"/> EDUCATION	<input type="checkbox"/> MILITARY	<input type="checkbox"/> SOCIAL/HUMANITARIAN
<input type="checkbox"/> 1700-1799	<input type="checkbox"/> ART	<input type="checkbox"/> ENGINEERING	<input type="checkbox"/> MUSIC	<input type="checkbox"/> THEATER
<input type="checkbox"/> 1800-1899	<input type="checkbox"/> COMMERCE	<input type="checkbox"/> EXPLORATION/SETTLEMENT	<input type="checkbox"/> PHILOSOPHY	<input type="checkbox"/> TRANSPORTATION
<input type="checkbox"/> 1900-	<input type="checkbox"/> COMMUNICATIONS	<input type="checkbox"/> INDUSTRY	<input type="checkbox"/> POLITICS/GOVERNMENT	<input type="checkbox"/> OTHER (SPECIFY)
		<input type="checkbox"/> INVENTION		

SPECIFIC DATES

BUILDER/ARCHITECT

## STATEMENT OF SIGNIFICANCE

Newton's West Church Street Historic District is an architecturally significant residential neighborhood that documents the prosperity of this small rural railroad center during the early part of the present century. Its well-preserved picturesque examples of the Colonial Revival, vernacular, and bungalow styles display a timely collection of dwellings in a neighborhood setting unequalled in east-central Mississippi.

Development of the West Church Street neighborhood corresponded with the growth of Newton's commercial district following completion of the New Orleans, Mobile, and Chicago railroad in 1905. As a junction for two railroad lines, Newton grew in importance as a commercial and social center and was the location of several new industries. The influx of population and economic prosperity ca. 1905 demanded residential expansion and the West Church Street blocks were platted at that time. One chronicle of the era recorded that "during this period, more than 100 residences, ranging in price from \$700 to several thousand dollars, were erected, aggregating a sum of something like \$125,000" (George W. Bellar, comp. and ed., Newton, Mississippi [Newton: C. E. Cunningham, 1913], p. 2). Many of Newton's prominent citizens erected outstanding Colonial Revival residences on West Church Street. They include houses of Horace H. Watts (no. 1), Dr. J. H. Brown (no. 29), C. E. Cunningham, owner and editor of the Newton Record and a president of the State Press Association (no. 9), and J. C. McClinton, merchandise broker (no. 12). Several of the houses are still owned by the original families, a factor that further strengthens the district's special continuity of time, place, and tradition.



# 9 MAJOR BIBLIOGRAPHICAL REFERENCES

Amis, A. B. Recollections of Social Customs in Newton and Scott Counties, 50 Years Ago.  
Meridian: Dement Printing Co., n.d.

Bellar, George W., comp. and ed. Newton, Miss. Newton: C. E. Cunningham, 1913.

Biographical and Historical Memoirs of Mississippi. Chicago: Goodspeed Publishing Co., 1891.

# 10 GEOGRAPHICAL DATA

**UTM NOT VERIFIED**

ACREAGE OF NOMINATED PROPERTY 12 acres

QUADRANGLE NAME Newton, Miss.

QUADRANGLE SCALE 1:24000

UTM REFERENCES

A 

1	6	2	9	5	5	4	0	3	5	7	8	2	2	0
---	---	---	---	---	---	---	---	---	---	---	---	---	---	---

B 

1	6	2	9	6	1	1	0	3	5	7	8	0	6	0
---	---	---	---	---	---	---	---	---	---	---	---	---	---	---

ZONE EASTING NORTHING

ZONE EASTING NORTHING

C 

1	6	2	9	5	6	0	0	3	5	7	8	1	1	5
---	---	---	---	---	---	---	---	---	---	---	---	---	---	---

D 

1	6	2	9	6	0	3	0	3	5	7	8	0	0	0
---	---	---	---	---	---	---	---	---	---	---	---	---	---	---

E 

--	--	--	--	--	--	--	--	--	--	--	--	--	--	--

F 

--	--	--	--	--	--	--	--	--	--	--	--	--	--	--

G 

--	--	--	--	--	--	--	--	--	--	--	--	--	--	--

H 

--	--	--	--	--	--	--	--	--	--	--	--	--	--	--

## VERBAL BOUNDARY DESCRIPTION

Irregularly shaped area enclosed by the red line on the official 1979 plat of the Town of Newton.

## LIST ALL STATES AND COUNTIES FOR PROPERTIES OVERLAPPING STATE OR COUNTY BOUNDARIES

STATE	CODE	COUNTY	CODE
STATE	CODE	COUNTY	CODE

STATE	CODE	COUNTY	CODE
-------	------	--------	------

# 11 FORM PREPARED BY

NAME / TITLE

Jody Cook, Architectural Historian

ORGANIZATION

Mississippi Department of Archives and History

DATE

October, 1979

STREET & NUMBER

P. O. Box 571

TELEPHONE

(601) 354-7326

CITY OR TOWN

Jackson

STATE

Mississippi 39205

# 12 STATE HISTORIC PRESERVATION OFFICER CERTIFICATION

THE EVALUATED SIGNIFICANCE OF THIS PROPERTY WITHIN THE STATE IS:

NATIONAL     

STATE     

LOCAL X

As the designated State Historic Preservation Officer for the National Historic Preservation Act of 1966 (Public Law 89-665), I hereby nominate this property for inclusion in the National Register and certify that it has been evaluated according to the criteria and procedures set forth by the National Park Service.

STATE HISTORIC PRESERVATION OFFICER SIGNATURE

*William B. Williams*

TITLE State Historic Preservation Officer

DATE November 2, 1979

FOR NPS USE ONLY

I HEREBY CERTIFY THAT THIS PROPERTY IS INCLUDED IN THE NATIONAL REGISTER

KEEPER OF THE NATIONAL REGISTER

DATE 1/20/80

ATTEST:

CHIEF OF REGISTRATION

DATE 1/17/80

**NATIONAL REGISTER OF HISTORIC PLACES  
INVENTORY -- NOMINATION FORM**

FOR HCRS USE ONLY  
RECEIVED NOV 14 1979  
DATE ENTERED 20

CONTINUATION SHEET

ITEM NUMBER 9 PAGE 6

9 - MAJOR BIBLIOGRAPHICAL REFERENCES

- Rowland, Dunbar, ed. Mississippi: Comprising Sketches of Counties, Towns, Events, Institutions, and Persons Arranged in Cyclopedic Form. 3 vols. Atlanta: Southern Historical Publishing Association, 1907.
- Sanborn Insurance Maps of Newton, Miss., for the years 1905, 1910, 1916, and 1927. New York: Sanborn Map Co. Originals located at Mississippi State University Library, Special Collections, Mississippi State.
- U.S. Census. 13th Census of the U.S. 1910, Vol. II., Population: Alabama - Montana. Bureau of Census, Department of Commerce. Washington, D.C.: Government Printing Office, 1913.
- Watkins, Ruth. "Reconstruction in Newton County," Publications of the Mississippi Historical Society XI:205-228.
- Williams, Nancy K. "Yesterday in Newton," column in The Newton [Miss.] Record, Jan. - Sept. 1979, passim.

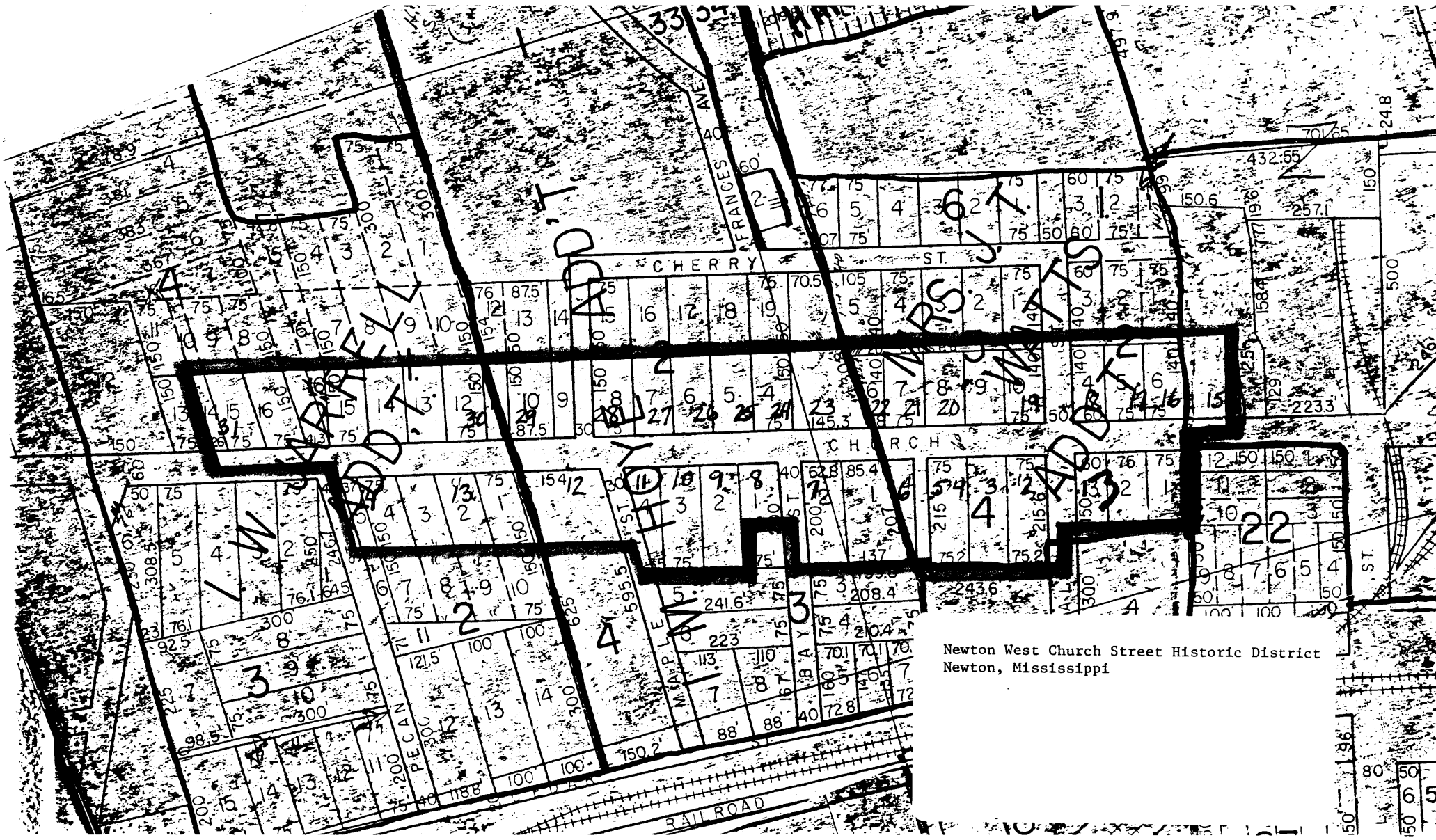

Newton West Church Street Historic District  
 Newton, Mississippi