

**United States Department of the Interior
Heritage Conservation and Recreation Service**

**National Register of Historic Places
Inventory—Nomination Form**

See instructions in *How to Complete National Register Forms*
Type all entries—complete applicable sections

1. Name

historic Edgewood

and/or common

2. Location

street & number 1 mile west of Farmerville on the Bernice Hwy. not for publication

city, town Farmerville X vicinity of congressional district 5th-Jerry Huckaby

state Louisiana code 22 county Union Parish code 111

3. Classification

Category	Ownership	Status	Present Use
<input type="checkbox"/> district	<input type="checkbox"/> public	<input checked="" type="checkbox"/> occupied	<input type="checkbox"/> agriculture
<input checked="" type="checkbox"/> building(s)	<input checked="" type="checkbox"/> private	<input type="checkbox"/> unoccupied	<input type="checkbox"/> commercial
<input type="checkbox"/> structure	<input type="checkbox"/> both	<input type="checkbox"/> work in progress	<input type="checkbox"/> educational
<input type="checkbox"/> site	Public Acquisition	Accessible	<input type="checkbox"/> entertainment
<input type="checkbox"/> object	<input type="checkbox"/> in process	<input checked="" type="checkbox"/> yes: restricted	<input type="checkbox"/> government
	<input type="checkbox"/> being considered	<input type="checkbox"/> yes: unrestricted	<input type="checkbox"/> industrial
		<input type="checkbox"/> no	<input type="checkbox"/> military
			<input type="checkbox"/> museum
			<input type="checkbox"/> park
			<input checked="" type="checkbox"/> private residence
			<input type="checkbox"/> religious
			<input type="checkbox"/> scientific
			<input type="checkbox"/> transportation
			<input type="checkbox"/> other:

4. Owner of Property

name Edward A. Jones, Administrator, J.D. Baughman Estate

street & number 307 Bernice Highway

city, town Farmerville vicinity of state Louisiana 71241

5. Location of Legal Description

courthouse, registry of deeds, etc. Union Parish Courthouse

street & number

city, town Farmerville state La.

6. Representation in Existing Surveys

title La. Historic Sites Survey has this property been determined eligible? yes X no

date 1980 federal X state county local

depository for survey records La. State Historic Preservation Office

city, town Baton Rouge state Louisiana

7. Description

Condition		Check one	Check one
<input type="checkbox"/> excellent	<input type="checkbox"/> deteriorated	<input type="checkbox"/> unaltered	<input checked="" type="checkbox"/> original site
<input checked="" type="checkbox"/> good	<input type="checkbox"/> ruins	<input checked="" type="checkbox"/> altered	<input type="checkbox"/> moved date _____
<input type="checkbox"/> fair	<input type="checkbox"/> unexposed		

Describe the present and original (if known) physical appearance

Edgewood is located north of Farmerville on the shore of Lake D'Arbonne. The house is set upon a grassy rise above the lake with surrounding mature oak trees.

Raised almost a full story above the ground in front, the house is set at grade level at the rear. The frame one story house consists of 11 large rooms laid out in an irregular "L" shaped plan. An "L" shaped hall runs from front to rear of the house and gives access to the parlor living room and dining room. The living room has a corner alcove set in a pencil thin turret which protrudes impressively above the roofline with an upper band of lancet windows. The parlor has a protruding semihexagonal bay which is encompassed by a broad curving Eastlake gallery. Actually this gallery follows the contours of the entire front of the house extending to a length of 26 bays. The roofline has a total of seven gables, three of which are ornamented with scroll sawn millwork. The exterior is sheathed with three types of imbricated shingles. The Eastlake galleries have fluted columns with scroll brackets. The house has Eastlake window frames inside and out. The interior features narrow gauge wainscotting, etched glass doors, scroll saw screens and catalog ordered oak mantels.

The only changes have been the screening in of portions of the gallery and the addition of a side carport.

8. Significance

Period	Areas of Significance—Check and justify below			
<input type="checkbox"/> prehistoric	<input type="checkbox"/> archeology-prehistoric	<input type="checkbox"/> community planning	<input type="checkbox"/> landscape architecture	<input type="checkbox"/> religion
<input type="checkbox"/> 1400–1499	<input type="checkbox"/> archeology-historic	<input type="checkbox"/> conservation	<input type="checkbox"/> law	<input type="checkbox"/> science
<input type="checkbox"/> 1500–1599	<input type="checkbox"/> agriculture	<input type="checkbox"/> economics	<input type="checkbox"/> literature	<input type="checkbox"/> sculpture
<input type="checkbox"/> 1600–1699	<input checked="" type="checkbox"/> architecture	<input type="checkbox"/> education	<input type="checkbox"/> military	<input type="checkbox"/> social/ humanitarian
<input type="checkbox"/> 1700–1799	<input type="checkbox"/> art	<input type="checkbox"/> engineering	<input type="checkbox"/> music	<input type="checkbox"/> theater
<input type="checkbox"/> 1800–1899	<input type="checkbox"/> commerce	<input type="checkbox"/> exploration/settlement	<input type="checkbox"/> philosophy	<input type="checkbox"/> transportation
<input checked="" type="checkbox"/> 1900–	<input type="checkbox"/> communications	<input type="checkbox"/> industry	<input type="checkbox"/> politics/government	<input type="checkbox"/> other (specify)
		<input type="checkbox"/> invention		

Specific dates 1902 **Builder/Architect** J.D. Baughman-Builder

Statement of Significance (in one paragraph) Criterion C

Edgewood is significant in the area of architecture as one of the state's finest examples of a rural Queen Anne Revival residence. There are probably less than about 20 other Queen Anne country houses which are as elaborately articulated. Noteworthy features in this regard include the seven gables, the 26 bay curving Eastlake gallery, the unusual fluted Eastlake columns and the highly unusual pencil like turret with its tiny row of lancet windows.

It is said that in the late 1920's aviator Charles A. Lindbergh landed in the front yard to refuel enroute to Texarkana.

9. Major Bibliographical References

Etched transom window on front door giving date of construction and builder.

Report on Edgewood submitted by Edward Jones, located in Edgewood National Register File, State Historic Preservation Office, Baton Rouge.

10. Geographical Data

UTM NOT VERIFIED
ACREAGE NOT VERIFIED

Acreeage of nominated property Approx. 4 acres

Quadrangle name _____

Quadrangle scale _____

UMT References

A

1	5	5	5	3	8	5	0	3	6	2	7	6	0	0
Zone			Easting				Northing							

B

Zone			Easting				Northing							

C

Zone			Easting				Northing							

D

Zone			Easting				Northing							

E

Zone			Easting				Northing							

F

Zone			Easting				Northing							

G

Zone			Easting				Northing							

H

Zone			Easting				Northing							

Verbal boundary description and justification

See sketch map.

List all states and counties for properties overlapping state or county boundaries

state	code	county	code
-------	------	--------	------

state	code	county	code
-------	------	--------	------

11. Form Prepared By

name/title Edward A. Jones, Administrator, J.D. Baughman Estate

organization _____ date June 1980

street & number 307 Bernice Highway telephone _____

city or town Farmerville state La. 71241

12. State Historic Preservation Officer Certification

The evaluated significance of this property within the state is:

national state local

As the designated State Historic Preservation Officer for the National Historic Preservation Act of 1966 (Public Law 89-665), I hereby nominate this property for inclusion in the National Register and certify that it has been evaluated according to the criteria and procedures set forth by the Heritage Conservation and Recreation Service.

State Historic Preservation Officer signature

Robert B. DeBlieux
Robert B. DeBlieux

title State Historic Preservation Officer

date 8/6/80

For HCERS use only

I hereby certify that this property is included in the National Register

Bill Grosvenor
Keeper of the National Register

date 10/8/80

Attest:
Chief of Registration

date _____

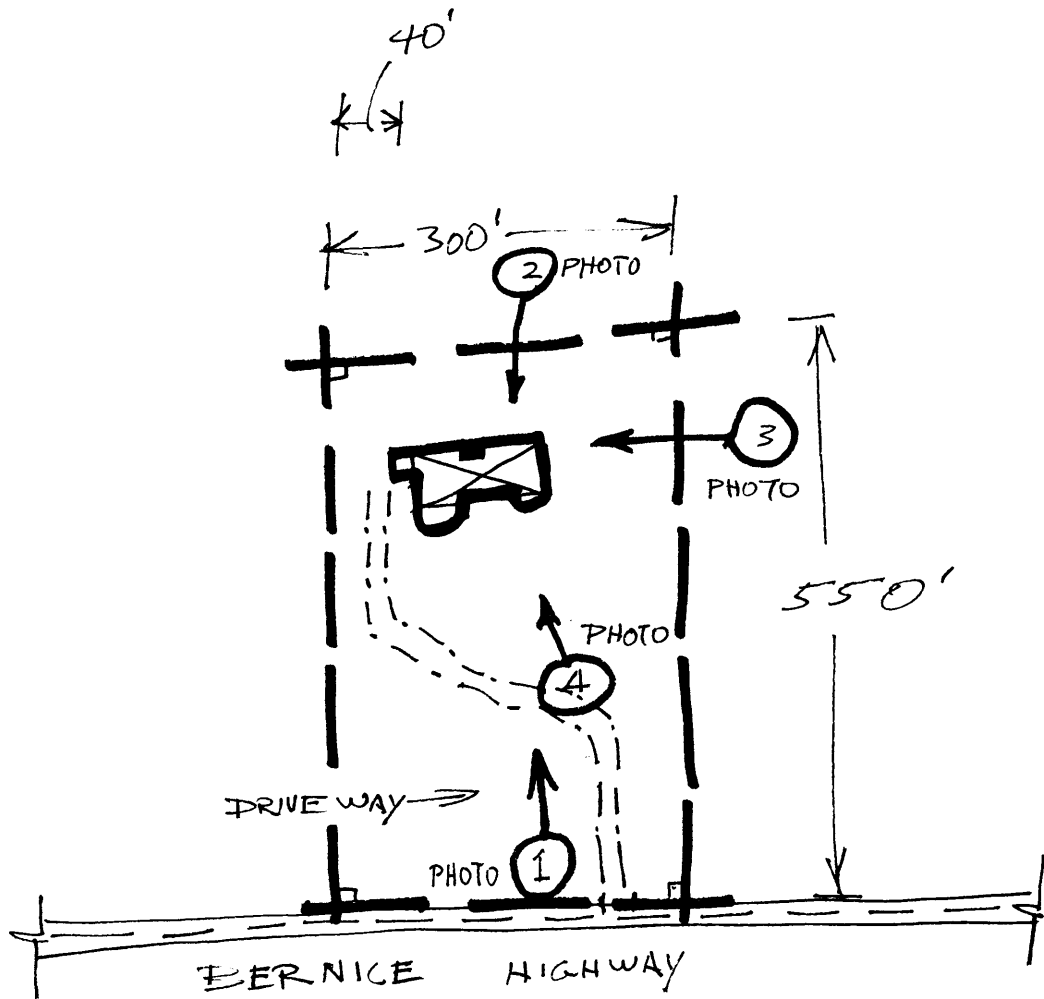

Approx 4. Acres.
 Boundaries drawn to take in
 house and sloping front yard

AUG 13 1980

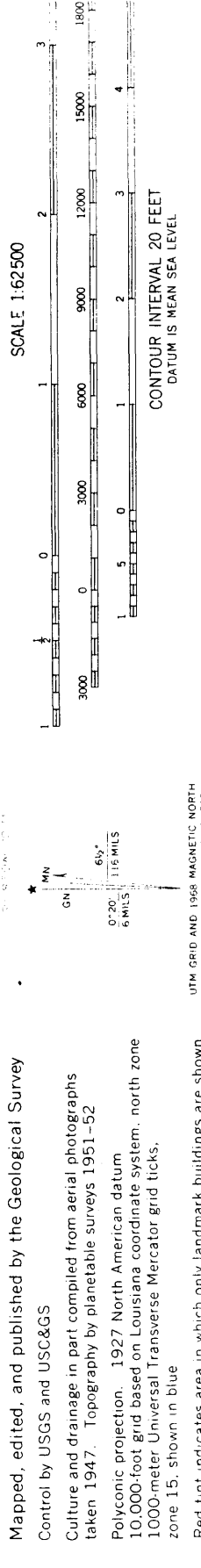
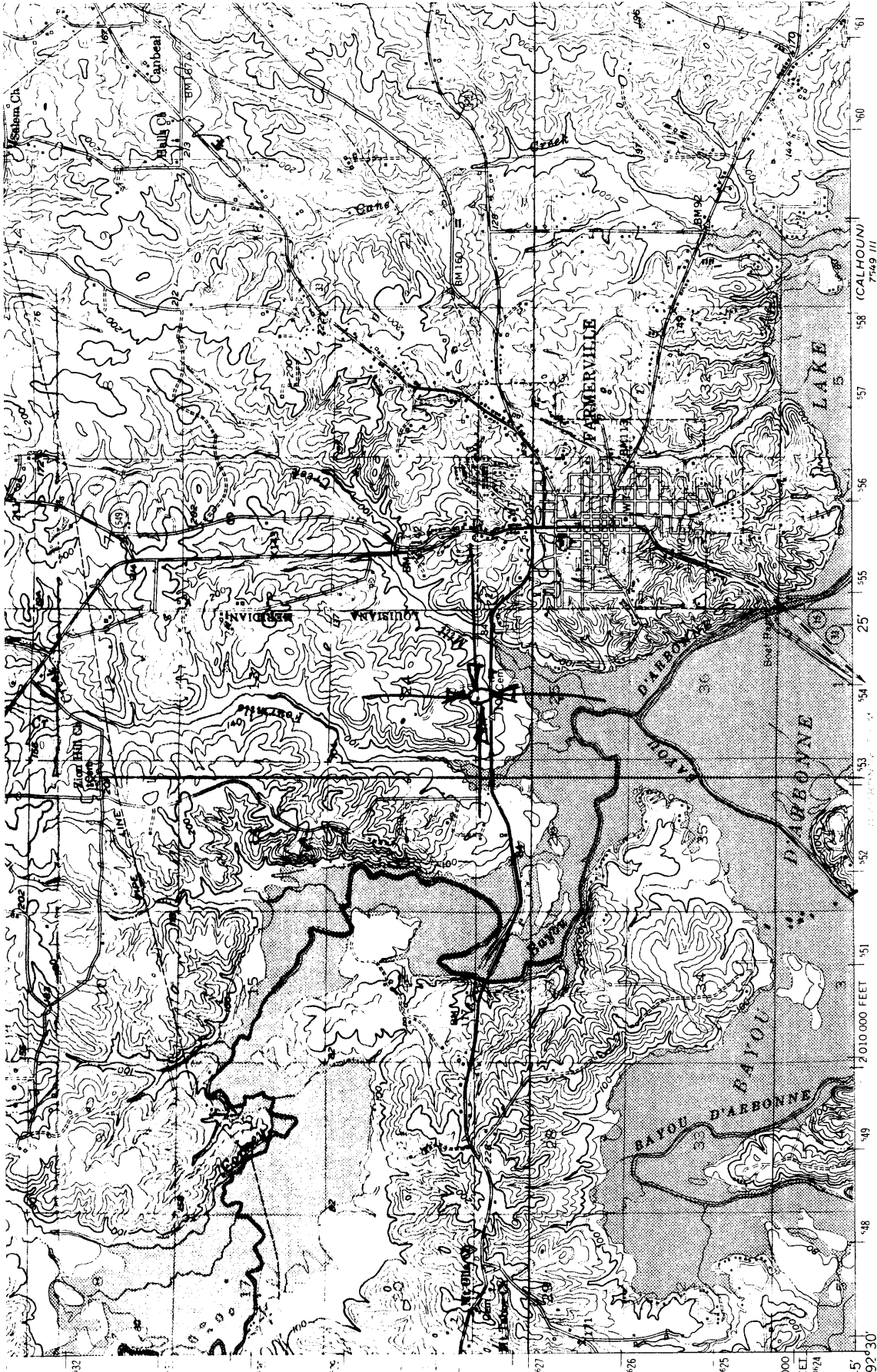

Mapped, edited, and published by the Geological Survey
 Control by USGS and USC&GS
 Culture and drainage in part compiled from aerial photographs taken 1947. Topography by planetable surveys 1951-52
 Polycyclic projection. 1927 North American datum
 10,000-foot grid based on Louisiana coordinate system, north zone
 1000-meter Universal Transverse Mercator grid ticks, zone 15, shown in blue
 Red tint indicates area in which only landmark buildings are shown
 Revisions shown in purple compiled in cooperation with Louisiana Department of Public Works from aerial photographs taken 1963. This information not fieldchecked
 Purple tint indicates extensions of urban area
 UTM GRID AND 1956 MAGNETIC NORTH DECLINATION AT CENTER OF SHEET
 SCALE 1:62500
 CONTOUR INTERVAL 20 FEET
 DATUM IS MEAN SEA LEVEL
 THIS MAP COMPLIES WITH NATIONAL MAP ACCURACY STANDARDS
 FOR SALE BY U. S. GEOLOGICAL SURVEY, DENVER, COLORADO 80225, OR WASHINGTON
 AND BY THE STATE OF LOUISIANA, DEPARTMENT OF PUBLIC WORKS, BATON ROUGE, LA
 A FOLDER DESCRIBING TOPOGRAPHIC MAPS AND SYMBOLS IS AVAILABLE ON REQ

Edgewood

15/553850/3627600