

United States Department of the Interior  
National Park Service

National Register of Historic Places  
Inventory—Nomination Form

For NPS use only

received **MAR 10 1983**  
date entered

See instructions in *How to Complete National Register Forms*  
Type all entries—complete applicable sections

**1. Name**

historic ~~Not known~~

and/or common Moore House

**2. Location**

street & number 1717 Lakeshore Drive N/A not for publication

city, town Mandeville N/A vicinity of

state LA code 022 parish ~~county~~ St. Tammany code 103

**3. Classification**

Category	Ownership	Status	Present Use
<input type="checkbox"/> district	<input type="checkbox"/> public	<input checked="" type="checkbox"/> occupied	<input type="checkbox"/> agriculture
<input checked="" type="checkbox"/> building(s)	<input checked="" type="checkbox"/> private	<input type="checkbox"/> unoccupied	<input type="checkbox"/> commercial
<input type="checkbox"/> structure	<input type="checkbox"/> both	<input type="checkbox"/> work in progress	<input type="checkbox"/> educational
<input type="checkbox"/> site	<b>Public Acquisition</b>	<b>Accessible</b>	<input type="checkbox"/> entertainment
<input type="checkbox"/> object	N/A in process	<input checked="" type="checkbox"/> yes: restricted	<input type="checkbox"/> government
	N/A being considered	<input type="checkbox"/> yes: unrestricted	<input type="checkbox"/> industrial
		<input type="checkbox"/> no	<input type="checkbox"/> military
			<input type="checkbox"/> museum
			<input type="checkbox"/> park
			<input checked="" type="checkbox"/> private residence
			<input type="checkbox"/> religious
			<input type="checkbox"/> scientific
			<input type="checkbox"/> transportation
			<input type="checkbox"/> other:

**4. Owner of Property**

name See continuation sheet

street & number

city, town vicinity of state

**5. Location of Legal Description**

courthouse, registry of deeds, etc. St. Tammany Parish Courthouse

street & number 510 E. Boston P. O. Box 1090

city, town Covington state LA 70433

**6. Representation in Existing Surveys**

title LA Historic Sites Survey has this property been determined eligible?  yes  no

date 1982  federal  state  county  local

depository for survey records State Historic Preservation Office

city, town Baton Rouge state LA

## 7. Description

### Condition

excellent  
 good  
 fair

deteriorated  
 ruins  
 unexposed

### Check one

unaltered  
 altered

### Check one

original site  
 moved date N/A

### Describe the present and original (if known) physical appearance

The Moore House (c.1840) is a provincial Greek Revival raised cottage located on the shore of Lake Pontchartrain in Mandeville. Despite a few alterations, the house retains its architectural integrity.

The pitsawn frame house is raised a full story above grade on brick piers. Access to the house is provided by a staircase on the seven bay front gallery. The house itself is five bays wide with a wide central hall, two main rooms, and a pair of rear cabinets with a small gallery between.

Noteworthy features include:

1. The attenuated front gallery columns.
2. The box cornice on the front gallery,
3. The exposed beaded beams both inside and out.
4. The shoulder molded central doorway with its transom, side lights, and original glass paneled doors. The side lights are particularly interesting because they are covered with wood panels which have decorative slits.
5. The French doors on the front gallery.
6. The two exterior chimneys.

In the early twentieth century the lower story was partially enclosed and shallow brick arches were placed between some of the brick piers.

Recent changes include:

1. The replacement of the two original mantels.
2. The enclosure of the old rear gallery and the construction of a new rear gallery.
3. The rear roofline has been adjusted slightly to accommodate a skylight over the old enclosed rear gallery.

Despite these changes, the Moore House retains the features which establish its architectural significance (as described in Item 8).

# 8. Significance

Period	Areas of Significance—Check and justify below			
<input type="checkbox"/> prehistoric	<input type="checkbox"/> archeology-prehistoric	<input type="checkbox"/> community planning	<input type="checkbox"/> landscape architecture	<input type="checkbox"/> religion
<input type="checkbox"/> 1400–1499	<input type="checkbox"/> archeology-historic	<input type="checkbox"/> conservation	<input type="checkbox"/> law	<input type="checkbox"/> science
<input type="checkbox"/> 1500–1599	<input type="checkbox"/> agriculture	<input type="checkbox"/> economics	<input type="checkbox"/> literature	<input type="checkbox"/> sculpture
<input type="checkbox"/> 1600–1699	<input checked="" type="checkbox"/> architecture	<input type="checkbox"/> education	<input type="checkbox"/> military	<input type="checkbox"/> social/ humanitarian
<input type="checkbox"/> 1700–1799	<input type="checkbox"/> art	<input type="checkbox"/> engineering	<input type="checkbox"/> music	<input type="checkbox"/> theater
<input checked="" type="checkbox"/> 1800–1899	<input type="checkbox"/> commerce	<input type="checkbox"/> exploration/settlement	<input type="checkbox"/> philosophy	<input type="checkbox"/> transportation
<input type="checkbox"/> 1900–	<input type="checkbox"/> communications	<input type="checkbox"/> industry	<input type="checkbox"/> politics/government	<input type="checkbox"/> other (specify)
		<input type="checkbox"/> invention		

**Specific dates**      c.1840                      **Builder/Architect**      Unknown

**Statement of Significance (in one paragraph)**                      Criterion C

The Moore House is locally significant in the area of architecture because it is the finest of a small group of the oldest surviving structures in the town of Mandeville.

The recently completed comprehensive historic standing structures survey of the town of Mandeville identified several hundred 50+ year old structures. Most of these date from the late nineteenth and early twentieth centuries. Mandeville's earliest houses date from the period 1830 to 1850. Typically these are raised cottages with simple Greek Revival inspired details. All have gallery posts but none have full entablatures. Most have French doors and exposed rafters on the gallery and in the rooms. The more pretentious examples have front doors with transoms and side lights. The survey identified eight such examples in the town. Among this group, the Moore House is conspicuous because of its size, being somewhat larger than any of the other examples. Most of the others have three or four bays whereas the Moore House has a full five bays with a seven bay gallery. In addition, it has a full central hall plan which is uncommon among early houses in Mandeville. Moreover, the Moore House has a handsome symmetrically placed front door with a shoulder molded frame, a transom, and side lights. Finally, the Moore House is raised a full story above grade, which is higher than most of the other examples. In summation, if Mandeville's early residences were located in a rural setting, most of them would be considered quarters type structures or overseers houses. By contrast, the Moore House would stand as a full fledged plantation house.

## 9. Major Bibliographical References

Comprehensive Historic Standing Structures Survey, St. Tammany Parish,  
on file in Louisiana State Historic Preservation Office  
St. Tammany Parish Conveyance Records

## 10. Geographical Data

Acreeage of nominated property @ 1/5 of an acre

Quadrangle name Mandeville

Quadrangle scale 1:24000

### UTM References

A 

1	5	7	8	2	2	0	0	3	3	6	1	1	4	0
Zone		Easting				Northing								

B 

Zone		Easting				Northing								

C 

Zone		Easting				Northing								

D 

Zone		Easting				Northing								

E 

Zone		Easting				Northing								

F 

Zone		Easting				Northing								

G 

Zone		Easting				Northing								

H 

Zone		Easting				Northing								

### Verbal boundary description and justification

See sketch map.

### List all states and counties for properties overlapping state or county boundaries

state N/A code county code

state code county code

## 11. Form Prepared By

name/title National Register staff of  
Division of Historic Preservation

Assisted by owners (Item 4)

organization State of Louisiana

date February 1983

street & number P. O. Box 44247

telephone (504) 342-6682

city or town Baton Rouge

state LA 70804

## 12. State Historic Preservation Officer Certification

The evaluated significance of this property within the state is:

national  state  local

As the designated State Historic Preservation Officer for the National Historic Preservation Act of 1966 (Public Law 89-665), I hereby nominate this property for inclusion in the National Register and certify that it has been evaluated according to the criteria and procedures set forth by the National Park Service.

State Historic Preservation Officer signature

*Robert B. DeBlieux*  
Robert B. DeBlieux

title State Historic Preservation Officer

date March 3, 1983

### For NPS use only

I hereby certify that this property is included in the National Register

for *Linda McClelland*  
Keeper of the National Register

date 4/20/83

for *Patrick Andrews*  
Chief of Registration

date 4/18/83

**United States Department of the Interior  
Heritage Conservation and Recreation Service  
National Register of Historic Places  
Inventory—Nomination Form**



Continuation sheet Moore House

Item number 4

Page 1

4. Owners of Property

Mrs. James P. Moore  
P. O. Box 396  
Mandeville, LA 70448

David Moore  
P. O. Box 472  
Mandeville, LA 70448

Mrs. Bob Hanisee  
2627 Lakeshore Drive  
Mandeville, LA 70448  
(504) 626-3328

# MOORE HOUSE, Mandeville St. Tammany Parish

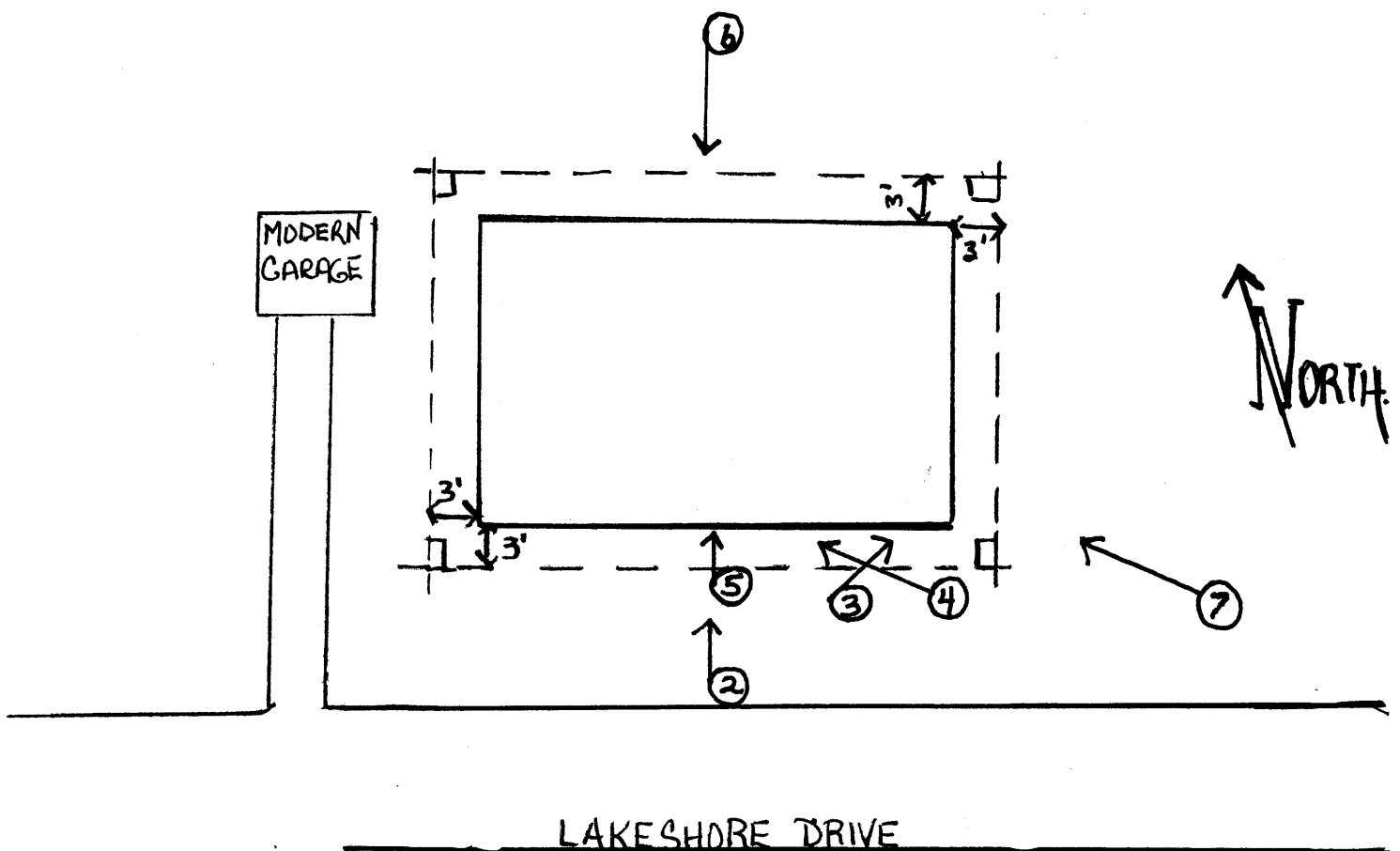

Boundaries are drawn 3 feet from the exterior walls of the House to exclude the modern garage and extend recognition only to the house itself.

Site Boundaries are parallel to Bldg facades, Distances as shown.