

UNITED STATES DEPARTMENT OF THE INTERIOR
NATIONAL PARK SERVICE

FOR NPS USE ONLY
RECEIVED **OCT 2 1979**
DATE ENTERED **NOV 29 1979**

**NATIONAL REGISTER OF HISTORIC PLACES
INVENTORY -- NOMINATION FORM**

SEE INSTRUCTIONS IN *HOW TO COMPLETE NATIONAL REGISTER FORMS*
TYPE ALL ENTRIES -- COMPLETE APPLICABLE SECTIONS

1 NAME

HISTORIC

Seaborn M. Shankle House

AND/OR COMMON

Same as above

LOCATION

STREET & NUMBER

125 Cherry Street

___ NOT FOR PUBLICATION

CITY, TOWN

Commerce

___ VICINITY OF

CONGRESSIONAL DISTRICT
9th - Ed Jenkins

STATE

Georgia

CODE
013

COUNTY
Jackson

CODE
157

CLASSIFICATION

CATEGORY

- ___ DISTRICT
- BUILDING(S)
- ___ STRUCTURE
- ___ SITE
- ___ OBJECT

OWNERSHIP

- ___ PUBLIC
- PRIVATE
- ___ BOTH
- PUBLIC ACQUISITION**
- ___ IN PROCESS
- ___ BEING CONSIDERED

STATUS

- ___ OCCUPIED
- UNOCCUPIED
- ___ WORK IN PROGRESS
- ACCESSIBLE**
- YES: RESTRICTED
- ___ YES: UNRESTRICTED
- ___ NO

PRESENT USE

- ___ AGRICULTURE
- ___ COMMERCIAL
- ___ EDUCATIONAL
- ___ ENTERTAINMENT
- ___ GOVERNMENT
- ___ INDUSTRIAL
- ___ MILITARY
- ___ MUSEUM
- ___ PARK
- ___ PRIVATE RESIDENCE
- ___ RELIGIOUS
- ___ SCIENTIFIC
- ___ TRANSPORTATION
- OTHER: unoccupied

OWNER OF PROPERTY

NAME

Mrs. Bonita S. Kenny

STREET & NUMBER

340 Harlan Square

Box 244
CARLISLE, PA 17013

CITY, TOWN

Bel Air

___ VICINITY OF

STATE

Maryland 21014

LOCATION OF LEGAL DESCRIPTION

COURTHOUSE,
REGISTRY OF DEEDS, ETC.

Superior Court

STREET & NUMBER

Jackson County Courthouse

CITY, TOWN

Jefferson

STATE

Georgia

6 REPRESENTATION IN EXISTING SURVEYS

TITLE

None

DATE

___ FEDERAL ___ STATE ___ COUNTY ___ LOCAL

DEPOSITORY FOR
SURVEY RECORDS

CITY, TOWN

STATE

4

7 DESCRIPTION

CONDITION		CHECK ONE	CHECK ONE
<input type="checkbox"/> EXCELLENT	<input type="checkbox"/> DETERIORATED	<input type="checkbox"/> UNALTERED	<input checked="" type="checkbox"/> ORIGINAL SITE
<input checked="" type="checkbox"/> GOOD	<input type="checkbox"/> RUINS	<input checked="" type="checkbox"/> ALTERED	<input type="checkbox"/> MOVED DATE _____
<input type="checkbox"/> FAIR	<input type="checkbox"/> UNEXPOSED		

DESCRIBE THE PRESENT AND ORIGINAL (IF KNOWN) PHYSICAL APPEARANCE

The Seaborn M. Shankle House is an 1840s plain-style structure with an 1870s Italianate addition. The house and family cemetery are located on 1.3 acres of land.

The main portion of the Seaborn M. Shankle House was built in the late 1870s as an addition to the west end of an earlier structure. It is a two-story, square building with Italianate ornamentation. It has a low-pitch roof and wide, overhanging eaves with decorative brackets. The front door, located in the center of the front facade, is flanked with sidelights. One window is placed on each side of the front entrance. At the second-story level, three windows are placed directly above the first-story windows and front door. A one-story porch with low-pitch roof spans the front facade of the house. The side porch was added at a later date by Mrs. Victoria Shankle.

The interior has a four-over-four-with-central-hall floor plan. The first-floor rooms contain picture molding and have plastered ceilings. The second-story rooms are void of such molding and have wood ceilings. Several closet doors on the second floor have wood-grain designs painted on them. Two interior fireplaces are located in the house but have not been used since the installation of a gas heating system.

The original structure, attached to the rear of the Italianate structure, was built in the late 1840s. The plain-style structure has one interior fireplace. This structure has two rooms and a screened porch. It presently serves as the kitchen for the Shankle house.

Modern conveniences were added to the house as they became available. The fireplaces were closed when gas heating came into general use. The house was divided into apartments for a short time in the 1940s, but has been returned to its original design.

Also located on the property is a smokehouse that is believed to have been built at the same time as the Italianate addition to the plain-style structure. It is presently vacant. Located to the rear of the house is the Shankle family cemetery. It contains ten to twelve graves. The builder of the Shankle house, Seaborn M. Shankle, and other members of his family are buried here. The cemetery is enclosed by a cast-iron fence of nineteenth-century design.

8 SIGNIFICANCE

PERIOD	AREAS OF SIGNIFICANCE -- CHECK AND JUSTIFY BELOW			
<input type="checkbox"/> PREHISTORIC	<input type="checkbox"/> ARCHEOLOGY-PREHISTORIC	<input type="checkbox"/> COMMUNITY PLANNING	<input type="checkbox"/> LANDSCAPE ARCHITECTURE	<input type="checkbox"/> RELIGION
<input type="checkbox"/> 1400-1499	<input type="checkbox"/> ARCHEOLOGY-HISTORIC	<input type="checkbox"/> CONSERVATION	<input type="checkbox"/> LAW	<input type="checkbox"/> SCIENCE
<input type="checkbox"/> 1500-1599	<input type="checkbox"/> AGRICULTURE	<input type="checkbox"/> ECONOMICS	<input type="checkbox"/> LITERATURE	<input type="checkbox"/> SCULPTURE
<input type="checkbox"/> 1600-1699	<input checked="" type="checkbox"/> ARCHITECTURE	<input type="checkbox"/> EDUCATION	<input type="checkbox"/> MILITARY	<input type="checkbox"/> SOCIAL/HUMANITARIAN
<input type="checkbox"/> 1700-1799	<input type="checkbox"/> ART	<input type="checkbox"/> ENGINEERING	<input type="checkbox"/> MUSIC	<input type="checkbox"/> THEATER
<input checked="" type="checkbox"/> 1800-1899	<input checked="" type="checkbox"/> COMMERCE	<input type="checkbox"/> EXPLORATION/SETTLEMENT	<input type="checkbox"/> PHILOSOPHY	<input type="checkbox"/> TRANSPORTATION
<input type="checkbox"/> 1900-	<input type="checkbox"/> COMMUNICATIONS	<input type="checkbox"/> INDUSTRY	<input type="checkbox"/> POLITICS/GOVERNMENT	<input type="checkbox"/> OTHER (SPECIFY)
		<input type="checkbox"/> INVENTION		

SPECIFIC DATES late 1840s and 1870s

BUILDER/ARCHITECT Unknown

STATEMENT OF SIGNIFICANCE

The Seaborn M. Shankle House is significant to the architectural and commercial history of Harmony Grove, now Commerce, Georgia. It is an example of how rural people created a simplified version of the Italianate style of architecture. The builder of the house, Seaborn M. Shankle, was a contributing factor in the growth of commercial activity in Harmony Grove and was a prominent member of Harmony Grove society.

The design of the Seaborn M. Shankle House employs features of recent architectural trends but displays a reluctance to abandon traditional architectural styles altogether. The exterior of the house is adorned with features associated with the Italianate style of architecture, such as dentils and brackets. The interior, however, employs the traditional early- to mid-nineteenth-century floor plan, rather than a floor plan corresponding to the Italianate style. Also characteristic of traditional styles is the appending of the new structure upon an older house. The older section of the house has some intrinsic value in that it is an example of earlier building techniques.

The builder of the plain-style house and the Italianate addition of the Shankle House, Seaborn M. Shankle (1825-1885), was the youngest son of Eli Shankle. Eli (1784-1852) was one of three pioneers to settle in the area that developed into Harmony Grove in 1808. The Shankle family acquired extensive land holdings in the area, and it was from this extensive property that Seaborn chose to build his home and mercantile business. He was involved in the economic development of Harmony Grove and was a contributing member of the community.

Seaborn M. Shankle was instrumental in establishing commercial activity in Harmony Grove, owning and operating one of the first mercantile establishments in the area. He was involved in two short-lived mercantile business partnerships before he began to operate his own business in the early 1850s. His business was located across from his home on the Athens-Clarkesville Road, a main thoroughfare through Harmony Grove. His shelves were stocked with groceries, notions, dry goods, and plantation supplies. After the Civil War, Shankle built a two-story, wooden building in which he operated his thriving business. He was engaged in business at this place until his death in 1885.

[continued]

6

9 MAJOR BIBLIOGRAPHICAL REFERENCES

Elrod, Frary. Historical Notes on Jackson County, Georgia. 1967
 Hardman, Thomas C. History of Harmony Grove-Commerce, Jackson County, Georgia, 1810-1949. Athens: McGregor Co., 1949.
 Knight, Lucian Lamar. Georgia's Landmarks, Memorials, and Legends, Vol. II. Atlanta: Byrd Printing Co., 1974

10 GEOGRAPHICAL DATA

UTM NOT VERIFIED

ACREAGE OF NOMINATED PROPERTY 1.3 acres

QUADRANGLE NAME Commerce, Georgia

QUADRANGLE SCALE 1:24,000

UTM REFERENCES

A 1,7 2,7,3,7,8,5 3,7,8,7,1,4,0
 ZONE EASTING NORTHING

B
 ZONE EASTING NORTHING

C

D

E

F

G

H

VERBAL BOUNDARY DESCRIPTION:

Refer to enclosed plat map. Boundaries are indicated by a heavy black line.

LIST ALL STATES AND COUNTIES FOR PROPERTIES OVERLAPPING STATE OR COUNTY BOUNDARIES

STATE	CODE	COUNTY	CODE
STATE	CODE	COUNTY	CODE

--	--	--	--

11 FORM PREPARED BY

NAME / TITLE

Kacy Ginn, National Register Researcher

ORGANIZATION

Historic Preservation Section, Ga. Dept. of Natural Resources DATE July 17, 1979

STREET & NUMBER

270 Washington St., S.W.

TELEPHONE

(404) 656-2840

CITY OR TOWN

Atlanta

STATE

Georgia

12 STATE HISTORIC PRESERVATION OFFICER CERTIFICATION

THE EVALUATED SIGNIFICANCE OF THIS PROPERTY WITHIN THE STATE IS:

NATIONAL

STATE

LOCAL X

As the designated State Historic Preservation Officer for the National Historic Preservation Act of 1966 (Public Law 89-665), I hereby nominate this property for inclusion in the National Register and certify that it has been evaluated according to the criteria and procedures set forth by the National Park Service.

STATE HISTORIC PRESERVATION OFFICER SIGNATURE

Elizabeth A. Lyon
 Elizabeth A. Lyon

7

TITLE Acting State Historic Preservation Officer

DATE 9/18/79

FOR NPS USE ONLY

I HEREBY CERTIFY THAT THIS PROPERTY IS INCLUDED IN THE NATIONAL REGISTER

Cheal D. Skell
 KEEPER OF THE NATIONAL REGISTER

DATE 11-29-79

ATTEST:

Leslie A. Dubric
 CHIEF OF REGISTRATION

DATE 11/26/79

UNITED STATES DEPARTMENT OF THE INTERIOR
HERITAGE CONSERVATION AND RECREATION SERVICE

NATIONAL REGISTER OF HISTORIC PLACES INVENTORY -- NOMINATION FORM

FOR HCRS USE ONLY	
RECEIVED	
DATE ENTERED	OCT 2 1979 NOV 29 1979

CONTINUATION SHEET Significance ITEM NUMBER 8 PAGE 2

To increase commercial activity in Harmony Grove, Seaborn M. Shankle was involved in securing the Northeastern Railroad line for Harmony Grove. The location of the railroad was contingent upon the subscription of stock and of securing a right-of-way. Two locations for the line were considered: Harmony Grove and a rival town, Jefferson, the county seat. By the endorsement of large amounts of stock for the railroad, Shankle and two other prominent members of Harmony Grove society, C.W. Hood and Dr. W.B.J. Hardman, enabled their community to become the location of the railroad. After the railroad was completed from Athens to Lula in 1876, Harmony Grove became one of the leading commercial communities in the area. Commercial growth was so great that, in order to reflect the commercial success of the town, Harmony Grove citizens changed the name of their community to Commerce in 1904. The railroad, bought by the Southern Railway System in 1899, continues to serve the citizens of Commerce. Commercial development might have been lessened had it not been for the endorsement of the railroad stock.

After Seaborn Shankle's death in 1885, his wife, Mrs. Victoria P. Shankle, continued to operate the mercantile business for a short time. After her death in 1917, the house and other Shankle property were sold at public auction, as stipulated in her will. Her son, Andrew M. Shankle, bought the family house.

Andrew M. Shankle (1874-1944) worked with the railroad in Commerce in his early career. He was also involved in farming, and eventually became involved in the Northeastern Bank. He retired from the banking business several years before his death in 1944, and the Shankle House became the property of his daughter, Mrs. Ruth Shankle Westbrook.

Mrs. Westbrook and her family lived in the Seaborn M. Shankle House until 1963. Her son, Lloyd Westbrook Jr., and his family lived in the house until the summer of 1976, at which time the house was sold to its present owner, Mrs. Bonita R. Kenny. Mrs. Kenny plans to use the house as an overnight inn, while maintaining its integrity.

DETAIL OF
BLOCK "B"
 SHOWING LINES BETWEEN
 ESTATE OF S. M. SHANKLE AND
 ESTATE OF MRS. VICTORIA SHANKLE AND
 W. D. WILKINSON

WEST PART OF BLOCK "B", ALL OF BLOCK "J" AND ALL OF BLOCK "K" IS THE PROPERTY OF
 THE 5 FOOT ALLEY THROUGH BLOCKS "C" AND "D" IS RESERVED FOR SEW
 EASEMENT FOR MANHOLES ETC.
 TOUCHING THIS ALLEY

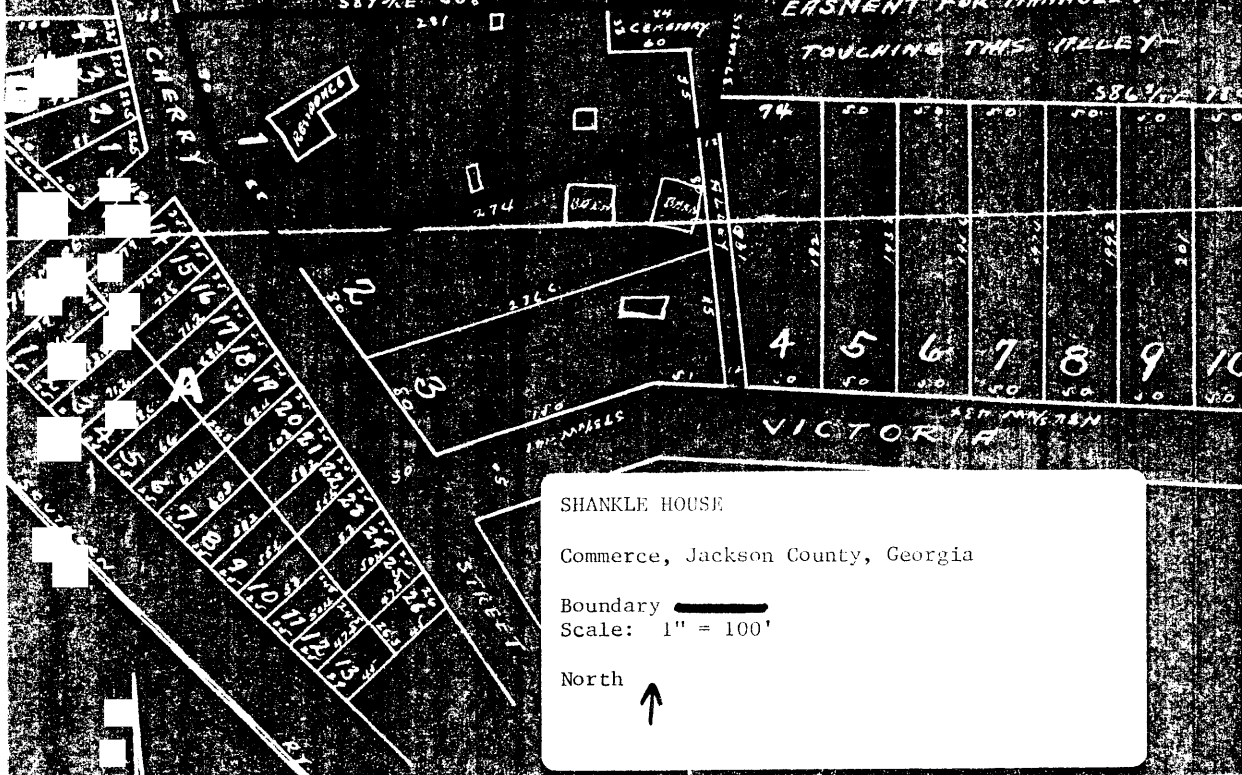

SHANKLE LAND

BELONGING TO
S. M. SHANKLE ESTATE
 AND
MRS. VICTORIA SHANKLE ESTATE

BEING IN THE TOWN OF COMMERCE, JACKSON COUNTY, GEORGIA.

A. M. SHANKLE
 O. E. SHANKLE
 W. D. SHEPPARD
 ADMINISTRATORS.

W. J. Appleby
 SURVEYOR

ENCLAVED BY
 AMERICAN LAND COMPANY
 OF ATHENS, GEORGIA

SCALE, 1 INCH = 100 FEET

- FEBRUARY 27, 1918 -