

UNITED STATES DEPARTMENT OF THE INTERIOR
NATIONAL PARK SERVICE

FOR NPS USE ONLY	
RECEIVED	NOV 24 1980
DATE ENTERED	DEC 8 1980

**NATIONAL REGISTER OF HISTORIC PLACES
INVENTORY -- NOMINATION FORM**

SEE INSTRUCTIONS IN *HOW TO COMPLETE NATIONAL REGISTER FORMS*
TYPE ALL ENTRIES -- COMPLETE APPLICABLE SECTIONS

1 NAME

HISTORIC
Westfield Fire Headquarters
AND/OR COMMON

2 LOCATION

STREET & NUMBER
405 North Avenue West

CITY, TOWN
Westfield

STATE
New Jersey

CONGRESSIONAL DISTRICT
12 th

___ NOT FOR PUBLICATION

___ VICINITY OF

CODE
034

COUNTY
Union

CODE
035

3 CLASSIFICATION

CATEGORY	OWNERSHIP	STATUS	PRESENT USE
<input type="checkbox"/> DISTRICT	<input checked="" type="checkbox"/> PUBLIC	<input checked="" type="checkbox"/> OCCUPIED	<input type="checkbox"/> AGRICULTURE
<input checked="" type="checkbox"/> BUILDING(S)	<input type="checkbox"/> PRIVATE	<input type="checkbox"/> UNOCCUPIED	<input type="checkbox"/> MUSEUM
<input type="checkbox"/> STRUCTURE	<input type="checkbox"/> BOTH	<input type="checkbox"/> WORK IN PROGRESS	<input type="checkbox"/> COMMERCIAL
<input type="checkbox"/> SITE	PUBLIC ACQUISITION	ACCESSIBLE	<input type="checkbox"/> EDUCATIONAL
<input type="checkbox"/> OBJECT	<input type="checkbox"/> IN PROCESS	<input checked="" type="checkbox"/> YES: RESTRICTED	<input type="checkbox"/> ENTERTAINMENT
	<input type="checkbox"/> BEING CONSIDERED	<input type="checkbox"/> YES: UNRESTRICTED	<input checked="" type="checkbox"/> GOVERNMENT
		<input type="checkbox"/> NO	<input type="checkbox"/> RELIGIOUS
			<input type="checkbox"/> INDUSTRIAL
			<input type="checkbox"/> MILITARY
			<input type="checkbox"/> PRIVATE RESIDENCE
			<input type="checkbox"/> TRANSPORTATION
			<input type="checkbox"/> OTHER:

4 OWNER OF PROPERTY

NAME
Town of Westfield

STREET & NUMBER
425 East Broad Street

CITY, TOWN
Westfield

STATE
New Jersey

___ VICINITY OF

5 LOCATION OF LEGAL DESCRIPTION

COURTHOUSE,
REGISTRY OF DEEDS, ETC.
Union County Courthouse

STREET & NUMBER

CITY, TOWN
Elizabeth

STATE
New Jersey 07207

6 REPRESENTATION IN EXISTING SURVEYS

TITLE
New Jersey Historic Sites Inventory

DATE

___ FEDERAL STATE ___ COUNTY ___ LOCAL

DEPOSITORY FOR
SURVEY RECORDS
Office of Historic Preservation

CITY, TOWN
Trenton

STATE
New Jersey

7 DESCRIPTION

CONDITION		CHECK ONE	CHECK ONE
<input type="checkbox"/> EXCELLENT	<input type="checkbox"/> DETERIORATED	<input type="checkbox"/> UNALTERED	<input checked="" type="checkbox"/> ORIGINAL SITE
<input type="checkbox"/> GOOD	<input type="checkbox"/> RUINS	<input checked="" type="checkbox"/> ALTERED	<input type="checkbox"/> MOVED DATE _____
<input checked="" type="checkbox"/> FAIR	<input type="checkbox"/> UNEXPOSED		

DESCRIBE THE PRESENT AND ORIGINAL (IF KNOWN) PHYSICAL APPEARANCE

The Westfield Fire House is located at 405 North Avenue West in the Central Business District. The building was constructed in 1911 and since that time has been occupied by the Westfield Fire Department. It is a two story brick structure with a four story side tower. The exterior is well proportioned and carefully detailed. Its overhanging eaves carried completely around the building produce a neat simple appearance. The roof is tile. Windows have carefully articulated brick arches over them and the bell tower designed and so located to produce a graceful architectural composition. The cupola, however, was destroyed by lightning and replaced by a radio antenna. Also, the original swing out decorative wood doors were changed to steel to accommodate modern fire fighting equipment. These changes do not detract seriously from the original design.

The street facade has four engine bays on the first floor. There is a single wide entrance door in the rear to originally simplify re-entry into the firehouse when horse-drawn fire apparatus was utilized. The small four inch square blocks with deep grooves and runoff features provided easier maintenance and traction for the horses. The bays are divided by occasional columns.

The major room configurations of the second floor are intact. There is a fireman's exempt room, a kitchen, two bathrooms, and two activity rooms.

The interior of the building is essentially the same today as when it was built. The few minor changes made are a dropped ceiling added in the kitchen area, three slide poles blocked off and the original wood stairs are now of steel.

It is interesting to note, that the 30 inch wide flange structural steel members used in this building were among the first in this country of this depth, and were fabricated by Bethlehem Steel Company. The increased depth of these members over previous ones made possible increased spans in building construction, permitting a greater flexibility in future architectural design.

8 SIGNIFICANCE

PERIOD AREAS OF SIGNIFICANCE -- CHECK AND JUSTIFY BELOW

<input type="checkbox"/> PREHISTORIC	<input type="checkbox"/> ARCHEOLOGY-PREHISTORIC	<input type="checkbox"/> COMMUNITY PLANNING	<input type="checkbox"/> LANDSCAPE ARCHITECTURE	<input type="checkbox"/> RELIGION
<input type="checkbox"/> 1400-1499	<input type="checkbox"/> ARCHEOLOGY-HISTORIC	<input type="checkbox"/> CONSERVATION	<input type="checkbox"/> LAW	<input type="checkbox"/> SCIENCE
<input type="checkbox"/> 1500-1599	<input type="checkbox"/> AGRICULTURE	<input type="checkbox"/> ECONOMICS	<input type="checkbox"/> LITERATURE	<input type="checkbox"/> SCULPTURE
<input type="checkbox"/> 1600-1699	<input checked="" type="checkbox"/> ARCHITECTURE	<input type="checkbox"/> EDUCATION	<input type="checkbox"/> MILITARY	<input type="checkbox"/> SOCIAL/HUMANITARIAN
<input type="checkbox"/> 1700-1799	<input type="checkbox"/> ART	<input type="checkbox"/> ENGINEERING	<input type="checkbox"/> MUSIC	<input type="checkbox"/> THEATER
<input type="checkbox"/> 1800-1899	<input type="checkbox"/> COMMERCE	<input type="checkbox"/> EXPLORATION/SETTLEMENT	<input type="checkbox"/> PHILOSOPHY	<input type="checkbox"/> TRANSPORTATION
<input checked="" type="checkbox"/> 1900-	<input type="checkbox"/> COMMUNICATIONS	<input type="checkbox"/> INDUSTRY	<input checked="" type="checkbox"/> POLITICS/GOVERNMENT	<input type="checkbox"/> OTHER (SPECIFY)
		<input type="checkbox"/> INVENTION		

SPECIFIC DATES 1911 BUILDER/ARCHITECT John Goltra/Charles H. Darsh

STATEMENT OF SIGNIFICANCE

Showing influences of Spanish, Italianate and Mediterranean architecture, the Westfield Fire House is a fine example of 20th century civic architecture.

Westfield Fire Headquarters was recognized at the time of construction as one of the best appointed fire houses in the metropolitan area. It combines utilitarian usefulness with fine architectural features and has been a point of civic pride for many years. Touted as one of the "conveniences of a progressive and well ordered community and an ideal hometown" when built, the Westfield firehouse was an important factor in convincing people to this rapidly developing suburb. *move to*

The most obvious point of interest is the Tower, which is a reminder of fire-fighting practices of a bygone age. The Tower was used in the early 1900's to dry the cotton covered fire hoses before returning them to their storage area. The advent of polyester covered fire hoses (on which no fungus can grow) has obviated this practice.

From the very beginning the firehouse was a point of civic pride as evidenced by the "Westfield Leader." The issue dated May 17, 1911 prominently displays the firehouse in an article entitled "Boost Westfield." The delight that was manifest at the opening of the firehouse can be seen in the first paragraph of an article entitled "Banquet a Success at New Fire House" in the May 13, 1911 issue of the same publication. The first sentence of that article reads: "Monday, May 29, 1911 must be placed in Westfield's history as one of the most important dates of all time."

The article continues, "First, it marked the official opening of one of the handsomest firehouses in any town in this country. Secondly, it made clear that the men in the department are the finest to be obtained. In the third place, it marked the beginning of the era of new apparatus for Westfield, so that the town will be second to none of its size, and lastly, it brought together the official life of Westfield into one happy, congenial family such as has never been experienced before. Monday, May 29th, 1911 is an important date."

9 MAJOR BIBLIOGRAPHICAL REFERENCES

Westfield Exempt Fireman's Association, 100 Years Westfield Fire Department 1875-1975, Kenilworth, NJ, 1975 (Data compiled by Alfred H. Linden).

Westfield Leader, March 29, 1911; July 6, 1939.

ACREAGE NOT VERIFIED

(See Continuation Sheet)

10 GEOGRAPHICAL DATA

UTM NOT VERIFIED

ACREAGE OF NOMINATED PROPERTY less than 1

QUADRANGLE NAME Roselle, NJ

QUADRANGLE SCALE 1:24,000

UTM REFERENCES

A 18 555060 4499900
ZONE EASTING NORTHING

B
ZONE EASTING NORTHING

C

D

E

F

G

H

VERBAL BOUNDARY DESCRIPTION

Block 401, Lot 9

LIST ALL STATES AND COUNTIES FOR PROPERTIES OVERLAPPING STATE OR COUNTY BOUNDARIES

STATE	CODE	COUNTY	CODE
STATE	CODE	COUNTY	CODE

11 FORM PREPARED BY

Revised by T. Karschner, Office of Historic Preservation

NAME / TITLE

Bernard A. Heeney, Jr., Administrative Service Analyst

ORGANIZATION

Town of Westfield

DATE

1/3/80

STREET & NUMBER

425 East Broad Street

TELEPHONE

232-8000

CITY OR TOWN

Westfield

STATE

New Jersey 07090

12 STATE HISTORIC PRESERVATION OFFICER CERTIFICATION

THE EVALUATED SIGNIFICANCE OF THIS PROPERTY WITHIN THE STATE IS:

NATIONAL

STATE

LOCAL X

As the designated State Historic Preservation Officer for the National Historic Preservation Act of 1966 (Public Law 89-665), I hereby nominate this property for inclusion in the National Register and certify that it has been evaluated according to the criteria and procedures set forth by the National Park Service

Deputy

STATE HISTORIC PRESERVATION OFFICER SIGNATURE

Laura Schmitt 10/3/80

TITLE

DATE

FOR NPS USE ONLY

I HEREBY CERTIFY THAT THIS PROPERTY IS INCLUDED IN THE NATIONAL REGISTER

KEEPER OF THE NATIONAL REGISTER

DATE 12-7-80

ATTEST: *Emma Jane Saxe*

CLERK OF REGISTRATION

DATE 12-5-80

**NATIONAL REGISTER OF HISTORIC PLACES
INVENTORY -- NOMINATION FORM**

FOR HCRS USE ONLY	
RECEIVED	NOV 4 1980
DATE ENTERED	DEC 8 1980

Westfield Fire Headquarters, Union County NJ

CONTINUATION SHEET

ITEM NUMBER

8

PAGE

1

Significance (continued)

The "new apparatus" referred to in the above paragraph was "motor propelled apparatus" which would shortly replace the horse drawn equipment.

Architecture

"Charles H. Darsh (1869-1939) a native of Westfield, was educated in local schools. He studied architecture at Cooper Union and Atillee of Emanuel Masquereau. He was associated as a designer with the architects Bruce and Price of New York; Baldwin and Pennington of Baltimore. He maintained an office in Cranford, New Jersey and designed numerous public and commercial buildings throughout Union County.

Darsh was a member of the American Institute of Architects, the Gargoyles of New York; New York Sketch Club and the Rotary Club. He was a charter member of the Westfield Art Association being well known for his water colors, and attended the Presbyterian Church.

**United States Department of the Interior
Heritage Conservation and Recreation Service**

**National Register of Historic Places
Inventory—Nomination Form**



Westfield Fire Headquarters, Union County, NJ

Continuation sheet

Item number 9

Page 1

Westfield Leader, May 17, 1911.

Westfield Leader, May 31, 1911.

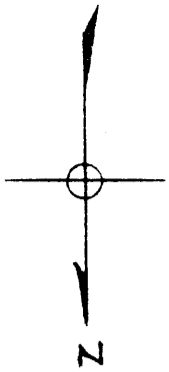

SHED

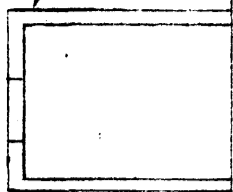

ROLL UP DOOR

UP

UP

POLE

ROLL UP DOORS

NORTH AVENUE

FIRST FLOOR PLAN

SCALE 1/8" = 1'-0"

FIRE HOUSE - TOWN OF WESTFIELD
UNION COUNTY - NEW JERSEY

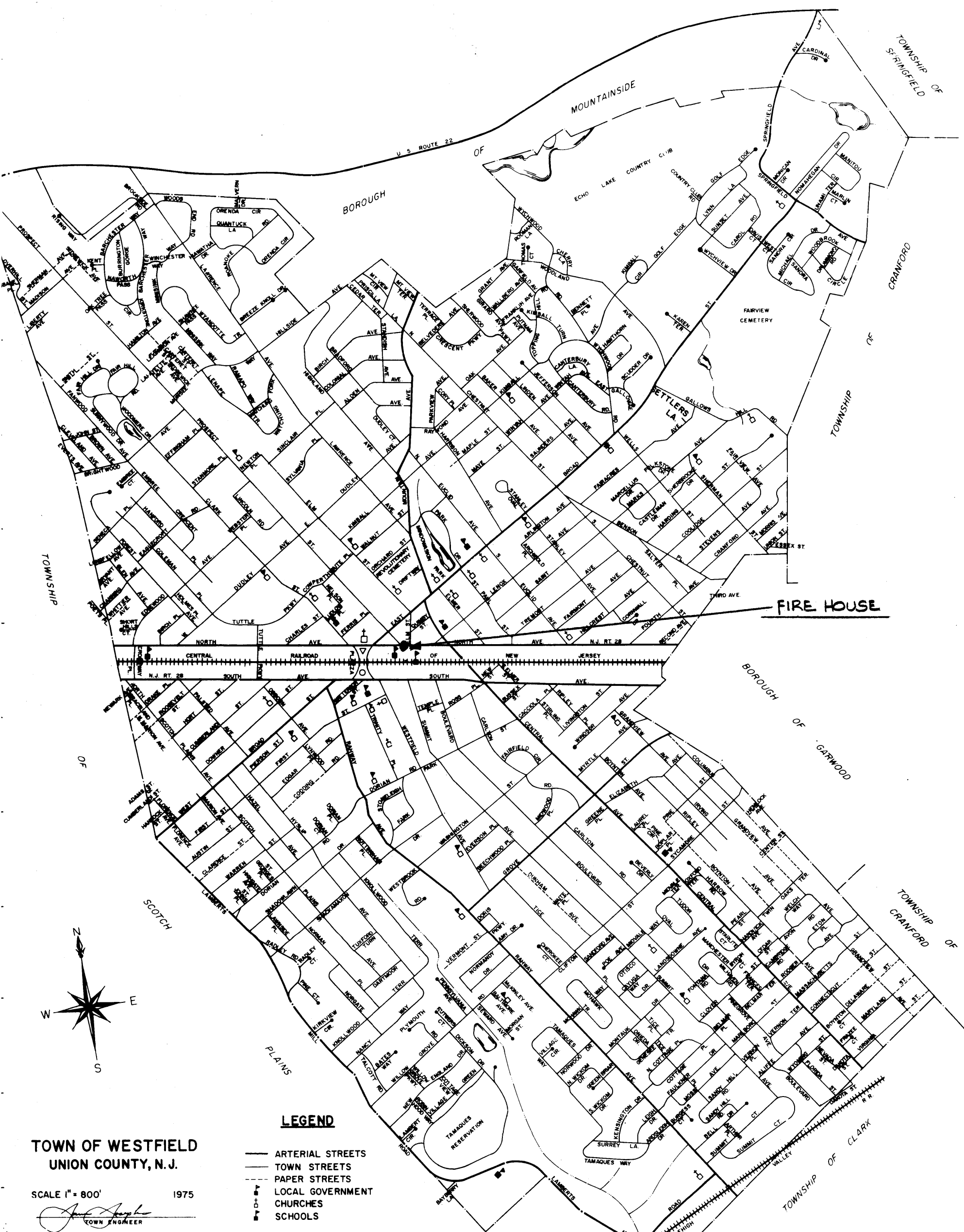

**TOWN OF WESTFIELD
UNION COUNTY, N.J.**

SCALE 1" = 800' 1975

James L. ...
TOWN ENGINEER

LEGEND

- ARTERIAL STREETS
- TOWN STREETS
- - - PAPER STREETS
- LOCAL GOVERNMENT
- CHURCHES
- SCHOOLS

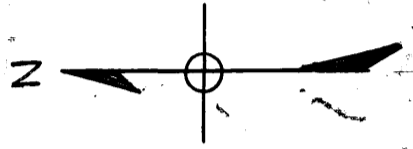

F. BROAD ST.

PROSPECT ST.

FLM ST.

SHEET NO. 55

NORTH AVENUE

FIRE HOUSE WESTFIELD
UNION COUNTY, N.J.

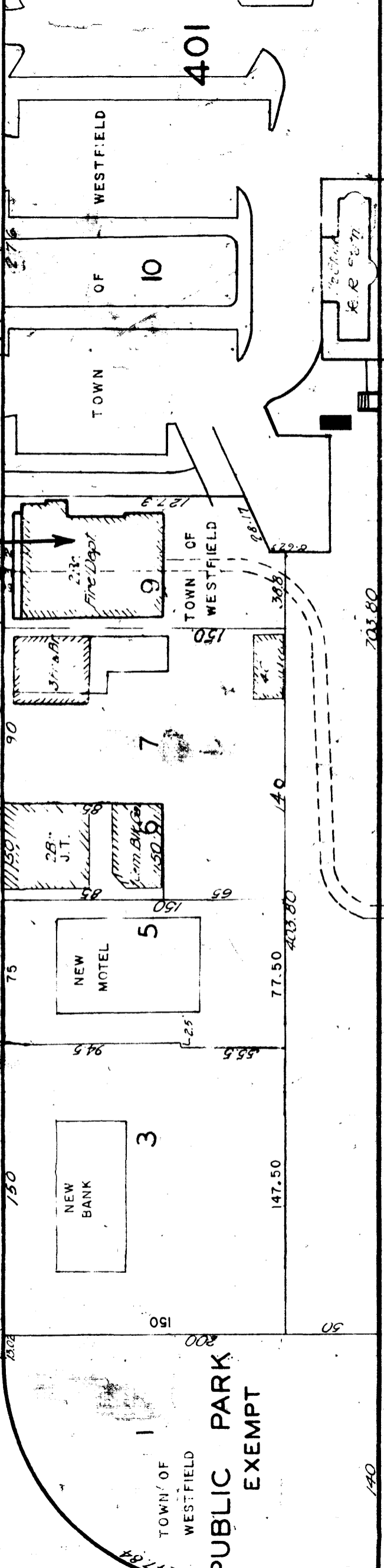

CENTRAL RAILROAD

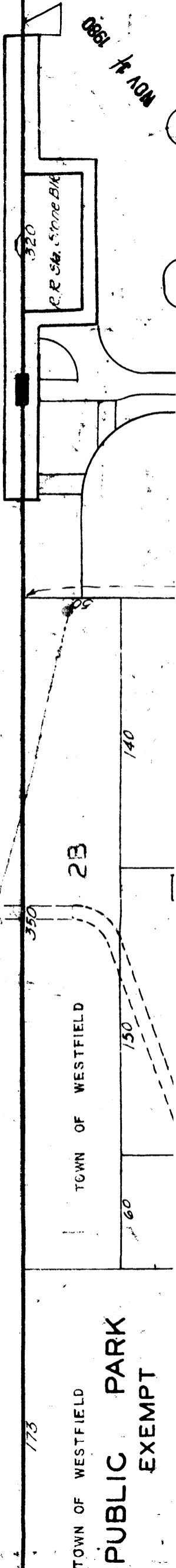

NOV 16 1908