

United States Department of the Interior
National Park Service

DEC 17 1992

MAR 04 1993

National Register of Historic Places
Registration Form

NATIONAL
REGISTER

This form is for use in nominating or requesting determinations of eligibility for individual properties or districts. See instructions in *Guidelines for Completing National Register Forms* (National Register Bulletin 16). Complete each item by marking "x" in the appropriate box or by entering the requested information. If an item does not apply to the property being documented, enter "N/A" for "not applicable." For functions, styles, materials, and areas of significance, enter only the categories and subcategories listed in the instructions. For additional space use continuation sheets (Form 10-900a). Type all entries.

1. Name of Property

historic name Sausalito Woman's Club
other names/site number N/A

2. Location

street & number 120 Central Avenue N/A not for publication
city, town Sausalito N/A vicinity
state California code CA county Marin code 041 zip code 94965

3. Classification

| | | | |
|---------------------------------------------|-------------------------------------------------|-------------------------------------|---------------------|
| Ownership of Property | Category of Property | Number of Resources within Property | |
| <input checked="" type="checkbox"/> private | <input checked="" type="checkbox"/> building(s) | Contributing | Noncontributing |
| <input type="checkbox"/> public-local | <input type="checkbox"/> district | <u>1</u> | <u>0</u> buildings |
| <input type="checkbox"/> public-State | <input type="checkbox"/> site | <u>0</u> | <u>0</u> sites |
| <input type="checkbox"/> public-Federal | <input type="checkbox"/> structure | <u>0</u> | <u>0</u> structures |
| | <input type="checkbox"/> object | <u>0</u> | <u>0</u> objects |
| | | <u>1</u> | <u>0</u> Total |

Name of related multiple property listing:
N/A

Number of contributing resources previously listed in the National Register 0

4. State/Federal Agency Certification

As the designated authority under the National Historic Preservation Act of 1966, as amended, I hereby certify that this nomination request for determination of eligibility meets the documentation standards for registering properties in the National Register of Historic Places and meets the procedural and professional requirements set forth in 36 CFR Part 60. In my opinion, the property meets does not meet the National Register criteria. See continuation sheet.

Signature of certifying official *Stade R. Craig* Date 2/23/93
California Office of Historic Preservation
State or Federal agency and bureau

In my opinion, the property meets does not meet the National Register criteria. See continuation sheet.

Signature of commenting or other official _____ Date _____
State or Federal agency and bureau _____

5. National Park Service Certification

I, hereby, certify that this property is:

entered in the National Register. *Patrick Andrews* 4/15/93
 See continuation sheet.

determined eligible for the National Register. See continuation sheet.

determined not eligible for the National Register.

removed from the National Register.

other, (explain:)

Signature of the Keeper _____ Date of Action _____

6. Function or Use

Historic Functions (enter categories from instructions)

SOCIAL

Clubhouse

Current Functions (enter categories from instructions)

SOCIAL

Clubhouse

7. Description

Architectural Classification

(enter categories from instructions)

Craftsman

Other: Bay Area Tradition

Materials (enter categories from instructions)

foundation CONCRETE

walls WOOD:

Redwood Shingle

roof OTHER

Tar and gravel

other

Describe present and historic physical appearance.

The Sausalito Woman's Club, a 1918 Julia Morgan, A.I.A. designed building, located at 120 Central Avenue, Sausalito, Ca., is sited on a 1/5 acre sloping downhill lot, located in a residential area of woody estate homes. In keeping with the character of the neighborhood, the landscaping creates an inviting locale. The grounds are hedged on the north street side; the entrance is brick terraced; between the brick terrace and the hedge is a lawn and three original stately oak trees. The building, which is a one and one-third story redwood shingle Craftsman Style in the Bay Area Tradition, is surrounded by a landscaped garden of predominately native plants. The original 1918 building consisted of an auditorium with raised stage an entry hall, a reception room and kitchen and bath. The upper story, consisting of two dressing rooms, each with half bath, an enlarged sunporch on the east side, and under-the stage dressing rooms were added in 1923 under the design and construction supervision of Julia Morgan, A.I.A. The building of wood frame construction is considered small being overall approximately 4,595 sq. ft.; it is the only structure on the property. The exterior has been virtually unchanged from 1923 except for a six foot addition on the southwest wall of the kitchen in 1936 and a 10 x 5 foot addition on the northeast corner in 1938 for storage. The original interior finishes are intact, hence, the ambience created by Julia Morgan in 1918 remains today. The exterior appearance of the building has survived virtually unchanged for the past seventy years.

EXTERIOR

The notations that follow use compass points to refer to facades: west being the entrance facade, south, the kitchen side, east the rear sun porch and north the stage end of the building.

National Register of Historic Places Continuation Sheet

Section number 7 Page 2

Sausalito Woman's Club Marin County Ca.

The Sausalito Woman's Club is a small Craftsman Style wood frame Clubhouse. The first floor consists of an auditorium with raised stage and side rooms at north end, a glassed in sun porch on the east side, and an entry hall, reception room, kitchen and bathroom at south end. Below the first floor is a basement and stage dressing rooms. Upstairs are two guest dressing rooms and two bathrooms.

The building is located on a 1/5th acre sloping lot at 120 Avenue, in a residential neighborhood of woodsy estate homes. The building is set back away from the street with an adjacent outdoor brick terrace, and lawn. Three beautiful old oak trees and mature landscaping protect its privacy. The informal open plan fuses the outside of the structure with the inside.

Julia Morgan A.I.A. designed the building in 1918 and was paid 280.00 for the drawings. It was built by A.W. Teather, Carpenter and Builder, 405 Cazneau, Sausalito, who subsequently did all the 1923 improvements, and any repairs until 1936. The cost of the original construction was \$5,727.50.

The building is deceptively simple-almost as though master carpenters built it without benefit of drawings. But the control of light and structure reveals Miss Morgan's sure hand.

The Clubhouse is an irregular rectangle with 18 corners. It is one and one third stories, covered with 6"x 36" redwood barn board shingles.

The Clubhouse is on a downslope and the main entry is a step above ground level. The exits on the east and south facades each have a flight of stairs, neither is original.

West Facade.

This facade has five different offsets. About a foot off the foundation, 3 pairs of 10-light french doors are centered in the building's main facade and open into the auditorium. Each door has a four-light clerestory above it.

National Register of Historic Places Continuation Sheet

Section number 7 Page 3

Sausalito Woman's Club Marin County Ca.

Nine ft. to the south of the french doors the building projects ten ft. The front door is centered here, and is the focal point of the building. It is a massive 3'7" arched redwood door, constructed with a chevron panel design. The frame is a six inch plain molding. There are three other windows on the north side. A sixteen-light at 90 to the front door in the entry hall, a 3-light at the main floor bath, and an 8-light at the east end side stage room.

The west facade has a redwood belt course or band, comprised of a 2"x 2" over a 1"x 8" in line with the molding between the french doors and the clear story. This band extends horizontally along the north and south facade.

The Clubhouse has a low rise side gabled roof (2-1/2" in 12" pitch). It is tar and gravel with a 2-1/2 ft. overhang. The underside of the roof overhang echoes the interior paneling of the building. It is redwood board and batten.

Rising out of the roof on the south end of the west facade is the 17'x 43' addition Julia Morgan designed in 1923. Its low gable roof is perpendicular to the original roof. This level has three windows, two with 12-lights and one with 4-lights.

The french door portion and the front door portion are original, as built in 1918. At the extreme south end is six feet of windowless shingle wall, which is an exterior kitchen wall. From records, it looks as though this kitchen addition was done in the 1920's.

South Facade

This facade also has 5 different setbacks. The western end is the kitchen. The kitchen windows are aluminum sliding, installed in the 1968 remodel. The plumbing pipes are still on the outside of the building. The kitchen was expanded eastward in 1937. The exterior of the chimney, is one wall of the small kitchen porch that leads to the exit stairs. The chimney brick extend two feet above the roof line.

National Register of Historic Places Continuation Sheet

Section number 7 Page 4

Sausalito Woman's Club Marin County Ca.

Back to the North 10'-3" from the kitchen is the reception room wall. There are three basement level windows, and basement door at ground level. To the right of the chimney and above the basement windows are three pair of 8-light casement windows with 2-light clerestory above each. These are original windows, with the same trim as the french doors on the west. Back 16'-6" from the reception room wall is the sun porch.

The open area under the sunporch is covered with lath. The sunporch has two pair of 8-light casement windows with 2-light clerestory above each. These windows were replaced in 1982 to match the originals.

On the second floor, there are a pair of six-light windows in the stairwell and also in the east guest dressing room. There are also 3 small casement windows.

East Facade. This facade has four different setbacks.

To the extreme south set back 22ft. from the sunporch is exterior kitchen wall. The southeast corner which is the exterior of the fireplace room portion of the building has the original windows, trim, and shingles and board and batten overhang as the north facade. The board room above, is original from 1923, except that the windows were replaced in 1982 to match the originals.

The balance of the east face is the enclosed sunporch. Beneath the sun porch is an open area enclosed with lathe. There are stairs exiting at the north end. The sunporch has six pairs of 8-light windows with clerestory above, replaced in 1982 to match originals. There is an exit door and stairs near north end.

In 1923 the wide porch overlooking San Francisco Bay was enlarged, and a door was added at two feet above ground level beyond the porch as an exit for the beneath the stage dressings rooms. Julia Morgan designed this addition, and work performed by A.W. Teather.

In 1928 the sunporch was glazed by A.W. Teather, the Contractor who built the building.

In 1938 a 10x 5 foot addition was made to the northeast corner for storage.

United States Department of the Interior
National Park Service

**National Register of Historic Places
Continuation Sheet**

Section number 7 Page 5

Sausalito Woman's Club Marin County Ca.

North Facade

The slope of the lot creates two stories on the north facade. This is the back side of the stage area. The 3 windows beneath the stage area were installed in 1923 when "new dressings rooms for theatricals have been built beneath the stage, making it more convenient for the players to change." The same french doors as at the entry on the West Facade, without the clear lights are here, with a 4 ft. balcony. There are 8 beams to support the balcony, each with a carved bracket.

Except for the 10' addition in the far northeast corner in 1938, and the windows beneath the stage, added in 1923 this facade is in its original condition.

National Register of Historic Places Continuation Sheet

Section number 7 Page 6

Sausalito Woman's Club Marin County Ca.

INTERIOR

The all redwoods interior is intact and has not been painted or replaced.

Entering through the chevron paneled front door one is in the entry hall that leads to the auditorium, the reception room, the kitchen, and an under the stairs bath. Directly ahead 6' from the front door are the redwood stairs to the upstairs dressing rooms. The walls in the understairs bath are 1-1/2" redwood tongue and groove. They have never been painted, or upgraded in any way. There is a large mirror to the left of the entry, with a redwood shelf. The same molding pattern to hold up the shelf is used as a decorative railing on the stairs.

The flooring is oak strip in the auditorium, on the stage, in the entry hall and reception room. The base board on the entire Club is 1"x 11" redwood plank. The walls throughout are 12" redwood boards with 2-1/2 "x 1" battens. The vertical trim on the windows and doors extends from baseboard to crown molding overlaying the interior band.

The raised stage at the north end is 19'3" x 10'8". There are small rooms on either side of the stage. The doors leading to the auditorium on either side of the stage are two panel with unusual molding. The stairs at both doors are detached and portable. Rising from the battens at either end of the stage is an arched opening with surrounding molding.

The auditorium is 33ft. long by 31 ft. wide. It can seat 150 people in folding chairs.

The entry to the sunporch from the auditorium has 4-light clerestory interior windows above the band that runs around the room. There are no doors below. Upon careful examination of this wall from the sunporch side, one can see the exterior shingles that still remain from 1918, when this wall was an exterior wall. From Sausalito Woman's Club minutes, and newspaper reports on enlarging the porch, the east facade originally mirrored the west facade, with a small porch to look out to San Francisco Bay, before the first alteration in 1923.

National Register of Historic Places Continuation Sheet

Section number 7 Page 7

Sausalito Woman's Club Marin County Ca.

The interior french doors between the auditorium and reception room repeat the light pattern of the west facade french doors. The doors to the left of center are missing. The 4" band on all interior main floor room walls is at exactly the same level as the molding around the exterior west, north and south facade.

The outstanding features of the auditorium are the exposed 2" x 6' rafters and the very elegant redwood trusses that run the length of the room, supporting the rafters. The ceiling peaks at 17 ft. The quatrefoil cutouts at both ends of the trusses, are repeated in the four 2-1/2' light fixtures that hang from the truss.

These light fixtures, designed by Julia Morgan are repeated with two in reception room and one in entry hall.

The fireplace is 7 ft. wide with a simple horizontal brick pattern. The simple redwood mantle is at 4' 3" with vertical board and batten above. The hearth is a darker glazed brick. The fireplace screen was designed by Julia Morgan, and made by one of her craftsmen.

Both the reception room and the auditorium have built in corner benches. The detailed redwood molding below the bench is repeated on the stairs to the upper level and under the ledge of the entry mirror.

Access to the kitchen is through the reception hall. It is L shaped, about 20' long and 18' wide at the base of the L. The kitchen has been added on to and upgraded many times. With two sinks, two cook tops, two ovens and a commercial refrigerator, it is used at weddings, and dinners for up to 175 people. It is not historic.

The upstairs 1923 addition consists of two dressing rooms each with half bath. The floor is pine, and the walls are redwood board and batten, with window seats. The ceilings are exposed 2" x 6" rafters. The east dressing room has views of San Francisco and the bay from the south, east, and north.

United States Department of the Interior
National Park Service

National Register of Historic Places Continuation Sheet

Section number 7 Page 8

Sausalito Woman's Club Marin County Ca.

There is a the large basement underneath the auditorium, that contains two furnaces, water heaters and storage. Under the stage are the two dressing room for "players" that can only be reached from stairs through a trap door at stage level or from the exterior at the east side of the club. The overall area of the understage dressing rooms is 10 ft. x 36 ft. This was added in 1923, under the direction of Miss Morgan. All the walls are 1- 1/2" tongue and groove redwood.

Due to Miss Morgan's skillful handling of unpainted redwood the Clubhouse has a genuinely warm and inviting quality about it, and certainly ranks as one of the most charming structures in Sausalito. The Club now 74 years old is remarkably well preserved. The Clubhouse was declared Sausalito Historical Landmark #1 in 1976.

Existing conditions drawings were prepared in 1991 by a local architect using AUTOCAD. They are available on a disc.

8. Statement of Significance

Certifying official has considered the significance of this property in relation to other properties:

nationally statewide locally

Applicable National Register Criteria A B C D

Criteria Considerations (Exceptions) A B C D E F G

Areas of Significance (enter categories from instructions)
SOCIAL HISTORY

Period of Significance
1918-1943

Significant Dates
N/A

Cultural Affiliation
N/A

Significant Person
N/A

Architect/Builder Morgan, Julia, A.I.A.
Architect:
Builder: Teather, A.W.

State significance of property, and justify criteria, criteria considerations, and areas and periods of significance noted above.

The Sausalito Woman's Club, a 1918 Julia Morgan A.I.A. designed building is historically significant in the area of social history for the importance the club played in the civic and cultural life of Sausalito since its inception in 1913. For the purposes of this application we have ended the period of significance arbitrarily in 1943, based on the National Register's policy of not listing properties for events that have occurred in the last fifty years. The Clubhouse played a significant role as the cohesive element that kept these women together to promote the welfare of society in Sausalito. During World War I The Sausalito News dated September 21, 1918 aptly recorded the dedication of the new Clubhouse on Sept. 14. "It is the aim and desire of the Club that this home may minister to the life of the community in every way, standing for improvement in our civic, social and municipal affairs as well as our varied and ever increasing war activities". They ministered to the life of the community through an emphasis on Civics, Outdoor Art (Conservation) and Music, Art, and Literature.

The Sausalito Woman's Club is historically significant as a center of thought and action for the betterment and beautification of the City of Sausalito. In 1913 Sausalito had winding dirt roads, 2,800 people, one saloon for every 100 persons, prize fights, gambling dens and more. That year ten fine, strong-willed women with diversified interests founded the Sausalito Woman's Club; they were determined to clean up the town.

The Clubhouse played a significant role as the cohesive element that kept these women together to act as a strong force in Sausalito. The two time periods - the beginning of the Woman's Movement and the Sausalito Woman's Club - coincide.

See continuation sheet

National Register of Historic Places Continuation Sheet

Section number 8 Page 2 Sausalito Woman's Club Marin County Ca.

From the beginning the Club members wanted to have a meeting place of their own. The Club members worked diligently to raise money for a building. During this period Mr. Frederick A. Robbins, President of the Bank of Sausalito donated \$1 for each \$1 raised by members at bazaars, selling olive oil from door to door, musical events, whist parties etc. In five years from 1913 to 1918 the Club accumulated \$2,000.00

In 1917 Mr. Frederick Robbins made the Woman's Club a gift of land in the memory of his wife Grace McGregor Robbins. This beautiful site is located at 120 Central Avenue, in a residential neighborhood. The Clubhouse is dedicated to Mrs. Robbins, who was one of the first Directors of the Club.

The Sausalito News edition of August 18, 1917 stated "The site is thus a happy selection as it was Mrs. Robbins expressed desire that the clubhouse be used not only for club purposes but that it became a center for everything that would serve the pleasure and betterment of the people of Sausalito. The women of the Club earnestly hope that the clubhouse may become a real civic center. The auditorium will always be available for dances, entertainments, bazaars, lectures, public meetings etc."

Using the same ideals, that founded the Club, the members chose Julia Morgan to be their architect. Morgan was the first woman to graduate from the University of California at Berkeley with a degree in Civil Engineering (1894). While there, she became the protege of architect Bernard Maybeck. With his support she attended the Ecole des Beaux Arts in Paris and was the first woman to receive a masters degree from that prestigious institution. She became licensed in California in 1904. Two of the Club members, Mrs. Arthur Pierson, and Mrs. James Lanagan were close personal friends of Miss Morgan.

Julia Morgan may have been at her best providing architectural encouragement for community activity. The clubhouse was completed in 1918. At the first meeting, Sept. 5, 1918 there were no chairs, consequently each member had to bring her own chair. The setting of the Sausalito Woman's Club served well for discussions of the progressive ideals in education and reform which were women's special province.

National Register of Historic Places Continuation Sheet

Section number 8 Page 3

Sausalito Woman's Club Marin County Ca.

Club by-laws, article II which was written in 1913 states, " The purpose of the Sausalito Woman's Club, shall be to preserve the beauty of Sausalito, to aid through organized effort such worthy causes as may enlist its sympathies and to create a center of thought and action among the people for the promotion of whatever tends for the best interests of this town."

Club activities emphasized Civics, Outdoor Art (Conservation), and Music, Art and Literature.

CIVICS

When women won their vote in California on October 10, 1911 the Sausalito women tried to assert their new political rights, but they had little success. The town Board of Trustees were very hostile to women who came to city meetings. They would conduct the meetings in whispers and move the meeting place when they saw the women coming. Succumbing to pressure from these same women who were now Club members, town business was finally conducted in the open in 1914. The Civics Committee assiduously attended town meetings and reported back to the Club at monthly meetings, as is still done today.

Another 44 years went by before a woman was elected to serve on the City Council. Club member Marjorie Brady served from 1958 to 1962. To insure her election club members held coffees and sent postcards on her behalf. Today 3 of the 5 Council members are women, and they too are Club members. Each election year a candidates night is held at the Club. It is also a polling place for every election.

From 1917 to 1937 repeated attempts were made by fish canning operators to locate a plant to can sardines in Sausalito. The Woman's Club fought it all the way until the the sardines disappeared from the bay. Theses letters mentioned, don't do justice to the strong feeling and force the members used in Sausalito during these twenty years to prevent the cannery from coming here.

National Register of Historic Places Continuation Sheet

Section number 8 Page 4

Sausalito Woman's Club, Marin County Ca.

In 1917 Miss Fanny Shoobert wrote to Mr. Weinstock of the Sausalito Fish Commission complaining of the unsatisfactory fish situation. In January of 1928, they were so concerned they made a visit to the Monterey Fish Canning area, eliciting the written opinions of the Club Women of the Monterey area. One Monterey woman wrote, "At times it is almost unlivable for many blocks around when these nauseating odors are turned loose on the air" We still have the original letters. In February 1928 the Club wrote to the Board of Trustees of Sausalito going on record as being definitely opposed to establishing a fish-cannery in Sausalito.

In 1937 the Gardenia Packing Co. talked the Town Council into allowing the "odor free" fish reduction boat the "Brookdale" to dock in Sausalito. Again the Woman's Club was "vigorously opposed to the establishment of any and all fish reduction boats or plants, or fish canning boats or plants in or near Sausalito" The "Brookdale" was in Sausalito about 2 weeks, the odor caused such a furor, it was the last time a permit for this operation was ever allowed, and besides the sardines disappeared.

The Club was one of the founding sponsors of the Sausalito Chamber of Commerce, on December 19, 1914. Their organizational dinner was cooked and served by the club members, before the Clubhouse was built. It is significant that with all their city involvement the Club goes out of its way to remain strictly-nonpartisan.

OUT DOOR ART

Conservation (then called outdoor art) was a driving force in the founding of the Club.

On a certain day in 1911, Mrs. R.W. Wood, a Club Founder, affectionately known as "The Captain," heard a saw working, then a tree crash. Mrs. Wood dropped her market basket, and encouraged others to drop garden shears etc., and join her in putting a stop to the desecration taking place on Bulkley Avenue. The town trustees had ordered a line of fine cypress trees cut down; the women arrived in time to save one -- the runt of the line. Until 1987, when the tree died of old age, it stood in front of the Presbyterian Church and was designated "The Founder's Tree of the Sausalito Woman's Club". On March 17, 1988, (the Club's 75th anniversary) a plaque was placed on the site. "The "Founders Tree" is gone but the spirit that saved it from destruction is still alive."

National Register of Historic Places Continuation Sheet

Section number 8 Page 5

The above episode led three women known as the three S's --Mrs. Sperry, Mrs. Story and Mrs. Shoobert-- to enlist seven tried and true friends to underwrite a statement, " We must have a club of CIVIC FORCE to save the beauty of our hillsides." The women of Sausalito have ever since been attuned to the sound of a saw - - especially one ripping through the green wood of a live tree.

The women were instrumental in augmenting a program to protect and maintain unusual and specimen trees on city property. They were so dedicated that they held many garden fetes from 1923 to 1927 to raise the funds to support this project. In 1927 the Outdoor Art Section of the Club started a drive to beautify Sausalito. The Sausalito News dated Dec. 3, 1927 quotes the Chair, Mrs. Wright, " The planting ivy on the exposed and unimproved banks would solve in a simple way these neglected and unattractive spots." The ladies of the Outdoor Art Section stand ready and willing to help in this work for Sausalito's benefit.

Another Outdoor Art effort in 1916 was to see that Sausalito acquired the large outdoor fountain and two elephants designed by William A. Faville for the Pan Pacific Exposition in 1915. These sculptures, brought to Sausalito by boat, became the focal point of the first City Park in Sausalito.

The Club members were so well known for their dedication to conservation that in 1922 the neighboring town of Mill Valley, sought their helping preventing the dumping of garbage in the marshes, and their support in the matter of erecting an incinerator plant. This dedication continued into the 1930's, with an annual letter to the Mayor of Sausalito with propositions to better the town in the areas of dumping garbage, the acquisition of public property for playgrounds, and an adequate water service for fire protection.

In 1941 and 1942 the Clubhouse was used for classes in canteen work, first aid and other emergencies. The women provided coffee, cake and entertainment at the Service Men's Club on two Fridays a month. They created a war sewing room for Red Cross sewing at the Club, and granted the Red Cross the use of the Club as a Casualty Station. Again they were writing letters to the City Council, this time urging them to work on plans for housing needed for shipyard workers.

National Register of Historic Places Continuation Sheet

Section number 8 Page 6

Sausalito Woman's Club Marin County Ca.

MUSIC AND LITERATURE

The Sausalito Players, little theater group, was founded at the Club in Jan. 1923. Today, this ongoing group gives eight play readings a year, free of charge, to the community.

Each year the Club celebrates Founders Day on the third Thursday in March to honor the founders of the Club and all past presidents, and to renew the Club's dedication to the purposes for which it was founded. Currently the roster includes seven women who have been members for over 50 years.

We have ended the period of significance arbitrarily in 1943, based on the National Register's policy of not listing properties for events that have occurred in the last fifty years. However the 284 active Club members continue to promote the purposes of the Club with energy and distinction. Throughout its 80 years the Club has consistently promoted the cultural and social life of the community. Such projects as junior dances for children, high-school graduate scholarships, piano recitals and classes of instruction in various fields continue to enrich the quality of life in Sausalito. Programs are planned for every month from September through June, with a balance of art, music, civic, health, food, gardening and social issues. All activities are open to the public except business meetings where events are planned.

The Julia Morgan designed Clubhouse, well preserved and carefully maintained, is truly the center that Mrs. Robbins desired.

It is possible the property is also significant under Criterion C in the area of architecture as an example of Bay Area Tradition design in the community of Sausalito and as an example of the work of a prominent architect, Julia Morgan, but no justification is being provided at this time for nominating under Criterion C.

9. Major Bibliographical References

Previous documentation on file (NPS):

- preliminary determination of individual listing (36 CFR 67) has been requested
- previously listed in the National Register
- previously determined eligible by the National Register
- designated a National Historic Landmark
- recorded by Historic American Buildings Survey # _____
- recorded by Historic American Engineering Record # _____

See continuation sheet

Primary location of additional data:

- State historic preservation office
- Other State agency
- Federal agency
- Local government
- University
- Other

Specify repository: _____

10. Geographical Data

Acreeage of property Less than one acre

UTM References

A

| | |
|---|---|
| 1 | 0 |
|---|---|

| | | | | | |
|---|---|---|---|---|---|
| 5 | 4 | 5 | 7 | 7 | 0 |
|---|---|---|---|---|---|

| | | | | | | |
|---|---|---|---|---|---|---|
| 4 | 1 | 8 | 9 | 3 | 1 | 0 |
|---|---|---|---|---|---|---|

Zone Easting Northing

B

| | |
|--|--|
| | |
|--|--|

| | | | | | |
|--|--|--|--|--|--|
| | | | | | |
|--|--|--|--|--|--|

| | | | | | | |
|--|--|--|--|--|--|--|
| | | | | | | |
|--|--|--|--|--|--|--|

Zone Easting Northing

C

| | |
|--|--|
| | |
|--|--|

| | | | | | |
|--|--|--|--|--|--|
| | | | | | |
|--|--|--|--|--|--|

| | | | | | | |
|--|--|--|--|--|--|--|
| | | | | | | |
|--|--|--|--|--|--|--|

D

| | |
|--|--|
| | |
|--|--|

| | | | | | |
|--|--|--|--|--|--|
| | | | | | |
|--|--|--|--|--|--|

| | | | | | | |
|--|--|--|--|--|--|--|
| | | | | | | |
|--|--|--|--|--|--|--|

See continuation sheet

Verbal Boundary Description

See continuation sheet

Boundary Justification

The property is the original historic property at 120 Central Avenue, Sausalito, Ca. It was gifted to the Club in 1917.

See continuation sheet

11. Form Prepared By

name/title Shirley Elkington, Chair and Nancy Osborn, Secretary
organization Sausalito Woman's Club Preservation Society date 12-15-92
street & number 153 Toyon Lane telephone 415-332-9379
city or town Sausalito, state CA. zip code 94965

United States Department of the Interior
National Park Service

National Register of Historic Places
Continuation Sheet

APR 20 1995

OHP

Section number 9 Page 1 Sausalito Woman's Club, Marin County, Ca.

Selected Bibliography

Articles and Unpublished Papers

- "Generous Gift of Mr. Robbins to the Sausalito Woman's Club" Sausalito News August 18, 1917
"Contract for Women's Club House Let" Sausalito News April 27, 1918
" Woman's Club House Opening the 21" Sausalito News September 7, 1918
"Woman's Club Business Meeting" Sausalito News April 4, 1923
"House Warming At Woman's Club" Sausalito News October 13, 1923
" Club Women to Fete Fiftieth Year Sunday" Marin News May 22, 1963 Page 1
"Sausalito Woman's Club 50th Anniversary" Marin News-Guide May 22, 1963 Page 2

Newspapers at Sausalito Historical Society, 420 Litho St. Sausalito.

- "Our First Fifty Years" Sausalito Woman's Club Butterfly Bend Press, Sausalito. Second Printing 1976.
Spring Mary, "Sausalito Woman's Club - Founding and Traditions" Presented on Founders Day, March 17, 1976 Unpublished Manuscript.
Koenig Anita, "Remarks at Founders Day" March 1971. Unpublished Manuscript.
Letters to and from the Sausalito Woman's Club, July 1921 through June 1943. Unpublished.
Minutes of Business Meetings from 1913 to 1942, unpublished.
Articles, correspondence and minutes located at Sausalito Woman's Club.

Books

- Boutelle, Sara Holmes. Julia Morgan Architect New York Abbeville Press 1988.
Wilkes, Joseph A. Encyclopedia of Architecture Volume 3 JULIA MORGAN, New York John Wiley and Sons 1989.
Woodbridge, Sally B. California Architecture, Historic American Buildings Survey Chronicle Books, San Francisco 1988.

United States Department of the Interior
National Park Service

National Register of Historic Places Continuation Sheet

Section number _____ Page _____ Sausalito Woman's Club, Marin County, Ca.

Sketch map of building

Scale 1" = 20'

Sausalito Woman's Club

120 Central Avenue

Sausalito, CA. 94965

Marin County

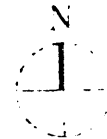
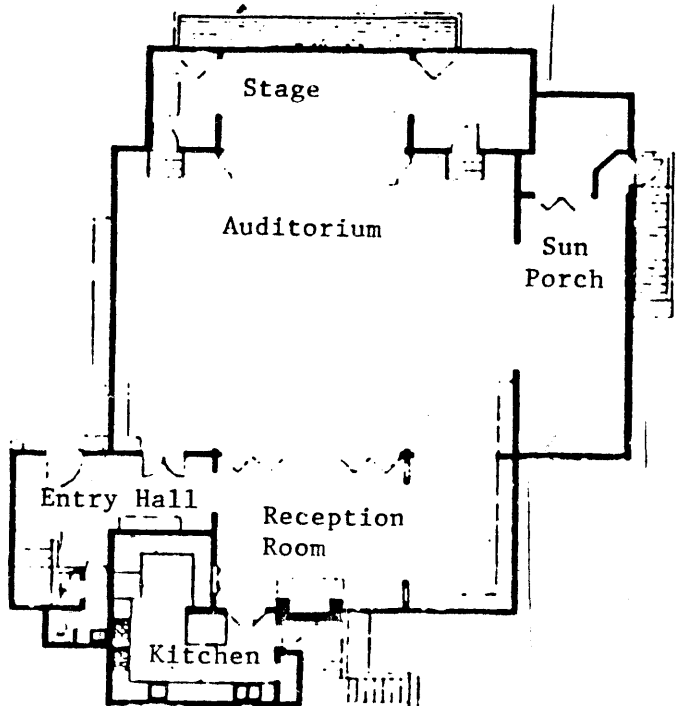

United States Department of the Interior
National Park Service

National Register of Historic Places Continuation Sheet

Section number _____ Page _____

Sausalito Woman's Club, Marin County, CA

Site Map
Sausalito Woman's Club
120 Central Avenue
Sausalito, Ca. 94965
Marin County

Scale 1" = 20'

San Carlos Avenue

