

United States Department of the Interior  
National Park Service

National Register of Historic Places  
Registration Form

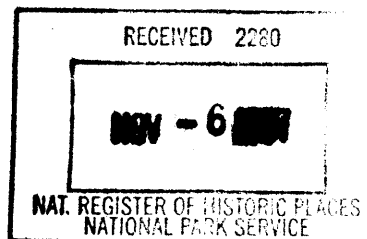

This form is for use in nominating or requesting determinations for individual properties and districts. See instructions in *How to Complete the National Register of Historic Places Registration Form* (National Register Bulletin 16A). Complete each item by marking "x" in the appropriate box or by entering the information requested. If an item does not apply to the property being documented, enter "N/A" for "not applicable." For functions, architectural classification, materials, and areas of significance, enter only categories and subcategories from the instructions. Place additional entries and narrative items on continuation sheets (NPS Form 10-900a). Use a typewriter, word processor, or computer, to complete all items.

1. Name of Property

historic name Taylor House

other names/site number Woodlawn

2. Location

street & number 5000 La. Hwy. 10 N/A ☐ not for publication

city or town Jackson ☒ vicinity

state Louisiana code LA county East Feliciana code 037 zip code 70748

3. State/Federal Agency Certification

As the designated authority under the National Historic Preservation Act, as amended, I hereby certify that this ☒ nomination  
☐ request for determination of eligibility meets the documentation standards for registering properties in the National Register of  
Historic Places and meets the procedural and professional requirements set forth in 36 CFR Part 60. In my opinion, the property  
☒ meets ☐ does not meet the National Register criteria. I recommend that this property be considered significant  
☐ nationally ☐ statewide ☒ locally. (☐ See continuation sheet for additional comments.)

Jonathan Fricker 11/3/97  
Signature of certifying official/Title Date  
Deputy SHPO, Dept. of Culture, Recreation and Tourism  
State of Federal agency and bureau

In my opinion, the property ☐ meets ☐ does not meet the National Register criteria. (☐ See continuation sheet for additional comments.)

\_\_\_\_\_  
Signature of commenting official/Title Date  
\_\_\_\_\_  
State or Federal agency and bureau

4. National Park Service Certification

I hereby certify that the property is:

- ☒ entered in the National Register.  
☐ See continuation sheet.
- ☐ determined eligible for the  
National Register  
☐ See continuation sheet.
- ☐ determined not eligible for the  
National Register.
- ☐ removed from the National  
Register.
- ☐ other, (explain:)

Edson H. Beall  
Signature of the Keeper

Date of Action

12/8/97

Taylor House  
Name of Property

East Feliciana Parish, LA  
County and State

## 5. Classification

### Ownership of Property - Category of Property

(Check as many boxes as apply)

(Check only one box)

- ☐ private  
☐ public-local  
☒ public-State  
☐ public-Federal

- ☒ building(s)  
☐ district  
☐ site  
☐ structure  
☐ object

### Number of Resources within Property

(Do not include previously listed resources in the count.)

Contributing

Noncontributing

3

buildings

sites

structures

objects

3

0

Total

### Name of related multiple property listing

(Enter "N/A" if property is not part of a multiple property listing.)

N/A

### Number of contributing resources previously listed in the National Register

0

## 6. Function or Use

### Historic Functions

(Enter categories from instructions)

Domestic - single dwelling

Domestic - secondary structure

### Current Functions

(Enter categories from instructions)

Vacant / Not in use

## 7. Description

### Architectural Classification

(Enter categories from instructions)

Greek Revival

### Materials

(Enter categories from instructions)

foundation brick

walls weatherboard  
stucco & brick (dependencies)

roof asphalt

other asphalt & slate (dependencies)

### Narrative Description

(Describe the historic and current condition of the property on one or more continuation sheets.)

**United States Department of the Interior  
National Park Service**

**National Register of Historic Places  
Continuation Sheet**

Taylor House, East Feliciana Parish, LA

Section number 7 Page 1

---

The Taylor House (c. 1850) is a large, two-and-one-half story frame plantation house located on the wooded grounds of Villa Feliciana Hospital in rural East Feliciana Parish. The building is commonly known as the Taylor House, but it was originally named Woodlawn by the Taylor family. Although the Greek Revival style dwelling has experienced some alteration since its acquisition by the State of Louisiana, it remains eligible for National Register listing.

The house features a conventional plan, with the first and second floors each containing four rooms (two on each side of a central hall). As originally built, the first floor also had a fifth room which filled an ell separated from the main house by the latter's rear, two-story, shed-roof gallery. This ell room, which appears to have had galleries on at least two sides, served as the dining room. The attic floor is unfinished.

The home's expression of the Greek Revival style is noteworthy because it reflects an approach more commonly found in Virginia and the Carolinas than in Louisiana. Instead of the more usual columned double gallery encompassing the entire facade, the house is distinguished by a two-tier portico the same width as the central hall. This portico features two pairs of solid boxed columns with molded capitals on each level, and the entire composition is surmounted by a large pediment with a raking cornice. Architectural evidence is unclear concerning whether the clapboard siding covering the portico's lower level entablature is original or an alteration. Other Greek Revival characteristics found in the Taylor House include:

- 1) an entablature which distinguishes the second level of the portico and extends to encircle the original portion of the house,
- 2) large gable ends decorated as pediments with raking cornices,
- 3) two entrances (lower front and upper front) featuring massive Greek Revival surrounds composed of pilasters, sidelights, and a thick entablature with a particularly heavy cornice. An identical surround located at the former lower rear entrance has been altered (see below).
- 4) one vernacular Greek Revival mantel.

Other important features found in the home include pocket doors, elaborate interior cornices, molded door and window surrounds, two staircases, and one ceiling medallion whose floral design suggests that it was added during the late nineteenth century.

CONTINUED

**United States Department of the Interior  
National Park Service****National Register of Historic Places  
Continuation Sheet**

Taylor House, East Feliciana Parish, LA

Section number 7 Page 2

---

The first alteration to the house was made by the Taylor family when they enclosed the home's rear gallery. How they used this space is unclear because later changes were made by the state. All of the additional alterations listed below were made by the state in the years since the Taylor plantation was acquired for use as a hospital. These include:

- 1) the construction of an inappropriate two-story brick wing toward the rear of one side of the home, the construction of a second two-story shed-roof space behind the enclosed rear gallery, and the construction of a large ell behind the latter addition. These two rear expansions have almost completely engulfed the original dining ell; now only small portions of its galleries can be seen on two sides. The enclosed rear gallery and newer shed roof addition contain a warren of small rooms with lowered ceilings. The wall of one of these rooms intersects and appears to cut off the elaborate door surround on the former rear elevation. Other original rear openings have been closed, but their locations are still visible. The newer ell contains apartments for hospital staff.
- 2) the removal of the original slate roof, the entire removal of one chimney, the removal of the second chimney above the roofline, and the loss of the shutters,
- 3) the attachment of inappropriate door closure mechanisms to the home's historic exterior doors.
- 4) the removal of much of the interior woodwork when the original house was carved into staff apartments. However, this decoration (including one mantel, baseboards, cornices, and door and window surrounds) does survive in two downstairs rooms.

Although this list of alterations might at first seem excessive, the Taylor House retains enough of its architectural integrity to justify its inclusion in the National Register. The most serious exterior alterations are the construction of the two-story brick wing (which could be removed) and the covering of the original rear ell within its larger replacement. However, the impact of the latter alteration is lessened somewhat by the fact that it occurs on the rear elevation. Although the loss of much of the interior decoration is regrettable, enough remains to convey the interior's Greek Revival personality. Importantly, the exterior retains the vast majority of its original character-defining features, including its double portico, pedimented gables with raking cornices, and encircling entablature. Hence it still conveys its importance as a significant and unusual example of the Greek Revival style.

CONTINUED

**United States Department of the Interior  
National Park Service**

**National Register of Historic Places  
Continuation Sheet**

Taylor House, East Feliciana Parish, LA

Section number 7 Page 3

---

**Contributing Elements**

Two contemporaneous dependencies are near the house in what might be considered its side yard. They are as follows:

- 1) **Kitchen.** This square two-bay brick building with a hip roof is covered by stucco scored to look like large pieces of stone. Its massive chimney is visible on one exterior wall. Changes to the building include the remodeling of the interior to serve as a guest house and the reinforcement of the lower portions of its columns. The latter are now reminiscent of the bungalow style. Evidence is unclear as to whether the building's gallery has been lowered or was always at ground level.
- 2) **Wash House.** This painted brick building with three bays and gable ends contains two rooms. Its columns have experienced alteration similar to those found on the kitchen. In addition, the interior has received beaded board wainscots and two beaded board doors. The building's slate roof is also not original. However, the building retains its original paneled doors and nine-over-nine windows. The original configuration of the building's gallery, like that of the kitchen, is unclear.

Despite the alterations, the staff of the Division of Historic Preservation feels that these historic dependencies easily retain enough integrity to rank as contributing elements to the Taylor House nomination.

Taylor House  
Name of Property

East Feliciana Parish, LA  
County and State

## 8. Statement of Significance

### Applicable National Register Criteria

(Mark "x" in one or more boxes for the criteria qualifying the property for National Register listing.)

- ☐ **A** Property is associated with events that have made a significant contribution to the broad patterns of our history.
- ☐ **B** Property is associated with the lives of persons significant in our past.
- ☒ **C** Property embodies the distinctive characteristics of a type, period, or method of construction or represents the work of a master, or possesses high artistic values, or represents a significant and distinguishable entity whose components lack individual distinction.
- ☐ **D** Property has yielded, or is likely to yield, information important in prehistory or history.

### Criteria Considerations N/A

(Mark "x" in all the boxes that apply.)

Property is:

- ☐ **A** owned by a religious institution or used for religious purposes.
- ☐ **B** removed from its original location.
- ☐ **C** a birthplace or grave.
- ☐ **D** a cemetery.
- ☐ **E** a reconstructed building, object, or structure.
- ☐ **F** a commemorative property.
- ☐ **G** less than 50 years of age or achieved significance within the past 50 years.

### Narrative Statement of Significance

(Explain the significance of the property on one or more continuation sheets.)

## 9. Major Bibliographical References

### Bibliography

(Cite the books, articles, and other sources used in preparing this form on one or more continuation sheets.)

#### Previous documentation on file (NPS): N/A

- ☐ preliminary determination of individual listing (36 CFR 67) has been requested
- ☐ previously listed in the National Register
- ☐ previously determined eligible by the National Register
- ☐ designated a National Historic Landmark
- ☐ recorded by Historic American Buildings Survey  
# \_\_\_\_\_
- ☐ recorded by Historic American Engineering  
Record # \_\_\_\_\_

### Areas of Significance

(Enter categories from instructions)

#### Architecture

### Period of Significance

c. 1850

### Significant Dates

c. 1850

### Significant Person

(Complete if Criterion B is marked above)

N/A

### Cultural Affiliation

N/A

### Architect/Builder

Unknown

#### Primary location of additional data:

- ☒ State Historic Preservation Office
- ☐ Other State agency
- ☐ Federal agency
- ☐ Local government
- ☐ University
- ☐ Other

Name of repository:

Taylor House  
Name of Property

East Feliciana Parish, LA  
County and State

## 10. Geographical Data

Acreage of Property approx. 1 acre

### UTM References

(Place additional UTM references on a continuation sheet.)

1 

1	5
---	---

6	7	6	2	6	0
---	---	---	---	---	---

3	4	1	2	7	6	0
---	---	---	---	---	---	---

  
Zone Easting Northing

3 

--	--

--	--	--	--	--	--

--	--	--	--	--	--

  
Zone Easting Northing

4 

--	--

--	--	--	--	--	--

--	--	--	--	--	--

  
☐ See continuation sheet

### Verbal Boundary Description

(Describe the boundaries of the property on a continuation sheet.)

### Boundary Justification

(Explain why the boundaries were selected on a continuation sheet.)

## 11. Form Prepared By

name/title National Register staff

organization Division of Historic Preservation date August 1997

street & number P. O. Box 44247 telephone (504) 342-8160

city or town Baton Rouge state LA zip code 70804

### Additional Documentation

Submit the following items with the completed form:

### Continuation Sheets

### Maps

A USGS map (7.5 or 15 minute series) indicating the property's location.

A Sketch map for historic districts and properties having large acreage or numerous resources.

### Photographs

Representative black and white photographs of the property.

### Additional items

(Check with the SHPO or FPO for any additional items)

### Property Owner

(Complete this item at the request of SHPO or FPO.)

name State of Louisiana, Department of Health and Hospitals

street & number P. O. Box 629 telephone 504-634-4000

city or town Baton Rouge state LA zip code 70821-0629

**Paperwork Reduction Act Statement:** This information is being collected for applications to the National Register of Historic Places to nominate properties for listing or determine eligibility for listing, to list properties, and to amend existing listings. Response to this request is required to obtain a benefit in accordance with the National Historic Preservation Act, as amended (16 U.S.C. 470 *et seq.*).

**Estimated Burden Statement:** Public reporting burden for this form is estimated to average 18.1 hours per response including time for reviewing instructions, gathering and maintaining data, and completing and reviewing the form. Direct comments regarding this burden estimate or any aspect of this form to the Chief, Administrative Services Division, National Park Service, P.O. Box 37127, Washington, DC 20013-7127; and the Office of Management and Budget, Paperwork Reductions Projects (1024-0018), Washington, DC 20503.

**United States Department of the Interior  
National Park Service**

**National Register of Historic Places  
Continuation Sheet**

Taylor House, East Feliciana Parish, LA

Section number 8 Page 1

---

The Taylor House is locally significant in the area of architecture because it contributes to the distinctly Greek Revival architectural heritage of East Feliciana Parish.

Despite its proximity to the French Creole region of Louisiana, East Feliciana was settled primarily by Anglo-Americans from the eastern United States. These settlers brought with them the architectural styles popular in their former homes. And, during the mid-nineteenth century, this meant the extremely popular Greek Revival style which came to dominate the area. As a result of this settlement pattern and design preference, East Feliciana Parish stands as one of three rural areas considered to be major centers of Greek Revival architecture in the state. The East Feliciana collection consists of approximately two dozen buildings, many of which are two-story homes.

In the opinion of the State Historic Preservation Office, all surviving examples of the Greek Revival style in East Feliciana Parish are significant because they contribute to the area's architectural identity as a center of Greek Revival architecture. Taken among this group, the Taylor House is conspicuous because it is in the tradition of a distinctive Greek Revival prototype found in the East and not often found in Louisiana. Thus, its appearance adds significantly to East Feliciana Parish's Anglo-American architectural identity.

The kitchen and wash house dependencies are significant within East Feliciana Parish because of their age, their styling, and the very fact of their survival. Although dependencies must have once existed in the hundreds, most have been demolished or allowed to deteriorate once they were no longer needed. Because they are contemporaneous with the c. 1850 house, they rank among the older surviving dependencies in the area. Finally, it is very rare today to find dependencies which echo the style of the main house. In fact, the Division of Historic Preservation knows of only one other dependency in the parish which reflects the architecture of the house it once served.

**Historical Note**

According to Taylor family tradition, the house was built by James Warren Taylor for his bride Mary Pipes of Clinton, Louisiana. Cotton and livestock were the plantation's major products. The family owned the house from its construction until 1912, when Taylor heirs sold it and its accompanying one thousand acres of land to the State of Louisiana. The property served as the East Feliciana Hospital for the Insane for many years and is now the Villa Feliciana Chronic Disease Hospital and Rehabilitation Center. The house was once used as offices and staff

CONTINUED



**United States Department of the Interior  
National Park Service**

**National Register of Historic Places  
Continuation Sheet**

Taylor House, East Feliciana Parish, LA

Section number 8 Page 2  
9 1

---

apartments but currently stands vacant. The hospital administrative staff and Taylor family members are currently working to have the house donated to a local historical society for use as a historic house museum.

**BIBLIOGRAPHY**

Historical sketch of the Taylor House furnished by family members; copy in National Register file.

“Oral History of James Warren Taylor plantation home, ‘Woodlawn,’ taken by Mrs. Susan Savoy from Mr. Nauman Taylor, 1969-1970;” copy in National Register file.

Site inspection by National Register staff.

Staff knowledge of the architectural patrimony of East Feliciana Parish.

1912 deed transferring title of Woodlawn Plantation from the Taylor family to the State of Louisiana; copy in National Register file.

**United States Department of the Interior**  
**National Park Service**

## **National Register of Historic Places**

### **Continuation Sheet**

Taylor House, East Feliciana Parish, LA

Section number 10 Page 1

---

Boundary Description: Please refer to enclosed sketch map.

Justification: Boundaries were chosen to take in the house, its two historic dependencies and the immediate setting. As explained in Part 7 the house is on the grounds of a hospital; hence following property lines would have meant taking excessive acreage and non-contributing elements.

TAYLOR HOUSE  
(WOODLAWN)  
JACKSON VICINITY  
EAST FELICINA PARISH, LA

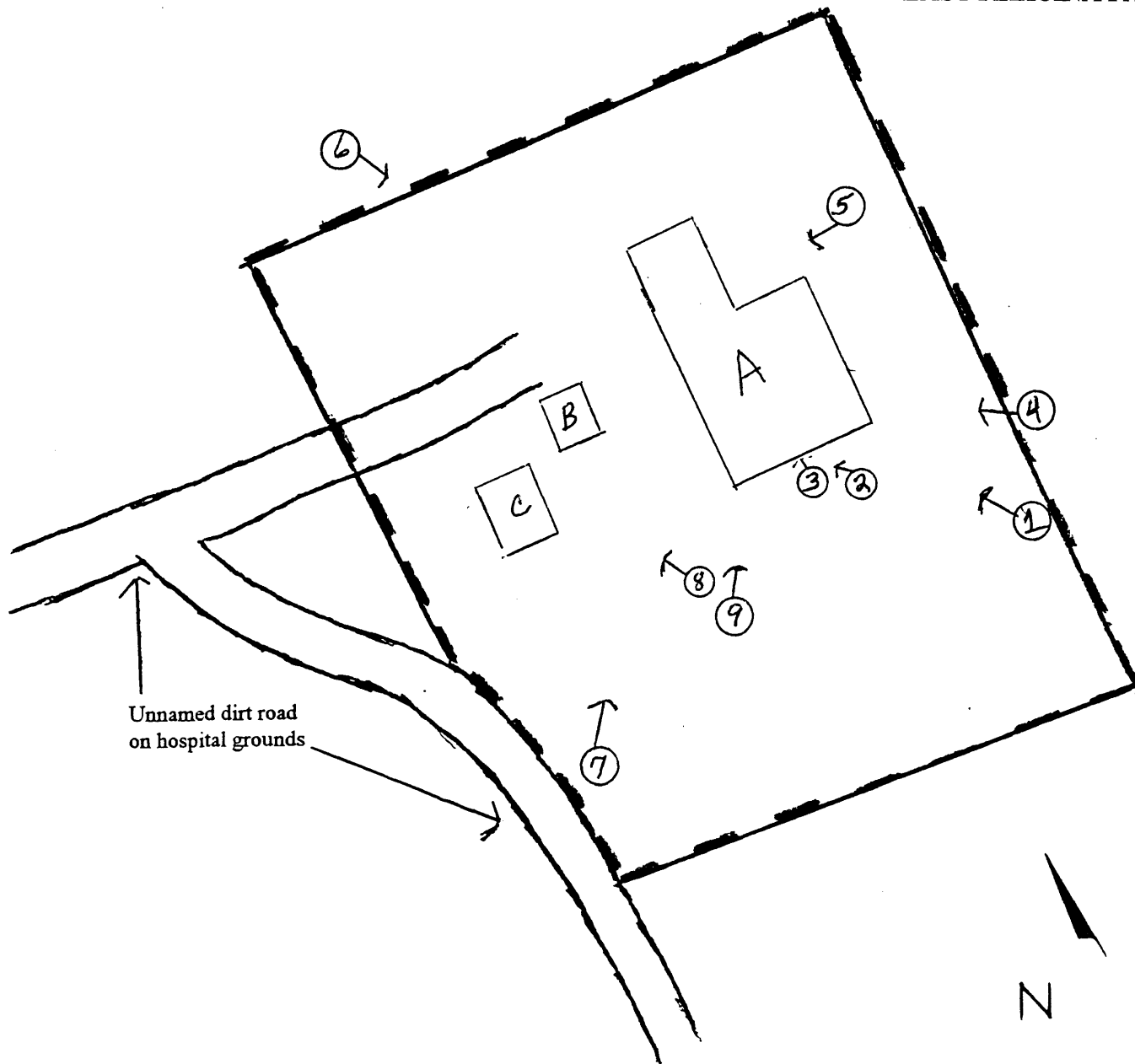

SCALE: 1" = 50'

BOUNDARY: - - - -

BUILDING A = HOUSE  
B = KITCHEN  
C = WASH HOUSE